

DEWALT®

XR®

English (*original instructions*)

6

简体中文

17



Fig. A
图 A

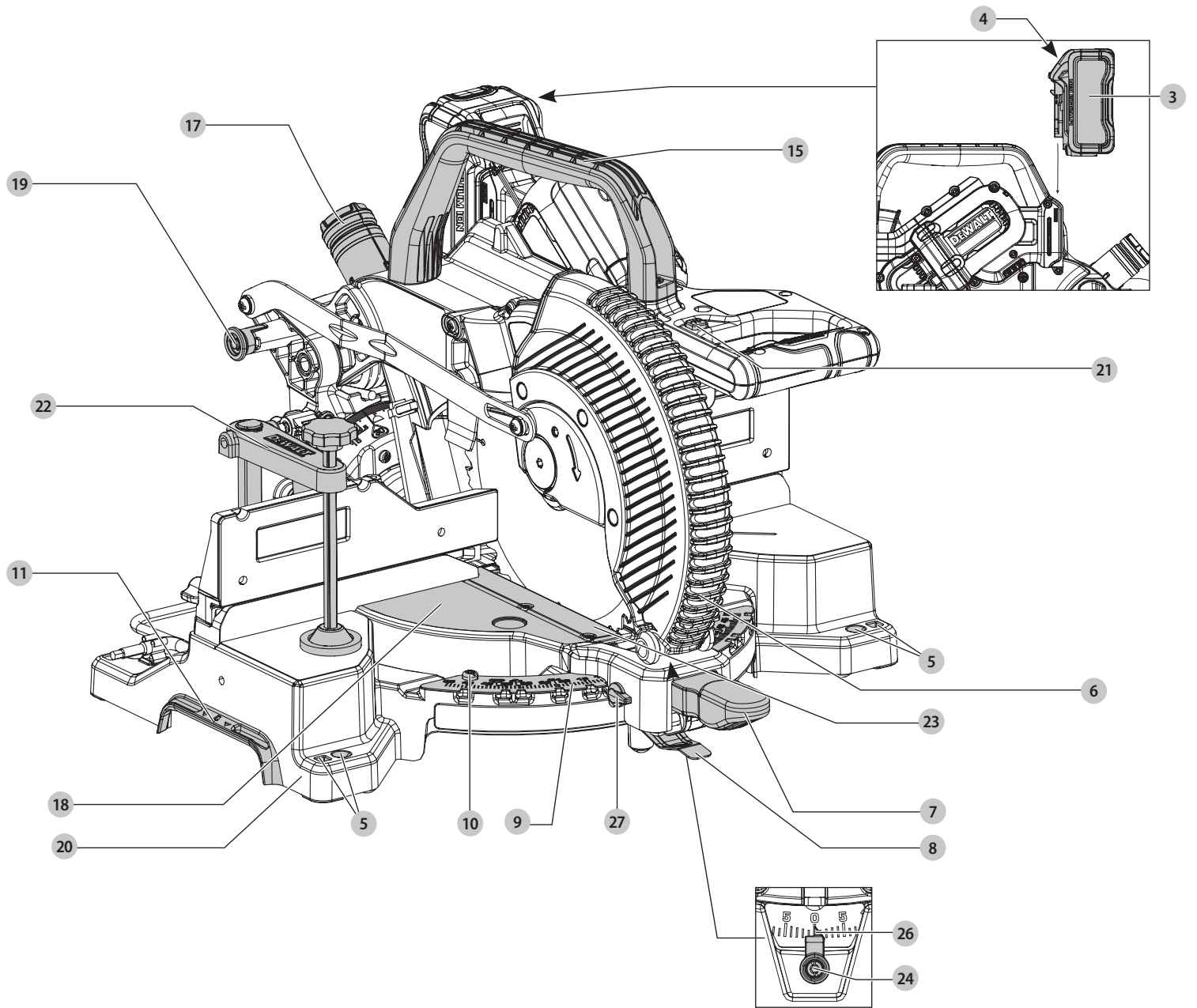
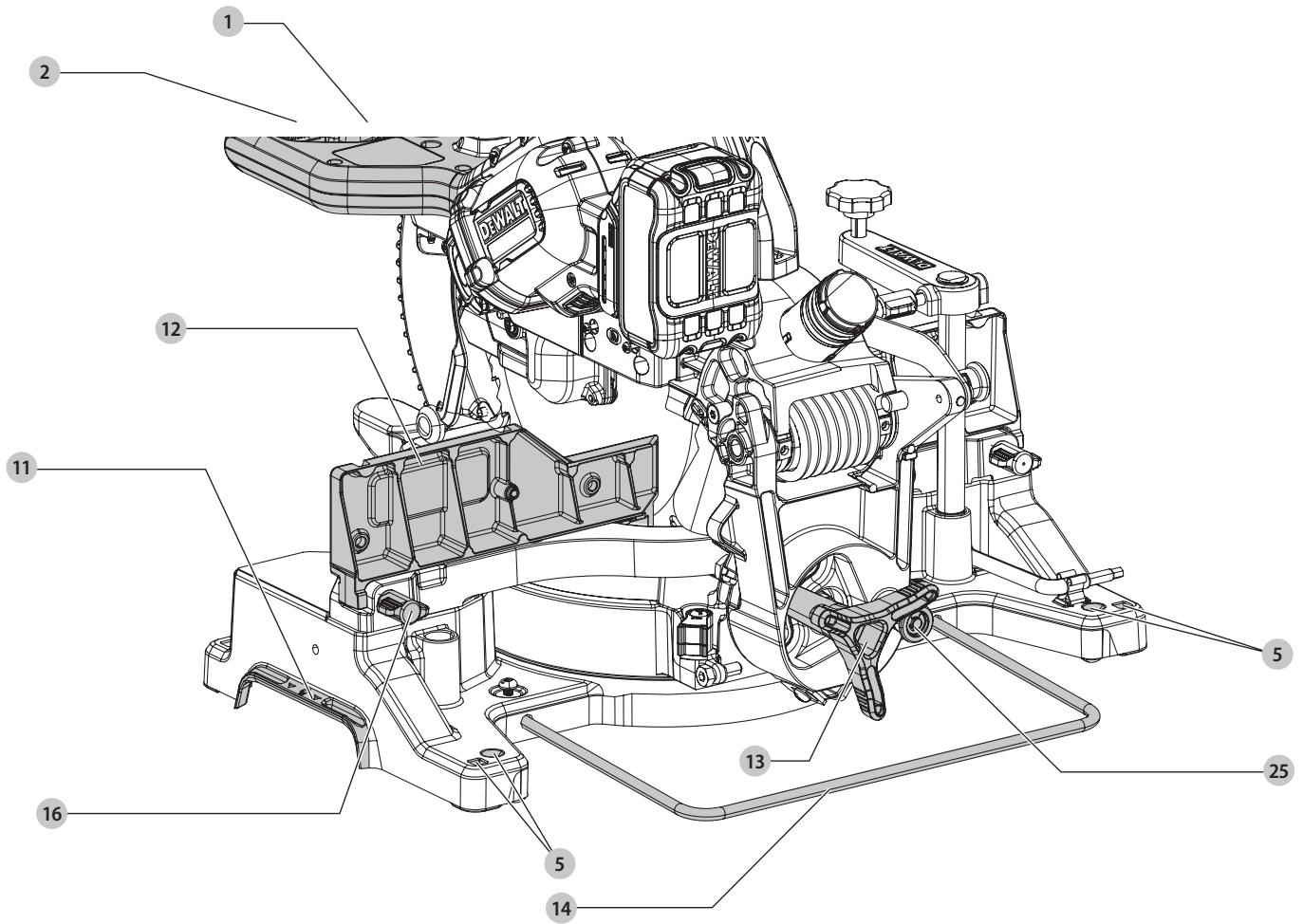

Fig. A
图 A



Components

- 1 Trigger switch
- 2 Operating handle
- 3 Battery
- 4 Battery release button
- 5 Mounting holes
- 6 Lower guard
- 7 Miter lock handle
- 8 Miter detent latch
- 9 Miter scale
- 10 Miter scale screws
- 11 Hand indentations
- 12 Fence
- 13 Bevel lock knob
- 14 Stabilizer bar
- 15 Carrying handle
- 16 Fence adjustment knob
- 17 Dust port
- 18 Table
- 19 Head lock knob
- 20 Base
- 21 CUTLINE™ on switch
- 22 Vertical material clamp
- 23 Kerf plate
- 24 Miter pointer screw
- 25 0° bevel stop
- 26 Miter scale pointer
- 27 Miter detent override switch

组件

- 1 触发开关
- 2 操作手柄
- 3 电池
- 4 电池释放按钮
- 5 安装孔
- 6 下部护罩
- 7 斜切锁定手柄
- 8 斜切定位锁
- 9 斜切刻度尺
- 10 斜切刻度尺螺丝
- 11 搬运凹口
- 12 滑动挡板
- 13 斜切锁定旋钮
- 14 稳定杆
- 15 搬运手柄
- 16 挡板调节旋钮
- 17 除尘口
- 18 工作台
- 19 锯头锁定旋钮
- 20 底座
- 21 CUTLINE™ 开关
- 22 垂直材料夹
- 23 工作台盖板
- 24 斜切指针螺丝
- 25 0°斜角止挡
- 26 斜切刻度尺指针
- 27 斜切定位锁开关

Fig. D
图 D

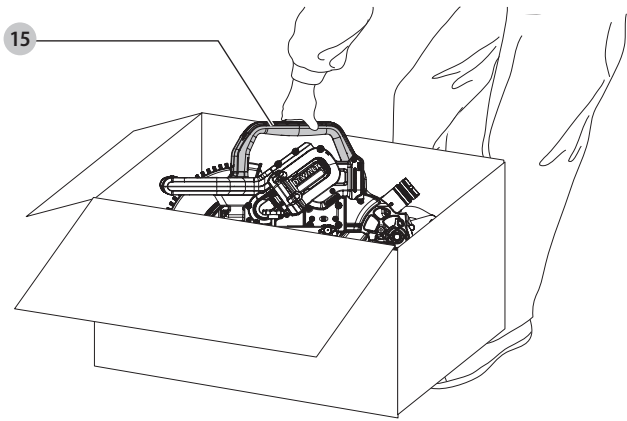

Fig. E
图 E

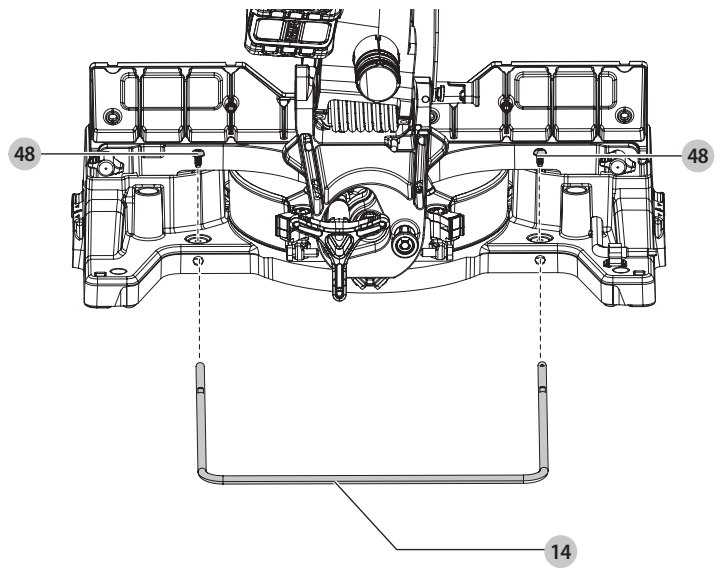

Fig. F
图 F

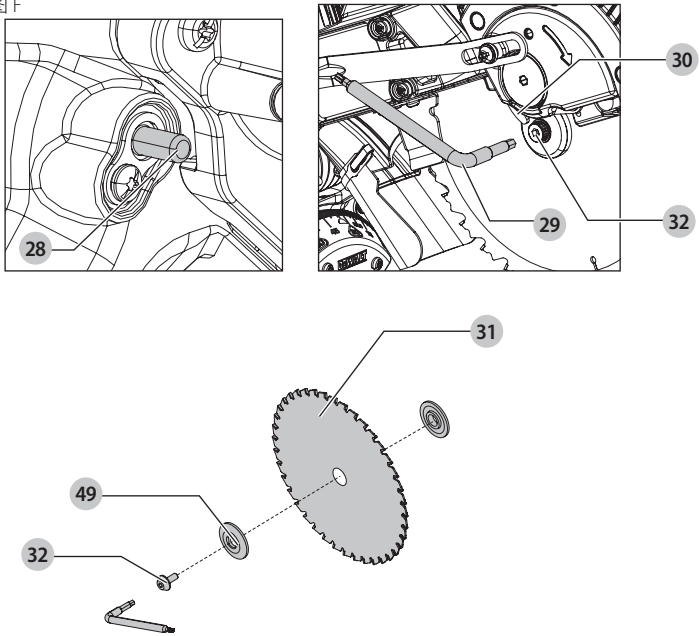

Fig. G
图 G

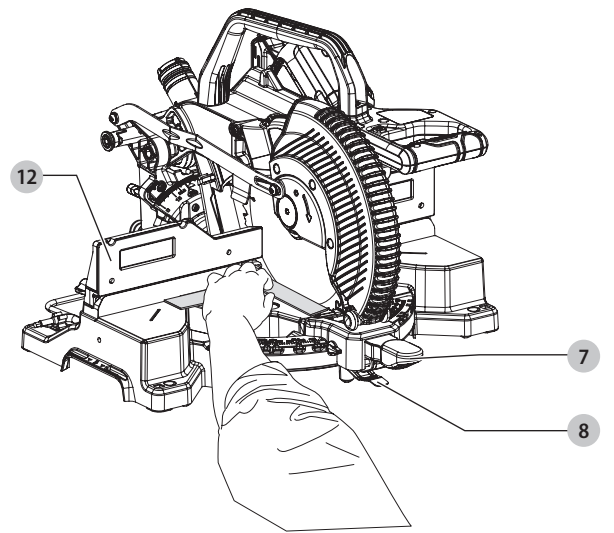

Fig. H
图 H

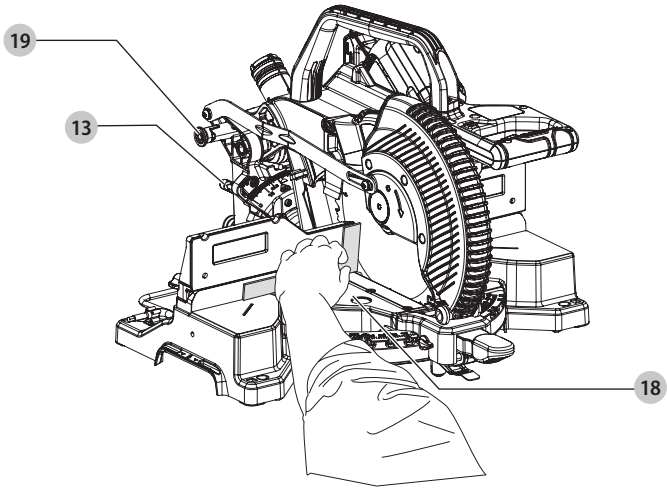

Fig. I
图 I

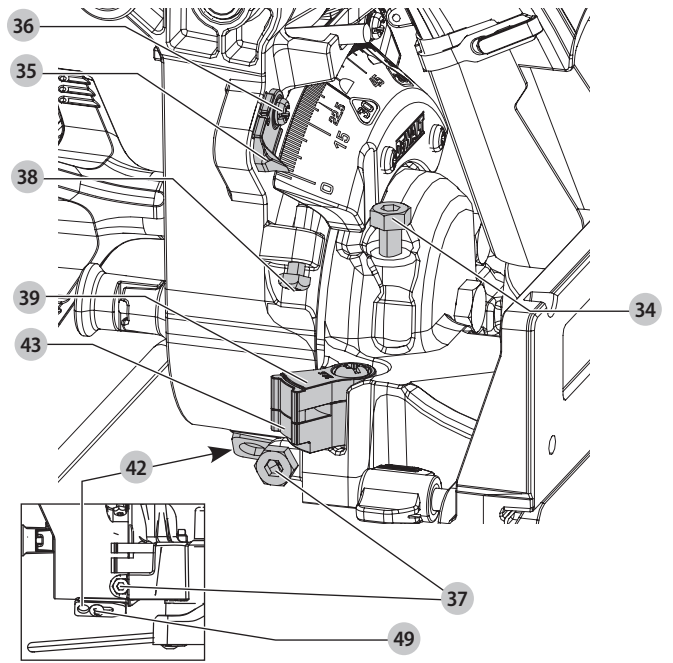

Fig. J
图 J

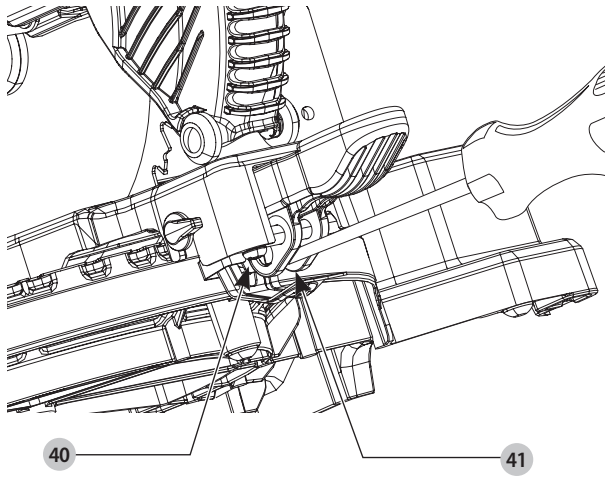

Fig. K
图 K

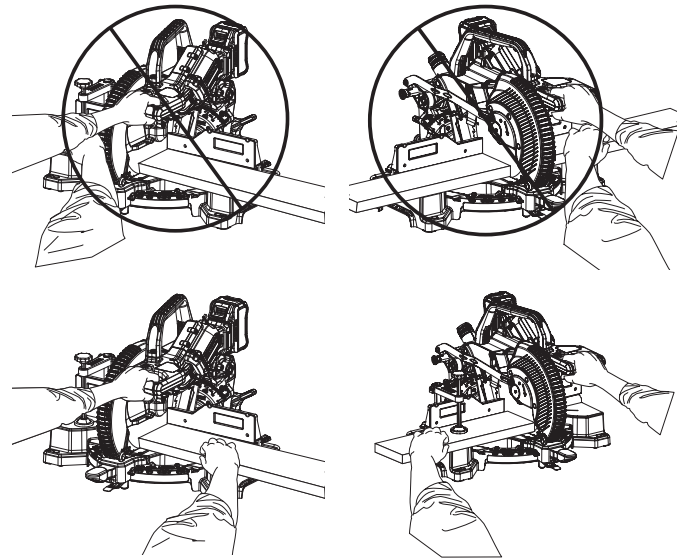

Fig. L
图 L

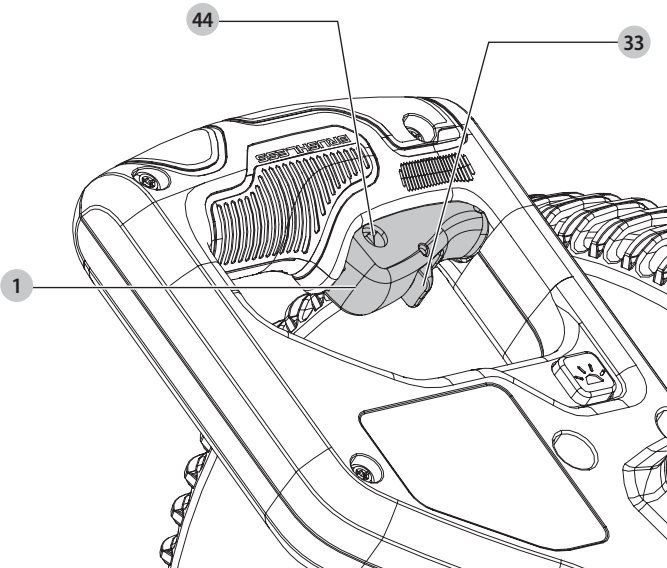

Fig. M
图 M

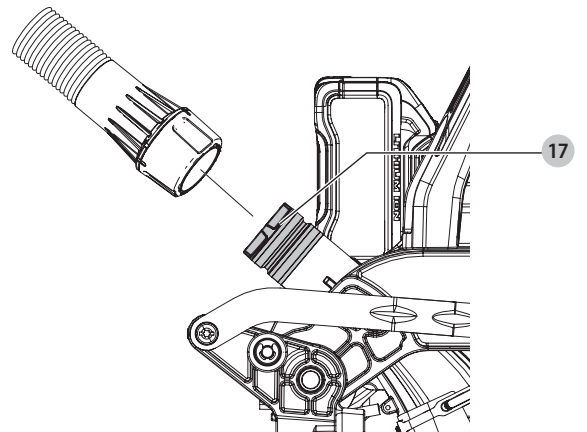

Fig. N
图 N

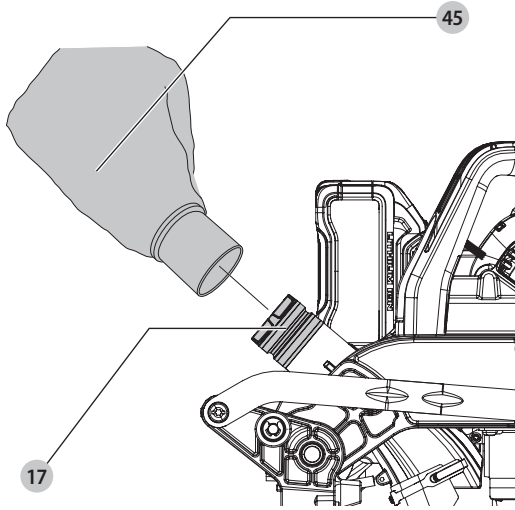

Fig. O
图 O

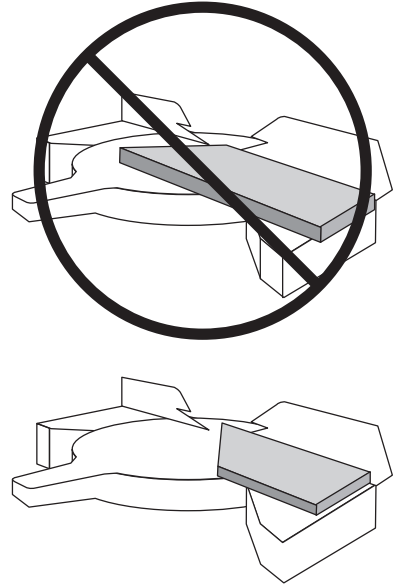

Fig. P
图 P

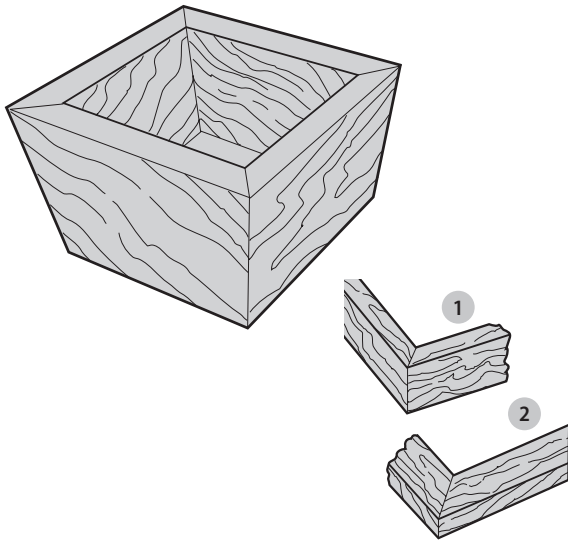

Fig. Q
图 Q

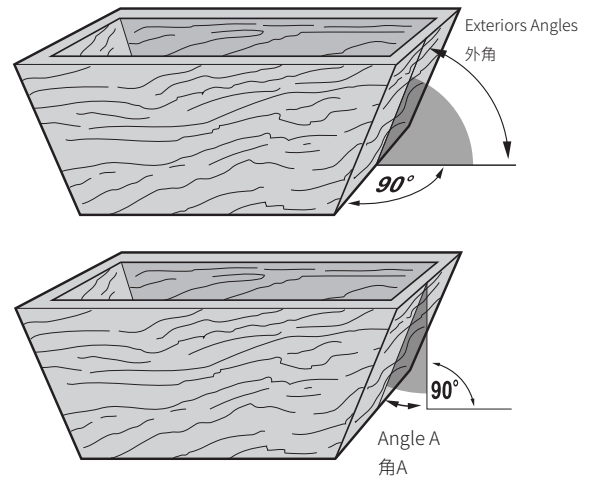

Fig. R
图 R

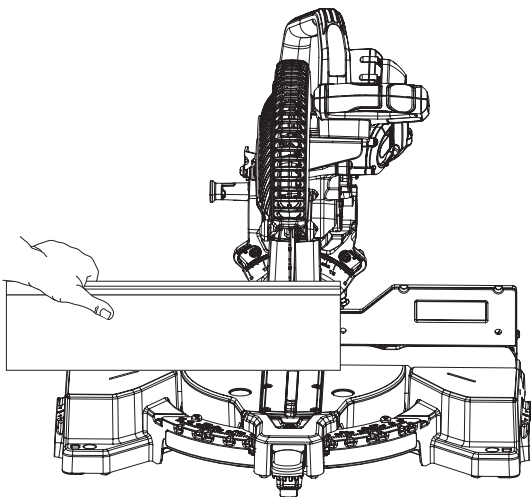

Fig. S
图 S

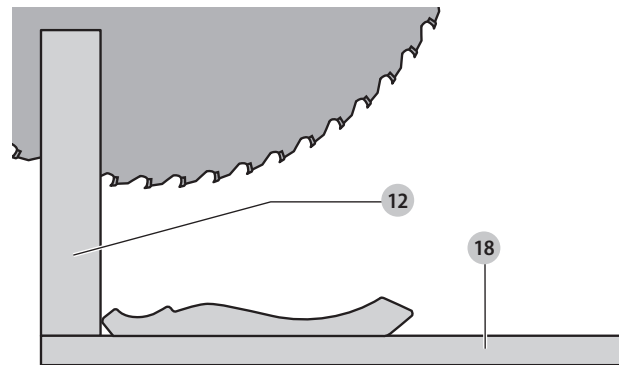

Fig. T
图 T

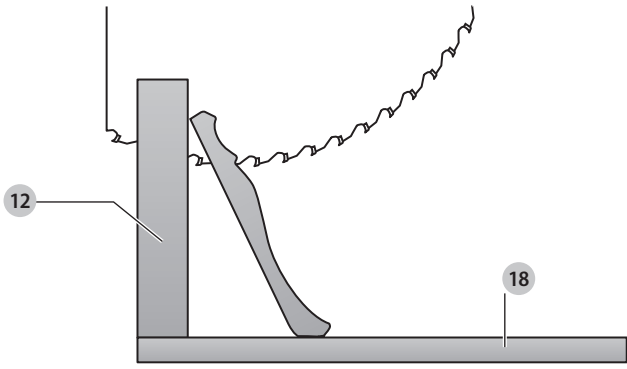

Fig. U
图 U

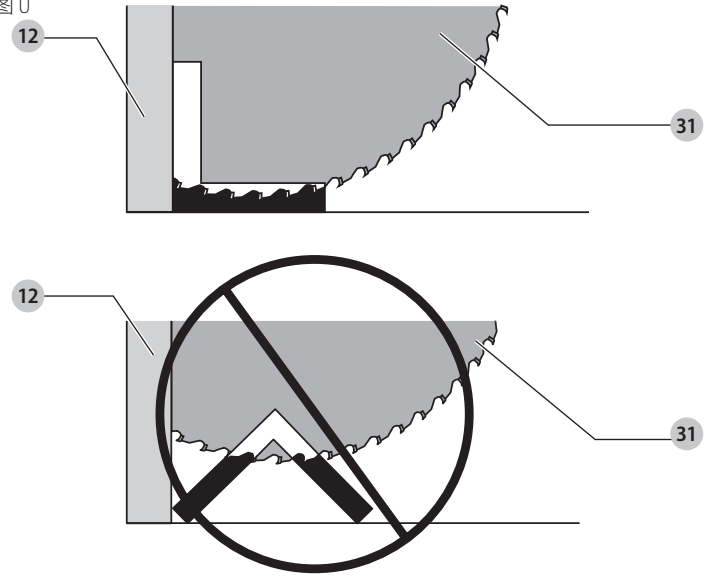

Fig. V
图 V

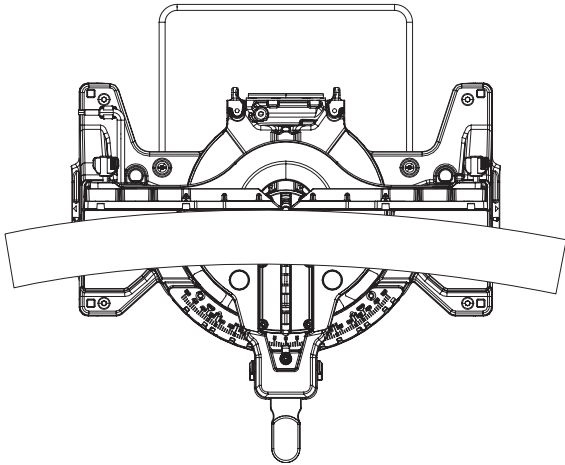

Fig. W
图 W

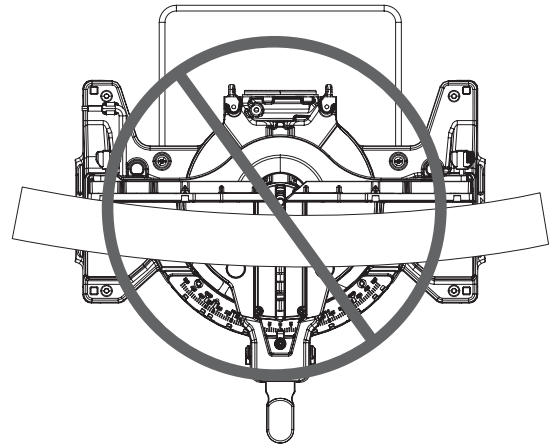
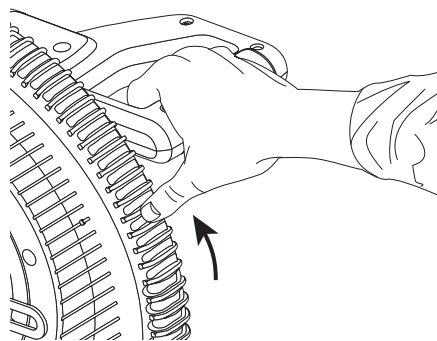

Fig. X
图 X



MITRE SAW

DCS714

Congratulations!

You have chosen a DEWALT tool. Years of experience, thorough product development and innovation make DEWALT one of the most reliable partners for professional power tool users.

Technical Data

		DCS714
Voltage	V _{DC}	18
Battery type		Li-Ion
Blade diameter	mm	254
Blade bore	mm	25.4
Blade body thickness	mm	1.75
Max. kerf thickness	mm	3.2
Max. blade speed	rpm	4900
Max. cross-cut capacity 90°	mm	153
Max. mitre capacity 45°	mm	108
Max. depth of cut 90°	mm	72.5
Max. depth of bevel cross-cut 45°	mm	41.9
Mitre (max. positions)	left	50°
	right	50°
Bevel (max. positions)	left	49°
	right	49°
0° mitre		
Baseboard max. height 133 mm	mm	17
Resulting height at max. width 153 mm	mm	72.5
45° mitre left		
Resulting height at max. width 108 mm	mm	72.5
45° mitre right		
Resulting height at max. width 108 mm	mm	72.5
45° bevel left		
Resulting height at max. width 153 mm	mm	41.9
45° bevel right		
Resulting height at max. width 153 mm	mm	25.6
Automatic blade brake time	s	< 5
Weight (without battery pack)	kg	15.4



WARNING: Read all safety warnings and all instructions. Failure to follow the warnings and instructions may result in electric shock, fire and/or serious injury.



WARNING: To reduce the risk of injury, read the instruction manual.

Intended Use

This heavy duty miter saw is designed for professional wood cutting applications.

This miter saw is a professional power tool.

DO NOT use under wet conditions or in presence of flammable liquids or gases.

DO NOT let children come into contact with the tool. Supervision is required when inexperienced operators use this tool.

Definitions: Safety Alert Symbols and Words

This instruction manual uses the following safety alert symbols and words to alert you to hazardous situations and your risk of personal injury or property damage.



DANGER: Indicates an imminently hazardous situation which, if not avoided, **will** result in **death or serious injury**.



WARNING: Indicates a potentially hazardous situation which, if not avoided, **could** result in **death or serious injury**.



CAUTION: Indicates a potentially hazardous situation which, if not avoided, **may** result in **minor or moderate injury**.



(Used without word) Indicates a safety related message.

NOTICE: Indicates a practice **not related to personal injury** which, if not avoided, **may** result in **property damage**.

GENERAL POWER TOOL SAFETY WARNINGS



WARNING: Read all safety warnings, instructions, illustrations and specifications provided with this power tool. Failure to follow all instructions listed below may result in electric shock, fire and/or serious injury.

SAVE ALL WARNINGS AND INSTRUCTIONS FOR FUTURE REFERENCE.

The term "power tool" in the warnings refers to your mains-operated (corded) power tool or battery-operated (cordless) power tool.

1) Work Area Safety

- Keep work area clean and well lit.** Cluttered or dark areas invite accidents.
- Do not operate power tools in explosive atmospheres, such as in the presence of flammable liquids, gases or dust.** Power tools create sparks which may ignite the dust or fumes.
- Keep children and bystanders away while operating a power tool.** Distractions can cause you to lose control.

2) Electrical Safety

- Power tool plugs must match the outlet. Never modify the plug in any way. Do not use any adapter plugs with earthed (grounded) power tools.** Unmodified plugs and matching outlets will reduce risk of electric shock.
- Avoid body contact with earthed or grounded surfaces, such as pipes, radiators, ranges and refrigerators.** There is an increased risk of electric shock if your body is earthed or grounded.
- Do not expose power tools to rain or wet conditions.** Water entering a power tool will increase the risk of electric shock.
- Do not abuse the cord. Never use the cord for carrying, pulling or unplugging the power tool. Keep cord away from heat, oil, sharp edges or moving parts.** Damaged or entangled cords increase the risk of electric shock.
- When operating a power tool outdoors, use an extension cord suitable for outdoor use.** Use of a cord suitable for outdoor use reduces the risk of electric shock.
- If operating a power tool in a damp location is unavoidable, use a ground fault circuit interrupter (GFCI) protected supply.** Use of a GFCI reduces the risk of electric shock.

3) Personal Safety

- Stay alert, watch what you are doing and use common sense when operating a power tool. Do not use a power tool while you are tired or under the influence of drugs, alcohol or medication.** A moment of inattention while operating power tools may result in serious personal injury.
- Use personal protective equipment. Always wear eye protection.** Protective equipment such as a dust mask, non-skid safety shoes, hard hat, or hearing protection used for appropriate conditions will reduce personal injuries.
- Prevent unintentional starting. Ensure the switch is in the off-position before connecting to power source and/or battery pack, picking up or carrying the tool.** Carrying power tools with your finger on the switch or energizing power tools that have the switch on invites accidents.

- d) **Remove any adjusting key or wrench before turning the power tool on.** A wrench or a key left attached to a rotating part of the power tool may result in personal injury.
- e) **Do not overreach. Keep proper footing and balance at all times.** This enables better control of the power tool in unexpected situations.
- f) **Dress properly. Do not wear loose clothing or jewelry. Keep your hair, clothing and gloves away from moving parts.** Loose clothes, jewelry or long hair can be caught in moving parts.
- g) **If devices are provided for the connection of dust extraction and collection facilities, ensure these are connected and properly used.** Use of dust collection can reduce dust-related hazards.
- h) **Do not let familiarity gained from frequent use of tools allow you to become complacent and ignore tool safety principles.** A careless action can cause severe injury within a fraction of a second.

4) Power Tool Use and Care

- a) **Do not force the power tool. Use the correct power tool for your application.** The correct power tool will do the job better and safer at the rate for which it was designed.
- b) **Do not use the power tool if the switch does not turn it on and off.** Any power tool that cannot be controlled with the switch is dangerous and must be repaired.
- c) **Disconnect the plug from the power source and/or remove the battery pack, if detachable, from the power tool before making any adjustments, changing accessories, or storing power tools.** Such preventive safety measures reduce the risk of starting the power tool accidentally.
- d) **Store idle power tools out of the reach of children and do not allow persons unfamiliar with the power tool or these instructions to operate the power tool.** Power tools are dangerous in the hands of untrained users.
- e) **Maintain power tools and accessories. Check for misalignment or binding of moving parts, breakage of parts and any other condition that may affect the power tool's operation. If damaged, have the power tool repaired before use.** Many accidents are caused by poorly maintained power tools.
- f) **Keep cutting tools sharp and clean.** Properly maintained cutting tools with sharp cutting edges are less likely to bind and are easier to control.
- g) **Use the power tool, accessories and tool bits etc. in accordance with these instructions, taking into account the working conditions and the work to be performed.** Use of the power tool for operations different from those intended could result in a hazardous situation.
- h) **Keep handles and grasping surfaces dry, clean and free from oil and grease.** Slippery handles and grasping surfaces do not allow for safe handling and control of the tool in unexpected situations.

5) Battery Tool Use and Care

- a) **Recharge only with the charger specified by the manufacturer.** A charger that is suitable for one type of battery pack may create a risk of fire when used with another battery pack.
- b) **Use power tools only with specifically designated battery packs.** Use of any other battery packs may create a risk of injury and fire.
- c) **When battery pack is not in use, keep it away from other metal objects, like paper clips, coins, keys, nails, screws or other small metal objects, that can make a connection from one terminal to another.** Shorting the battery terminals together may cause burns or a fire.
- d) **Under abusive conditions, liquid may be ejected from the battery; avoid contact. If contact accidentally occurs, flush with water. If liquid contacts eyes, additionally seek medical help.** Liquid ejected from the battery may cause irritation or burns.
- e) **Do not use a battery pack or tool that is damaged or modified.** Damaged or modified batteries may exhibit unpredictable behavior resulting in fire, explosion or risk of injury.
- f) **Do not expose a battery pack or tool to fire or excessive temperature.** Exposure to fire or temperature above 265 °F (130 °C) may cause explosion.
- g) **Follow all charging instructions and do not charge the battery pack or tool outside the temperature range specified in the instructions.** Charging improperly or at temperatures outside the specified range may damage the battery and increase the risk of fire.

6) Service

- a) **Have your power tool serviced by a qualified repair person using only identical replacement parts.** This will ensure that the safety of the power tool is maintained.
- b) **Never service damaged battery packs.** Service of battery packs should only be performed by the manufacturer or authorized service providers.

Safety Instructions for Miter Saws

- a) **Miter saws are intended to cut wood or wood-like products, they cannot be used with abrasive cut-off wheels for cutting ferrous material such as bars, rods, studs, etc.** Abrasive dust causes moving parts such as the lower guard to jam. Sparks from abrasive cutting will burn the lower guard, the kerf insert and other plastic parts.
- b) **Use clamps to support the workpiece whenever possible. If supporting the workpiece by hand, you must always keep your hand at least 100 mm from either side of the saw blade. Do not use this saw to cut pieces that are too small to be securely clamped or held by hand.** If your hand is placed too close to the saw blade, there is an increased risk of injury from blade contact.
- c) **The workpiece must be stationary and clamped or held against both the fence and the table. Do not feed the workpiece into the blade or cut "freehand" in any way.** Unrestrained or moving workpieces could be thrown at high speeds, causing injury.

- d) **Push the saw through the workpiece. Do not pull the saw through the workpiece. To make a cut, raise the saw head and pull it out over the workpiece without cutting, start the motor, press the saw head down and push the saw through the workpiece.** Cutting on the pull stroke is likely to cause the saw blade to climb on top of the workpiece and violently throw the blade assembly towards the operator.
- e) **Never cross your hand over the intended line of cutting either in front or behind the saw blade.** Supporting the workpiece "cross handed" i.e. holding the workpiece to the right of the saw blade with your left hand or vice versa is very dangerous.
- f) **Do not reach behind the fence with either hand closer than 100 mm from either side of the saw blade, to remove wood scraps, or for any other reason while the blade is spinning.** The proximity of the spinning saw blade to your hand may not be obvious and you may be seriously injured.
- g) **Inspect your workpiece before cutting. If the workpiece is bowed or warped, clamp it with the outside bowed face toward the fence. Always make certain that there is no gap between the workpiece, fence and table along the line of the cut.** Bent or warped workpieces can twist or shift and may cause binding on the spinning saw blade while cutting. There should be no nails or foreign objects in the workpiece.
- h) **Do not use the saw until the table is clear of all tools, wood scraps, etc., except for the workpiece.** Small debris or loose pieces of wood or other objects that contact the revolving blade can be thrown with high speed.
- i) **Cut only one workpiece at a time.** Stacked multiple workpieces cannot be adequately clamped or braced and may bind on the blade or shift during cutting.
- j) **Ensure the miter saw is mounted or placed on a level, firm work surface before use.** A level and firm work surface reduces the risk of the miter saw becoming unstable.
- k) **Plan your work. Every time you change the bevel or miter angle setting, make sure the fence will not interfere with the blade or the guarding system.** Without turning the tool "ON" and with no workpiece on the table, move the saw blade through a complete simulated cut to assure there will be no interference or danger of cutting the fence.
- l) **Provide adequate support such as table extensions, saw horses, etc. for a workpiece that is wider or longer than the table top.** Workpieces longer or wider than the miter saw table can tip if not securely supported. If the cut-off piece or workpiece tips, it can lift the lower guard or be thrown by the spinning blade.
- m) **Do not use another person as a substitute for a table extension or as additional support.** Unstable support for the workpiece can cause the blade to bind or the workpiece to shift during the cutting operation pulling you and the helper into the spinning blade.
- n) **The cut-off piece must not be jammed or pressed by any means against the spinning saw blade.** If confined, i.e. using length stops, the cut-off piece could get wedged against the blade and thrown violently.
- o) **Always use a clamp or a fixture designed to properly support round material such as rods or tubing.** Rods have a tendency to roll while being cut, causing the blade to "bite" and pull the work with your hand into the blade.
- p) **Let the blade reach full speed before contacting the workpiece.** This will reduce the risk of the workpiece being thrown.
- q) **If the workpiece or blade becomes jammed, turn the miter saw off. Wait for all moving parts to stop and disconnect the plug from the power source and/or remove the battery pack. Then work to free the jammed material.** Continued sawing with a jammed workpiece could cause loss of control or damage to the miter saw.
- r) **After finishing the cut, release the switch, hold the saw head down and wait for the blade to stop before removing the cut-off piece.** Reaching with your hand near the coasting blade is dangerous.
- s) **Hold the handle firmly when making an incomplete cut or when releasing the switch before the saw head is completely in the down position.** The braking action of the saw may cause the saw head to be suddenly pulled downward, causing a risk of injury.

Additional Safety Rules for Miter Saws



WARNING: Do not allow familiarity (gained from frequent use of your saw) to replace safety rules. Always remember that a careless fraction of a second is sufficient to inflict severe injury.



WARNING: Never modify the power tool or any part of it. Damage or personal injury could result.

- **DO NOT OPERATE THIS MACHINE** until it is completely assembled and installed according to the instructions. A machine incorrectly assembled can cause serious injury.
- **OBTAIN ADVICE** from your supervisor, instructor, or another qualified person if you are not thoroughly familiar with the operation of this machine. Knowledge is safety..
- **MAKE CERTAIN** the blade rotates in the correct direction. The teeth on the blade should point in the direction of rotation as marked on the saw.
- **TIGHTEN ALL CLAMP HANDLES,** knobs and levers prior to operation. Loose clamps can cause parts or the workpiece to be thrown at high speeds.
- **BE SURE** all blade and blade clamps are clean, recessed sides of blade clamps are against blade and arbor screw is tightened securely. Loose or improper blade clamping may result in damage to the saw and possible personal injury.
- **DO NOT OPERATE ON ANYTHING OTHER THAN THE DESIGNATED VOLTAGE** for the saw. Overheating, damage to the tool and personal injury may occur.
- **DO NOT WEDGE ANYTHING AGAINST THE FAN** to hold the motor shaft. Damage to tool and possible personal injury may occur.
- **NEVER CUT FERROUS METALS** or masonry. Either of these can cause the carbide tips to fly off the blade at high speeds causing serious injury.

- **NEVER PLACE HANDS CLOSER THAN 4" (100 mm) FROM THE BLADE.**
- **NEVER HAVE ANY PART OF YOUR BODY IN LINE WITH THE PATH OF THE SAW BLADE.** Personal injury will occur.
- **NEVER APPLY BLADE LUBRICANT TO A RUNNING BLADE.** Applying lubricant could cause your hand to move into the blade resulting in serious injury.
- **DO NOT** place either hand in the blade area when the saw is connected to the power source. Inadvertent blade activation may result in serious injury.
- **NEVER REACH AROUND OR BEHIND THE SAW BLADE.** A blade can cause serious injury.
- **DO NOT REACH UNDERNEATH THE SAW** unless it is unplugged and turned off. Contact with saw blade may cause personal injury.
- **SECURE THE MACHINE TO A STABLE SUPPORTING SURFACE.** Vibration can possibly cause the machine to slide, walk, or tip over, causing serious injury.
- **USE ONLY CROSSCUT SAW BLADES** recommended for miter saws. For best results, do not use carbide tipped blades with hook angles in excess of 7 degrees. Do not use blades with deep gullets. These can deflect and contact the guard, and can cause damage to the machine and/or serious injury.
- **USE ONLY BLADES OF THE CORRECT SIZE AND TYPE** specified for this tool to prevent damage to the machine and/or serious injury.
- **INSPECT BLADE FOR CRACKS** or other damage prior to operation. A cracked or damaged blade can come apart and pieces can be thrown at high speeds, causing serious injury. Replace cracked or damaged blades immediately.
- **CLEAN THE BLADE AND BLADE CLAMPS** prior to operation. Cleaning the blade and blade clamps allows you to check for any damage to the blade or blade clamps. A cracked or damaged blade or blade clamp can come apart and pieces can be thrown at high speeds, causing serious injury.
- **DO NOT USE WARPED BLADES.** Check to see if the blade runs true and is free from vibration. A vibrating blade can cause damage to the machine and/or serious injury.
- **DO NOT** use lubricants or cleaners (particularly spray or aerosol) in the vicinity of the plastic guard. The polycarbonate material used in the guard is subject to attack by certain chemicals.
- **KEEP GUARD IN PLACE** and in working order.
- **ALWAYS USE THE KERF PLATE AND REPLACE THIS PLATE WHEN DAMAGED.** Small chip accumulation under the saw may interfere with the saw blade or may cause instability of workpiece when cutting.
- **USE ONLY BLADE CLAMPS SPECIFIED FOR THIS TOOL** to prevent damage to the machine and/or serious injury.
- **CLEAN THE MOTOR AIR SLOTS** of chips and sawdust. Clogged motor air slots can cause the machine to overheat, damaging the machine and possibly causing a short which could cause serious injury.
- **NEVER LOCK THE SWITCH IN THE "ON" POSITION.** Severe personal injury may result.
- **NEVER STAND ON TOOL.** Serious injury could occur if the tool is tipped or if the cutting tool is unintentionally contacted.
- **NEVER LEAVE TOOL RUNNING UNATTENDED. TURN POWER OFF.** Don't leave tool until it comes to a complete stop.
- **DO NOT USE ABRASIVE WHEELS OR BLADES.** The excessive heat and abrasive particles generated by them may damage the saw and cause personal injury.

WARNING: Cutting plastics, sap coated wood, and other materials may cause melted material to accumulate on the blade tips and the body of the saw blade, increasing the risk of blade overheating and binding while cutting.

WARNING: ALWAYS use safety glasses. Everyday eyeglasses are NOT safety glasses. Also use face or dust mask if cutting operation is dusty. ALWAYS WEAR CERTIFIED SAFETY EQUIPMENT:

- ANSI Z87.1 eye protection (CAN/CSA Z94.3),
- ANSI S12.6 (S3.19) hearing protection,
- NIOSH/OSHA/MSHA respiratory protection.

WARNING: Some dust created by power sanding, sawing, grinding, drilling, and other construction activities contains chemicals known to the State of California to cause cancer, birth defects or other reproductive harm. Some examples of these chemicals are:

- lead from lead-based paints,
- crystalline silica from bricks and cement and other masonry products, and
- arsenic and chromium from chemically-treated lumber.

Your risk from these exposures varies, depending on how often you do this type of work. To reduce your exposure to these chemicals: work in a well ventilated area, and work with approved safety equipment, such as those dust masks that are specially designed to filter out microscopic particles.

- **Avoid prolonged contact with dust from power sanding, sawing, grinding, drilling, and other construction activities. Wear protective clothing and wash exposed areas with soap and water.** Allowing dust to get into your mouth, eyes, or lay on the skin may promote absorption of harmful chemicals.

WARNING: Use of this tool can generate and/or disperse dust, which may cause serious and permanent respiratory or other injury. Always use NIOSH/OSHA approved respiratory protection appropriate for the dust exposure. Direct particles away from face and body.

WARNING: Always wear proper personal hearing protection that conforms to ANSI S12.6 (S3.19) during use. Under some conditions and duration of use, noise from this product may contribute to hearing loss.

- **Air vents often cover moving parts and should be avoided.** Loose clothes, jewelry or long hair can be caught in moving parts.

The label on your tool may include the following symbols. The symbols and their definitions are as follows:

- V.....volts
- min.....minutes
- Hz.....hertz
- == or DC.....direct current

- Ⓜ.....Class I Construction (grounded)
- .../min.....per minute
- BPM.....beats per minute
- IPM.....impacts per minute
- OPM.....oscillations per minute
- RPM.....revolutions per minute
- sfpm.....surface feet per minute
- SPM.....strokes per minute
- A.....amperes
- W.....watts
- Wh.....watt hours
- Ah.....amp hours
- ~ or AC.....alternating current

- ⏚ or AC/DC.....alternating or direct current
- Ⓜ.....Class II Construction (double insulated)
- n₀.....no load speed
- n.....rated speed
- PSI.....pounds per square inch
- ⏚.....earthing terminal
- ⚠.....safety alert symbol
- ☠.....visible radiation do not stare into the light
- ☑.....wear respiratory protection
- 👁.....wear eye protection
- 👂.....wear hearing protection
- 📖.....read all documentation
- ☔.....do not expose to rain

For your convenience and safety, the following warning labels are on your miter saw.

ON THE OPERATING HANDLE:

TO REDUCE THE RISK OF INJURY, USER MUST READ INSTRUCTION MANUAL. WEAR EYE PROTECTION AND RESPIRATORY PROTECTION. USE ONLY IDENTICAL REPLACEMENT PARTS. DO NOT EXPOSE TO RAIN OR USE IN DAMP LOCATIONS.

ON FENCE:

ALWAYS ADJUST FENCE PROPERLY BEFORE USE. CLAMP SMALL PIECES BEFORE CUTTING. SEE MANUAL.

ON GUARD:

DANGER—KEEP AWAY FROM BLADE.

ON TABLE: (2 PLACES)

WARNING: KEEP HANDS AND BODY OUT OF THE PATH OF THE SAW BLADE. CONTACT WITH BLADE WILL RESULT IN SERIOUS INJURY. DO NOT OPERATE SAW WITHOUT GUARDS IN PLACE. CHECK GUARDING SYSTEM TO MAKE SURE IT IS FUNCTIONING CORRECTLY. DO NOT PERFORM ANY OPERATION FREEHAND. NEVER REACH IN BACK OF SAW BLADE TURN OFF TOOL AND WAIT FOR SAW BLADE TO STOP BEFORE MOVING WORKPIECE OR CHANGING SETTINGS OR MOVING HANDS. NEVER CROSS ARMS IN FRONT OF BLADE. ALWAYS TIGHTEN ADJUSTMENT KNOBS BEFORE EACH USE. DISCONNECT POWER BEFORE CHANGING BLADE OR SERVICING.

ON TABLE: (2 PLACES)



Battery Type

These battery packs may be used:

Battery	(kg)
DCB181	0.35
DCB182/DCB204	0.61
DCB183/DCB203	0.40
DCB184/DCB184G/DCB205	0.62
DCB187	0.54
DCB189/DCB240	0.54
DCBP034	0.32
DCBP520	0.75
DCBP320	0.5
DCB2108	0.95

Refer to the battery/charger section or manual for more information.

Date Code Position

The production date code consists of a 4-digit year followed by a 2-digit week and is extended by a 2-digit factory code.

Wall Mounting

Some DeWALT chargers are designed to be wall mountable or to sit upright on a table or work surface. If wall mounting, locate the charger within reach of an electrical outlet, and away from a corner or other obstructions which may impede air flow. Use the back of the charger as a template for the location of the mounting screws on the wall. Mount the charger securely using drywall screws (purchased separately) at least 1" (25.4 mm) long, with a screw head diameter of 0.28–0.35" (7–9 mm), screwed into wood to an optimal depth leaving approximately 7/32" (5.5 mm) of the screw exposed. Align the slots on the back of the charger with the exposed screws and fully engage them in the slots.

ASSEMBLY AND ADJUSTMENTS

WARNING: To reduce the risk of serious personal injury, turn tool off, and remove the battery pack before transporting, making any adjustments, cleaning, repairing, or removing/installing attachments or accessories. An accidental start-up can cause injury.

NOTE: Your miter saw is fully and accurately adjusted at the factory at the time of manufacture. If readjustment due to shipping and handling or any other reason is required, follow the steps below to adjust your saw.

Once made, these adjustments should remain accurate. Take a little time now to follow these directions carefully to maintain the accuracy of which your saw is capable.

Unpacking Your Saw

Check the contents of your miter saw carton to make sure that you have received all parts. In addition to this instruction manual, the carton should contain:

- 1 DCS714 miter saw
 - 1 Stabilizer bar
 - 1 Vacuum adapter
 - 1 DeWALT 10" (254 mm) diameter saw blade
 - 1 Material clamp
 - 1 Charger (Kit only)
 - 1 Battery (Kit only)
- In bag:
- 1 Dust bag
 - 1 Blade wrench
 - 1 Instruction manual

Specifications

Capacity of cut

45° miter left and 45° miter right	Resulting Height 2.85" (72.5 mm)
45° bevel left and right	Resulting Height 2.85" (72.5 mm)
0° miter	Resulting Height 1.6" (41.9 mm)
45° miter	Resulting Height 1" (25.6 mm)
45° bevel - Left	
45° bevel - Right	

Your saw is capable of cutting baseboard moldings 0.67" (17 mm) thick by 5.25" (133 mm) tall against fence on a 45° left miter and nip cut on a 45° right miter.

Drive

- 20 Volt motor
- 4900 RPM
- Cut helical gears and bevel gears
- Carbide tooth blade
- Automatic electric brake

Familiarization (Fig. A, D)

Your miter saw is not fully assembled in the carton. Refer to **Assembling the Stabilizer Bar** section for assembly instructions. Open the box and lift the saw out by the convenient lifting handle **15**, as shown in Figure D.

Place the saw on a smooth, flat surface such as a workbench or strong table.

Examine Figure A to become familiar with the saw and its various parts. The section on adjustments will refer to these terms and you must know what and where the parts are.

CAUTION: Pinch Hazard. To reduce the risk of injury, keep thumb underneath the handle when pulling the handle down. The lower guard will move up as the handle is pulled down which could cause pinching. The handle is placed close to the guard for special cuts.

Press down lightly on the operating handle **2** and pull the head lock knob **19** and rotate 90 degrees. Gently release the downward pressure and hold the arm allowing it to rise to its full height. Use the head lock knob when carrying the saw from one place to another. Always use the lifting handle **15** to transport the saw or the hand indentations **11** shown in Figure A.

Use of CUTLINE™ LED Worklight (Fig. A)

CAUTION: Do not stare into worklight. Serious eye injury could result.

NOTE: The battery must be charged and connected to the miter saw.

The CUTLINE™ LED Worklight can be turned on by the CUTLINE™ on switch **21**. The light will automatically turn off within 20 seconds if the saw is not in use. The light is also activated automatically every time the tool's main trigger **1** is pulled.

To cut through an existing pencil line on a piece of wood, turn on the CUTLINE™ worklight using the CUTLINE™ on switch **21** (not with the main trigger), then pull down on the operating handle **2** to bring the saw blade close to the wood. The shadow of the blade will appear on the wood. This shadow line represents the material that the blade will remove when performing a cut. To correctly locate your cut to the pencil line, align the pencil line with the edge of the blade's shadow. Keep in mind that you may have to adjust the miter or bevel angles in order to match the pencil line exactly.

Your saw is equipped with a battery monitoring feature. The CUTLINE™ worklight begins to flash when the battery is near the end of its useful charge and/or when the battery is too hot. Charge the battery prior to continuing cutting applications. Refer to **Charging a Battery** under **Important Safety Instructions for All Battery Chargers** for battery charging instructions.

Miter Control (Fig. A)

The miter lock handle and miter detent latch allow you to miter your saw to 50° right and 50° left. To miter the saw, lift the miter lock handle **7**, squeeze the miter detent latch **8** and

move the miter arm to the angle desired on the miter scale **9** as shown at the miter scale pointer **26**. Push down on the miter lock handle to lock the miter arm in place.

Override the miter detent latch by unlocking the miter lock knob and rotating the miter detent override switch **27** upward. To exit the override, push the miter detent override switch downward.

Bench Mounting (Fig. A)

Mounting holes **5** are provided in all 4 feet to facilitate bench mounting, as shown in Figure A. (Two different-sized holes are provided to accommodate different sizes of screws. Use either hole, it is not necessary to use both.) Always mount your saw firmly to a stable surface to prevent movement. To enhance the tool's portability, it can be mounted to a piece of 1/2" (12.7 mm) or thicker plywood which can then be clamped to your work support or moved to other job sites and reclamped.

NOTE: If you elect to mount your saw to a piece of plywood, make sure that the mounting screws don't protrude from the bottom of the wood. The plywood must sit flush on the work support. When clamping the saw to any work surface, clamp only on the clamping bosses where the mounting screw holes are located. Clamping at any other point will surely interfere with the proper operation of the saw.

CAUTION: To prevent binding and inaccuracy, be sure the mounting surface is not warped or otherwise uneven. If the saw rocks on the surface place a thin piece of material under one saw foot until the saw sits firmly on the mounting surface.

Assembling the Stabilizer Bar (Fig. E)

Your saw includes one base stabilizer **14**. This must be installed before using your saw. Insert the stabilizer into the holes in the back of the unit. Move the stabilizer in or out until it contacts the work surface. Then tighten the screws **48** in the base to fasten the stabilizer.

Changing or Installing a New Saw Blade (Fig. A, F)

WARNING: To reduce the risk of serious personal injury, turn tool off, and remove the battery pack before transporting, making any adjustments, cleaning, repairing, or removing/installing attachments or accessories. An accidental start-up can cause injury.

CAUTION:

- Never depress the spindle lock button while the blade is under power or coasting.
- Do not cut ferrous metal (containing iron or steel) or masonry or fiber cement product with this miter saw.

Removing the Blade (Fig. A, F)

1. Remove battery pack **3** from the saw.
2. Lock the head in the down position, using the head lock knob **19**.
3. Depress the spindle lock button **28** while carefully rotating the saw blade by hand until the lock engages.
4. Using your finger, pivot the blade bolt plate **30** to gain access to the blade bolt head **32**.
5. Keeping the spindle lock button depressed and the blade bolt plate pushed out of the way, use the blade wrench **29** to loosen blade bolt. (Turn clockwise, left-hand threads). Remove the blade bolt.
6. Raise the head to the upper position to remove the blade. To do so, unlock the head lock knob **19** and allow the head to raise slowly. Once the head is fully raised, rotate the lower guard as far as possible to access the blade.

WARNING: Be careful when moving the head to the upper position and rotating the lower guard as the blade, blade adaptor, and outer clamp washer may shift when rotating the head.

7. Proceed to remove the outer clamp washer, and saw blade.

Installing a Blade (Fig. A, F)

1. Remove battery pack **3** from the saw.
2. Raise the head to the upper position, with the head lock knob **19**. Raise the lower guard **6** as far as possible.
3. Place the blade **31** on the spindle, followed by the outer clamp washer **49**. Make sure to match the arrow direction on blade with the arrow direction on guard plate.
4. Slowly rotate the head into the down position and lock in place using the head lock knob.

WARNING: Be careful when moving the head to the lower position as the blade, blade adaptor, and outer clamp washer may shift when rotating the head.

5. Depress the spindle lock button **28** while carefully rotating the saw blade by hand until the lock engages.
6. Using your finger, pivot the blade bolt plate **30** to gain access for the blade bolt **32**.
7. Keeping the spindle lock button depressed and the blade bolt plate pushed out of the way, use the blade wrench **29** to firmly tighten blade bolt. (Turn counterclockwise, left-hand threads).

Miter Scale Adjustment (Fig. A, G)

Unlock the miter lock handle **7** and swing the miter arm until the miter latch **8** locks it at the 0° miter position. Do not lock the miter lock handle. Place a square against the saw's fence and blade, as shown. (Do not touch the tips of the blade teeth with the square. To do so will cause an inaccurate measurement.) If the saw blade is not exactly perpendicular to the fence **12**, loosen the three miter scale screws **10** that hold the miter scale and move the miter lock handle and the scale left or right until the blade is perpendicular to the fence, as measured with the square. Retighten the three screws. Pay no attention to the reading of the miter pointer at this time.

NOTE: You will need to loosen the center miter scale screw prior to setting the miter latch in the 0° miter position.

Miter Pointer Adjustment (Fig. A)

Unlock the miter lock handle **7** to move the miter arm to the 0° miter position. With the miter lock handle unlocked, squeeze the miter detent latch **8** and allow the miter latch to snap into place as you rotate the miter arm to zero. Observe the miter pointer **26** and miter scale **9** shown in Figure A. If the pointer does not indicate exactly zero, loosen the miter pointer screw **24**. Holding the pointer in place, reposition the pointer and tighten the screw.

Bevel Square Adjustment (Fig. A, H, I)

To align the blade square to the table **18**, lock the arm in the down position with the head lock knob **19**. Place a square against the blade, ensuring the square is not on top of a tooth. Loosen the bevel lock knob **13** and ensure the arm is firmly against the 0° bevel stop. Rotate the 0° bevel adjustment screw **34** with the blade wrench **29** as necessary so that the blade is at 0° bevel to the table.

Bevel Pointer Adjustment (Fig. I)

Ensure saw is secure against the 0° bevel stop **25** and tighten bevel lock knob **13**. If one of the bevel pointers **35** does not indicate zero, loosen the screw **36** that holds it in place and move the pointer as necessary. Ensure the 0° bevel is correct and the bevel pointers are set before adjusting any other bevel angle screws.

Adjusting the 45° Bevel Stops (Fig. A, I)

NOTE: Adjust the bevel angles only after performing the 0° bevel angle and bevel pointer adjustment.

NOTE: You will need to adjust fences to adjust bevel stops. Refer to **Fence Adjustment** for instructions.

To adjust the right 45° bevel angle, loosen the bevel lock knob **13** and pull the 0° bevel stop, rotate 90° (either clockwise or counterclockwise) and let go for the spring loaded pin to lock in to override the 0° bevel stop. When the saw is fully to the right, if the bevel pointer does not indicate exactly 45°, turn the left 45° bevel adjustment screw **37** with the blade wrench **29** until the bevel pointer indicates 45°.

To adjust the left 45° bevel stop, first loosen the bevel lock knob and tilt the head to the left. If the bevel pointer does not indicate exactly 45°, turn the right 45° bevel adjustment screw **37** until the bevel pointer **35** reads 45°.

Adjusting the Bevel Stop to 22.5° (or 33.9°) (Fig. A, I)

NOTE: Adjust the bevel angles only after performing the 0° bevel angle and bevel pointer adjustment.

NOTE: You will need to adjust fences to adjust bevel stops. Refer to **Fence Adjustment** for instructions.

To set the left 22.5° bevel angle, flip out the left 22.5° bevel pawl **39**. Loosen the bevel lock knob **13** and tilt the head fully to the left. If the bevel pointer does not indicate exactly 22.5°, turn the crown adjustment screw **38** contacting the pawl with a 7/16" wrench until the bevel pointer reads 22.5°.

To adjust the right 22.5° bevel angle, flip out the right 22.5° bevel pawl. Loosen the bevel lock knob and pull the 0° bevel stop and rotate 90° to override the 0° bevel stop. When the saw is fully to the right, if the bevel pointer does not indicate exactly 22.5°, turn the crown adjustment screw contacting the pawl with a 7/16" wrench until the bevel pointer indicates exactly 22.5°.

To adjust for 33.9° stops, repeat process as stated above but with the 33.9° bevel pawl **43**.

Fence Adjustment (Fig. A)

In order that the saw can bevel to many bevel positions, one of the fences may have to be adjusted to provide clearance. To adjust each fence, loosen the fence adjustment knob **16** and slide the fence outward. Make a dry run with the saw turned off and check for clearance. Adjust the fence to be as close to the blade as practical to provide maximum workpiece support, without interfering with arm up and down movement. Tighten the fence adjustment knob securely. When the bevel operations are complete, don't forget to relocate the fence.

For certain cuts, it may be desirable to bring the fences closer to the blade. To use this feature, back the fence adjustment knobs out two turns and move the fences closer to the blade past the normal limit, then tighten the fence adjustment knobs to keep the fences in this location. When using this feature, make a dry run first to ensure the blade does not contact the fences.

NOTE: The tracks of the fences can become clogged with sawdust. If you notice that they are becoming clogged, use a brush or some low pressure air to clear the guide grooves.

Guard Actuation and Visibility (Fig. A, X)

CAUTION: Pinch Hazard. To reduce the risk of injury, keep thumb underneath the handle when pulling the handle down. The lower guard will move up as the handle is pulled down which could cause pinching.

The lower guard **6** on your saw has been designed to automatically uncover the blade when the arm is brought down and to cover the blade when the arm is raised.

The guard can be raised by hand when installing or removing saw blades or for inspection of the saw. NEVER RAISE THE LOWER GUARD MANUALLY UNLESS THE BLADE IS STOPPED.

NOTE: Certain special cuts of large material will require that you manually raise the guard. Refer to **Cutting Large Material** under **Special Cuts**.

The front section of the guard is louvered for visibility while cutting. Although the louvers dramatically reduce flying debris, they are openings in the guard and safety glasses should be worn at all times when viewing through the louvers.

Miter Lock Adjustment (Fig. A, J)

The miter lock rod **40** should be adjusted if the table of the saw can be moved when the miter lock handle **7** is locked (down). To adjust the miter lock **41**, put the miter lock handle

in the unlocked (up) position. Using a slotted screwdriver, adjust the lock rod in 1/8 clockwise turn increments to increase the lock force. To ensure the miter lock is functioning properly, re-lock the miter lock handle to a non-detent miter angle – for example, 34° – and make sure the table will not rotate.

Transporting the Saw (Fig. A)

WARNING: To reduce the risk of serious personal injury, turn tool off, and remove the battery pack before transporting, making any adjustments, cleaning, repairing, or removing/installing attachments or accessories. An accidental start-up can cause injury.

WARNING: To reduce the risk of serious personal injury, ALWAYS lock the miter lock handle **7**, bevel lock knob **13**, head lock knob **19** and fence adjustment knobs **16** before transporting saw.

In order to conveniently carry the miter saw from place to place, a lifting handle **15** has been included on the top of the saw arm and hand indentations **11** in the base.

Head Lock Knob (Fig. A)

WARNING: The head lock knob should be used ONLY when carrying or storing the saw. NEVER use the headlock knob for any cutting operation.

To lock the saw head in the down position, push the head down, rotate head lock knob **19** 90° and the spring loaded pin will lock in and release the saw head. This will hold the saw head safely down for moving the saw from place to place.

To release, press the saw head down, pull out the head lock knob and rotate 90°. Avoid uncontrolled release of the saw head.

FEATURES AND CONTROLS

WARNING: To reduce the risk of serious personal injury, turn tool off, and remove the battery pack before transporting, making any adjustments, cleaning, repairing, or removing/installing attachments or accessories. An accidental start-up can cause injury.

Bevel Lock Knob (Fig. A)

The bevel lock knob **13** allows you to bevel the saw 49° left or right. To adjust the bevel setting, turn the knob counterclockwise. The saw head bevels easily to the left or to the right once the 0° bevel stop **25** is in the 0° bevel override position. To tighten, turn the bevel lock knob clockwise.

0° Bevel Override (Fig. A)

The bevel stop override allows you to bevel the saw to the right past the 0° mark.

When engaged, the saw will automatically stop at 0° when brought up from the left. To move past 0° to the right, pull the 0° bevel stop **25**, rotate 90° (either clockwise or counterclockwise) and let go for the spring loaded pin to lock in.

To return the bevel to 0° bevel stop, pull the 0° bevel stop, rotate 90° (either clockwise or counterclockwise) and let go for the spring loaded pin will lock in.

45° Bevel Stop Override (Fig. I)

There are two bevel stop override sliders **42**, one on each side of the saw. To bevel the saw, left or right past 45°, loosen the 45° bevel stop screw **49** and push the 45° bevel stop slider rearward. Retighten the 45° bevel stop screw. When in the rearward position, the saw can bevel past these stops. When the 45° stops are needed, loosen the 45° bevel stop screw and slide the 45° bevel stop slider forward. Retighten the 45° bevel stop screw.

Crown Bevel Pawls (Fig. I)

When cutting crown molding laying flat, your saw is equipped to accurately and rapidly set a crown stop, left or right (refer to **Instructions for Cutting Crown Molding Laying Flat and Using the Compound Features**). The crown bevel pawl **43** can be rotated to contact the crown adjustment screw **38**. The saw is factory set to be used for typical crown in North America (52°/38°), but can be reversed to cut non-typical (45°/45°) crown. To reverse the crown bevel pawl, remove the retaining screw, the 22.5° bevel pawl and the 33.9° crown bevel pawl. Flip the crown bevel pawl so the 30° Δ is facing up. Reattach the screw to secure the 22.5° bevel pawl and the crown bevel pawl. The accuracy setting will not be affected.

22.5° Bevel Pawls (Fig. I)

Your saw is equipped to rapidly and accurately set a 22.5° bevel, left or right. The 22.5° bevel pawl **39** can be rotated to contact the crown adjustment screw.

Automatic Electric Brake

Your saw is equipped with an automatic electric blade brake which stops the saw blade within 5 seconds of trigger release. This is not adjustable.

On occasion, there may be a delay after trigger release to brake engagement. On rare occasions, the brake may not engage at all and the blade will coast to a stop.

If a delay or "skipping" occurs, turn the saw on and off 4 or 5 times. If the condition persists, have the tool serviced by an authorized DEWALT service center.

Always be sure the blade has stopped before removing it from the kerf. The brake is not a substitute for guards or for ensuring your own safety by giving the saw your complete attention.

WARNING: Always use eye protection. All users and bystanders must wear eye protection that conforms to ANSI Z87.1 (CAN/CSA Z94.3).

WARNING: To ensure the blade path is clear of obstructions, always make a dry run of the cut without power before making any cuts on the workpiece.

Installing and Removing the Battery Pack (Fig. A)

WARNING: Ensure the tool/appliance is in the off position before inserting the battery pack.

NOTE: For best results, make sure your battery pack is fully charged.

To install the battery pack **3** into the tool handle, align the battery pack with the rails inside the tool's handle and slide it into the handle until the battery pack is firmly seated in the tool and ensure that it does not disengage.

To remove the battery pack from the tool, press the release button **4** and firmly pull the battery pack out of the tool handle. Insert it into the charger as described in the charger section of this manual.

Body and Hand Position (Fig. K)



WARNING: To reduce the risk of serious personal injury, **ALWAYS** use proper hand position as shown.



WARNING: To reduce the risk of serious personal injury, **ALWAYS** hold securely in anticipation of a sudden reaction.

Proper positioning of your body and hands when operating the miter saw will make cutting easier, more accurate and safer. Never place hands near cutting area. Place hands no closer than 4" (100 mm) from the blade. Hold the workpiece tightly to the table and the fence when cutting. Keep hands in position until the trigger has been released and the blade has completely stopped. **ALWAYS MAKE DRY RUNS (UNPOWERED) BEFORE FINISH CUTS SO THAT YOU CAN CHECK THE PATH OF THE BLADE. DO NOT CROSS ARMS, AS SHOWN IN FIGURE K.** Keep both feet firmly on the floor and maintain proper balance. As you move the miter arm left and right, follow it and stand slightly to the side of the saw blade. View through the guard

louvers when following a pencil line.

Trigger Switch (Fig. L)

To turn the saw on, push the lock-off lever **33** to the left, then depress the trigger switch **1**. The saw will run while the switch is depressed. Allow the blade to spin up to full operating speed before making the cut. To turn the saw off, release the switch. Allow the blade to stop before raising the saw head. There is no provision for locking the switch on. A hole **44** is provided in the trigger for insertion of a padlock to lock the switch off.

Always be sure the blade has stopped before removing it from the kerf.

Dust Extraction (Fig. M)



CAUTION: Never operate this saw unless the dust bag or DEWALT dust extractor is in place. Wood dust may create a breathing hazard.

Your saw has a built-in dust port that allows an Airlock™ compatible dust collection system to be connected. Use of a non-Airlock dust collection system requires the use of the supplied vacuum adapter.

Our recommended optimal solution:

- Vacuum (DXV14P)
- Separator (DXVCS003)
- 2-1/2" x 7' Hose (DXVA19-2501)
- Vacuum Adapter: Used for DXV series vacuums and other non-Airlock compatible vacuums.

To Attach the Dust Bag (Fig. N)

1. Fit the dust bag **45** to the dust port **17** as shown in Figure N.

To Empty the Dust Bag (Fig. N)

1. Remove dust bag **45** from the saw and gently shake or tap the dust bag to empty.
2. Reattach the dust bag back onto the dust port **17**.

You may notice that all the dust will not come free from the bag. This will not affect cutting performance but will reduce the saw's dust collection efficiency. To restore your saw's dust collection efficiency, depress the spring inside the dust bag when you are emptying it and tap it on the side of the trash can or dust receptacle.

Through-Cutting Operations (Fig. A)

NOTE: Although this saw will cut wood and many non-ferrous materials, we will limit our detailed discussion to the cutting of wood only. The same guidelines apply to the other materials. **DO NOT CUT FERROUS (IRON AND STEEL) MATERIALS OR MASONRY WITH THIS SAW.** Do not use any abrasive blades.

NOTE: Refer to **Guard Actuation and Visibility** in the **Adjustments** section for important information about the lower guard before cutting.

Crosscuts (Fig. A, O)

A crosscut is made by cutting wood across the grain at any angle. A straight crosscut is made with the miter arm at the 0° position. Set and lock the miter arm at 0°, hold the wood firmly on the table and against the fence. Turn on the saw by squeezing the trigger switch **1** shown in Figure A.

When the saw comes up to speed (about 2 seconds) lower the arm smoothly and slowly to cut through the wood. Let the blade come to a full stop before raising arm.

Cutting of multiple pieces is not recommended but can be done safely by ensuring that each piece is held firmly against the table and fence.

NOTE: To provide greater crosscut capacity with reduced stroke, the blade on the DCS714 extends deeper into the table. As a result, a greater lifting force on the workpiece may be experienced during the cut.



CAUTION: Always use a work clamp to maintain control and reduce the risk of workpiece damage and personal injury, if your hands are required to be within 4" (100 mm) of the blade during the cut.

Miter crosscuts are made with the miter arm at some angle other than 0°. This angle is often 45° for making corners, but can be set anywhere from 0° to 50° left or 50° right. Make the cut as described above.

When performing a miter cut on workpieces wider than a 2x6 that are shorter in length, always place the longer side against the fence **12** (Figure O).

To cut through an existing pencil line on a piece of wood, match the angle as close as possible. Cut the wood a little too long and measure from the pencil line to the cut edge to determine which direction to adjust the miter angle and recut. This will take some practice, but it is a commonly used technique.

Bevel Cuts (Fig. A)

A bevel cut is a crosscut made with the saw blade leaning at an angle to the wood. In order to set the bevel, loosen the bevel lock **13**, and move the saw to the left or right as desired. (It is necessary to move the fence to allow clearance.) Once the desired bevel angle has been set, tighten the bevel lock firmly. Refer to the **Controls** section for detailed instructions on the bevel system.

Bevel angles can be set from 49° right to 49° left and can be cut with the miter arm set between 50° left or 50° right. At some extreme bevel angles the right or left fence may interfere with the motion of the saw during a cut even if it is moved fully outward. In those situations, the interfering fence can be temporarily removed in order to make the cut. To remove the fence, unscrew the fence adjustment knob **16** several turns and slide the fence completely out of the track. The other fence must remain on the saw and positioned to provide support to the workpiece during the cut. Perform a dry run to ensure proper workpiece support and saw motion prior to making the cut. Re-install the fence immediately after the cut is complete.

NOTE: Refer to **Fence Adjustment** in the **Adjustments** section for important information on adjusting the fences for certain bevel cuts.

Quality of Cut

The smoothness of any cut depends on a number of variables. Things like material being cut, blade type, blade sharpness and rate of cut all contribute to the quality of the cut.

When smoothest cuts are desired for molding and other precision work, a sharp (60 tooth carbide) blade and a slower, even cutting rate will produce the desired results.

Ensure that the material does not move or creep while cutting; clamp it securely in place. Always let the blade come to a full stop before raising arm.

If small fibers of wood still split out at the rear of the workpiece, stick a piece of masking tape on the wood where the cut will be made. Saw through the tape and carefully remove tape when finished.

For varied cutting applications, refer to the list of recommended saw blades for your saw and select the one that best fits your needs. Refer to **Saw Blades** under **Accessories**.

Clamping the Workpiece (Fig. A)



WARNING: To reduce the risk of serious personal injury, turn tool off, and remove the battery pack before transporting, making any adjustments, cleaning, repairing, or removing/installing attachments or accessories. An accidental start-up can cause injury.



WARNING: A workpiece that is clamped, balanced and secure before a cut may become unbalanced after a cut is completed. An unbalanced load may tip the saw or anything the saw is attached to, such as a table or workbench. When making a cut that may become unbalanced, properly support the workpiece and ensure the saw is firmly bolted to a stable surface. Personal injury may occur.



WARNING: The clamp foot must remain clamped above the base of the saw whenever the clamp is used. Always clamp the workpiece to the base of the saw—not to any other part of the work area. Ensure the clamp foot is not clamped on the edge of the base of the saw.



CAUTION: Always use a work clamp to maintain control and reduce the risk of workpiece damage and personal injury.

If you cannot secure the workpiece on the table and against the fence by hand, (irregular shape, etc.) or your hand would be less than 4" (100 mm) from the blade, a clamp or other fixture must be used.

For best results use the vertical material clamp **22** provided with your saw. Additional clamps can be purchased at your local retailer or DEWALT service center.

Other aids such as spring clamps, bar clamps or C-clamps may be appropriate for certain sizes and shapes of material. Use care in selecting and placing these clamps. Take time to make a dry run before making the cut. The left fence will slide from side to side to aid in clamping

To Install Clamp (Fig. A)

1. Insert clamp post into the hole behind the fence **12**.
2. Adjust the clamp up turning the knob counterclockwise. And clamp down by turning the knob clockwise. Make sure to firmly clamp the workpiece.

NOTE: Place the clamp on the opposite side of the base when beveling. **ALWAYS MAKE DRY RUNS (UNPOWERED) BEFORE FINISH CUTS TO CHECK THE PATH OF THE BLADE. ENSURE THE CLAMP DOES NOT INTERFERE WITH THE ACTION OF THE SAW OR GUARDS.**

Support for Long Pieces



WARNING: To reduce the risk of serious personal injury, turn tool off, and remove the battery pack before transporting, making any adjustments, cleaning, repairing, or removing/installing attachments or accessories. An accidental start-up can cause injury.

ALWAYS SUPPORT LONG PIECES.

Never use another person as a substitute for a table extension; as additional support for a workpiece that is longer or wider than the basic miter saw table or to help feed, support or pull the workpiece.

Support long workpieces using any convenient means such as sawhorses or similar devices to keep the ends from dropping, ensuring the stability of the workpiece.

Cutting Picture Frames, Shadow Boxes and Other Four-Sided Projects (Fig. P)

To best understand how to make the items listed here, we suggest that you try a few simple projects using scrap wood until you develop a "feel" for your saw. Your saw is the perfect tool for mitering corners like the one shown in Figure P. Sketch 1 shows a joint made by using the bevel adjustment to bevel the edges of the two boards at 45° each to produce a 90° corner. For this joint the miter arm was locked in the 0° position and the bevel adjustment was locked at 45°. The wood was positioned with the broad flat side against the table and the narrow edge against the fence. The cut could also be made by mitering right and left with the broad surface against the fence.

Cutting Trim Molding and Other Frames (Fig. P)

Sketch 2 in Figure P shows a joint made by setting the miter arm at 45° to miter the two boards to form a 90° corner. To make this type of joint, set the bevel adjustment to 0° and the miter arm to 45°. Once again, position the wood with the broad flat side on the table and the narrow edge against the fence.

The two sketches in Figure P are for four-sided objects only.

As the number of sides changes, so do the miter and bevel angles. The chart below gives the proper angles for a variety of shapes.

– EXAMPLES –

NUMBER OF SIDES	MITER OR BEVEL ANGLE
4	45°
5	36°
6	30°
7	25.7°
8	22.5°
9	20°
10	18°

The chart assumes that all sides are of equal length. For a shape that is not shown in the chart, use the following formula: 180° divided by the number of sides equals the miter (if the material is cut vertically) or bevel angle (if the material is cut laying flat).

Cutting Compound Miters (Fig. Q)

A compound mitre is a cut made using a mitre angle and a bevel angle at the same time. This is the type of cut used to make frames or boxes with slanting sides like the one shown in Figure Q.

WARNING: If the cutting angle varies from cut to cut, check that the bevel lock knob and the mitre lock handle are securely locked. These must be locked after making any changes in bevel or mitre.

The chart shown below will assist you in selecting the proper bevel and mitre settings for common compound mitre cuts.

- Select the desired angle A (Fig. Q, Angle A+ Exteriors Angles = 90°) of your project and locate that angle on the appropriate arc in the chart.
- From that point follow the chart straight down to find the correct bevel angle and straight across to find the correct mitre angle.
- Set your saw to the prescribed angles and make a few trial cuts. Practise fitting the cut pieces together.

Example: To make a 4-sided box with 65° exterior angles (Angle A, Fig. Q), $25^\circ(\text{Angle A}) = 90^\circ - 65^\circ(\text{Exteriors Angles})$, use the upper right arc. Find 25° on the arc scale. Follow the horizontal intersecting line to either side to get mitre angle setting on saw (23°). Likewise, follow the vertical intersecting line to the top or bottom to get the bevel angle setting on the saw (40°). Always try cuts on a few scrap pieces of wood to verify the settings on the saw.

Cutting Base Molding (Fig. R)

ALWAYS MAKE A DRY RUN WITHOUT POWER BEFORE MAKING ANY CUTS.

Straight 90° Cuts (Fig. S)

Position the wood against the fence as shown in Figure R. Turn on the saw, allow the blade to reach full speed and lower the arm smoothly through the cut.

Cutting Base Molding up to 3.25" (82 mm) High Vertically Against The Fence (Fig. R)

Position molding as shown in Figure R.

All cuts are made with the back of the molding against the fence and bottom of the molding against the base.

	Inside corner	Outside corner
Left side	1. Miter left 45° 2. Save left side of cut	1. Miter right 45° 2. Save left side of cut
Right side	1. Miter right 45° 2. Save right side of cut	1. Miter left 45° 2. Save right side of cut

Material up to 3.25" (82 mm) can be cut as described above. For wider boards [up to 5.25" (133 mm)] several minor concessions must be made.

When cutting a board between 3.25" (82 mm) and 5.25" (133 mm) in width, the roller on the tip of the guard could hang up on the workpiece. If this occurs, simply place your right thumb on the upper side of the guard and roll the guard up just enough to clear the workpiece, as shown in Figure A, X. Once you have cleared the workpiece, you can release the guard and it will continue to open as the cut progresses.

When mitering to the right side of a base molding taller than 3.25" (82 mm) standing vertically against the fence as in Figure S, the saw can only cut through the board up to 3/4" (19 mm) from the end of the board. Trying to cut more than 3/4" (19 mm) will cause the saw's gear case to interfere with the workpiece. If you want to cut base molding between 3.25" (82 mm) and 5.25" (133 mm) wide vertically follow the directions below.

Cutting 3.25"-5.25" (82 mm-133 mm) Base Molding Vertically Against the Fence (Fig. R)

Position molding as shown in Figure R.

All cuts made with the back of the molding against the fence

	Inside corner	Outside corner
Left side*	1. Position molding with bottom of molding against the base of the saw 2. Miter left 45° 3. Save left side of cut	1. Position molding with bottom of molding against the base of the saw 2. Miter right 45° 3. Save left side of cut
Right side	1. Position molding with top of molding against the base of the saw 2. Miter left 45° 3. Save left side of cut	1. Position molding with bottom of the molding against the base of the saw 2. Miter left 45° 3. Save right side of cut

* **NOTE:** If the cut must be made somewhere other than 3/4" (19 mm) from the end of the molding: cut off the molding at 90° approx. 3/4" (19 mm) longer than your final length then make the mitre cut as described above.

Another method of making the cut is to make a 0° mitre, 45° bevel cut. Your saw can cut a bevel 6" (153 mm) wide.

Cutting Base Molding Laying Flat and Using the Bevel Feature

All cuts made with the saw set at 45° bevel and 0° mitre.

All cuts made with back of molding laying flat on the saw.

Move the left or right fence out of the path of the blade before attempting any of the following cuts.

Place the top of the molding against the fence.

	Inside corner	Outside corner
Left side	1. Bevel 45° left 2. Save left side of cut	1. Bevel 45° right 2. Save left side of cut
Right side	1. Bevel 45° right 2. Save right side of cut	1. Bevel 45° left 2. Save right side of cut

Cutting Crown Molding

Your mitre saw is better suited to the task of cutting crown molding than any tool made. In order to fit properly, crown molding must be compound mitered with extreme accuracy. The two flat surfaces on a given piece of crown molding are at angles that, when added together, equal exactly 90°. Most, but not all, crown molding has a top rear angle (the section that fits flat against the ceiling) of 52° and a bottom rear angle (the part that fits flat against the wall) of 38°.

Your mitre saw has special pre-set mitre latch points at 31.6° left and right for cutting crown molding at the proper angle and bevel stop pawls at 33.9° left and right. There is also a mark on the bevel scale at 33.9°.

The chart below gives the proper settings for cutting crown molding. (The numbers for the mitre and bevel settings are very precise and are not easy to accurately set on your saw.) Since most rooms do not have angles of precisely 90°, you will have to fine tune your settings anyway.

PRETESTING WITH SCRAP MATERIAL IS EXTREMELY IMPORTANT!

Instructions for Cutting Crown Molding Laying Flat and Using the Compound Features (Fig. A, S)

1. Molding laying with broad back surface down flat on saw table **18**.
2. Top of molding against fence **12**.
3. The settings below are for all standard (U.S.) crown molding with 52° and 38° angles.

	Inside corner	Outside corner
Left side	1. Bevel left 33.9° 2. Miter table set at right 31.62° 3. Save left side of cut	1. Bevel right 33.9° 2. Miter table set at left 31.62° 3. Save left side of cut
Right side	1. Bevel right 33.9° 2. Miter table set at left 31.62° 3. Save right side of cut	1. Bevel left 33.9° 2. Miter table set at right 31.62° 3. Save right side of cut

4. The settings below are for all standard (U.S.) crown molding with 45° and 45° angles.

	Inside corner	Outside corner
Left side	1. Bevel left 30°	1. Bevel right 30°
	2. Miter table set at right 35.3°	2. Miter table set at left 35.3°
	3. Save left side of cut	3. Save left side of cut
Right side	1. Bevel right 30°	1. Bevel left 30°
	2. Miter table set at left 35.3°	2. Miter table set at right 35.3°
	3. Save right side of cut	3. Save right side of cut

When setting bevel and miter angles for all compound miters, remember that:

The angles presented for crown moldings are very precise and difficult to set exactly. Since they can easily shift slightly and very few rooms have exactly square corners, all settings should be tested on scrap molding.

PRETESTING WITH SCRAP MATERIAL IS EXTREMELY IMPORTANT!

Alternative Method for Cutting Crown Molding (Fig. T)

Place the molding on the table at an angle between the sliding fence **12** and the saw table **18**, as shown in Figure T. Use of the crown molding fence accessory (DW7084) is highly recommended because of its degree of accuracy and convenience. The crown molding fence accessory is available for purchase from your local dealer.

The advantage to cutting crown molding using this method is that no bevel cut is required. Minute changes in the miter angle can be made without affecting the bevel angle. This way, when corners other than 90° are encountered, the saw can be quickly and easily adjusted for them. Use the crown molding fence accessory to maintain the angle at which the molding will be on the wall.

Instructions for Cutting Crown Molding Angled Between the Fence and Base of the Saw for All Cuts

1. Angle the molding so the bottom of the molding (part which goes against the wall when installed) is against the fence and the top of the molding is resting on the base of the saw, as shown in Figure T.
2. The angled "flats" on the back of the molding must rest squarely on the fence and base of the saw.

	Inside corner	Outside corner
Left side	1. Miter right 45°	1. Miter left 45°
	2. Save right side of cut	2. Save right side of cut
Right side	1. Miter left 45°	1. Miter right 45°
	2. Save left side of cut	2. Save left side of cut

Special Cuts

NEVER MAKE ANY CUT UNLESS THE MATERIAL IS SECURED ON THE TABLE AND AGAINST THE FENCE.

Aluminum Cutting (Fig. A, U)

ALWAYS USE THE APPROPRIATE SAW BLADE MADE ESPECIALLY FOR CUTTING ALUMINUM. These are available at your local DEWALT retailer or DEWALT service center. Certain workpieces, due to their size, shape or surface finish, may require the use of a clamp or fixture to prevent movement during the cut. Position the material so that you will be cutting the thinnest cross section, as shown in Figure U. Figure U also illustrates the wrong way to cut these extrusions. Use a stick wax cutting lubricant when cutting aluminum. Apply the stick wax directly to the saw blade **31** before cutting. Never apply stick wax to a moving blade.

The wax, available at most hardware stores and industrial mill supply houses, provides proper lubrication and keeps chips from adhering to the blade.

Be sure to properly secure workpiece.

Refer to **Saw Blades** under **Accessories** for correct saw blade.

Bowed Material (Fig. V, W)

When cutting bowed material always position it as shown in Figure V and never like that shown in Figure W. Positioning the material incorrectly will cause it to pinch the blade near the completion of the cut.

Cutting Plastic Pipe or Other Round Material

Plastic pipe can be easily cut with your saw. It should be cut just like wood and **CLAMPED OR HELD FIRMLY TO THE FENCE TO KEEP IT FROM ROLLING**. This is extremely important when making angle cuts.

Cutting Large Material (Fig. A, X)

Occasionally you will encounter a piece of wood a little too large to fit beneath the lower guard **6**. If this occurs, simply place your right thumb on the upper side of the guard and roll the guard up just enough to clear the workpiece, as shown in Figure A, X. Avoid doing this as much as possible, but if need be, the saw will operate properly and make the bigger cut. NEVER TIE, TAPE, OR OTHERWISE HOLD THE GUARD OPEN WHEN OPERATING THIS SAW.

MAINTENANCE

WARNING: To reduce the risk of serious personal injury, turn tool off, and remove the battery pack before transporting, making any adjustments, cleaning, repairing, or removing/installing attachments or accessories. An accidental start-up can cause injury.

WARNING: To reduce the risk of serious personal injury, DO NOT touch the sharp points on the blade with fingers or hands while performing any maintenance.

DO NOT use lubricants or cleaners (particularly spray or aerosol) in the vicinity of the plastic guard. The polycarbonate material used in the guard is subject to attack by certain chemicals.

1. All bearings are sealed. They are lubricated for life and need no further maintenance.
2. Periodically clean all dust and wood chips from around AND UNDER the base and the rotary table. Even though slots are provided to allow debris to pass through, some dust will accumulate.

Cleaning

WARNING: Blow dirt and dust out of all air vents with clean, dry air at least once a week. To minimize the risk of eye injury, always wear ANSI Z87.1 approved eye protection when performing this procedure.

WARNING: Never use solvents or other harsh chemicals for cleaning the non-metallic parts of the tool. These chemicals may weaken the plastic materials used in these parts. Use a cloth dampened only with water and mild soap. Never let any liquid get inside the tool; never immerse any part of the tool into a liquid.

Worklight Cleaning

For the best worklight performance, perform the following maintenance regularly.

1. Carefully clean sawdust and debris from worklight lens with a cotton swab.
2. DO NOT use solvents of any kind, they may damage the lens.
3. Dust build-up can block the worklight and prevent it from accurately indicating the line of cut.
4. Follow miter saw's instruction manual to remove and install blade.
5. With blade removed from saw, clean pitch and build-up from blade. Pitch and debris can interfere with the worklight and prevent it from accurately indicating the line of cut.

SPECIFICATIONS	
Light source	Power LED
Worklight	6 V DC
Operating Temperature	-40 °F to 221 °F (-40 °C to 105 °C)
Storage Temperature	-40 °F to 221 °F (-40 °C to 105 °C)
Environmental	Water resistant

Dust Duct Cleaning

Depending on your cutting environment, saw dust can clog the dust duct and may prevent dust from flowing away from the cutting area properly. With the saw unplugged and the saw head raised fully, low pressure air or a large diameter dowel rod can be used to clear the dust out of the dust duct.

Accessories

WARNING: Since accessories, other than those offered by DEWALT, have not been tested with this product, use of such accessories with this tool could be hazardous. To reduce the risk of injury, only DEWALT recommended accessories should be used with this product.

Recommended accessories for use with your tool are available at extra cost from your local dealer or authorized service center.

Optional Accessories

The following accessories, designed for your saw, may be helpful. Use care in selecting and using accessories.

Dust Bag: DW7053

Equipped with a zipper for easy emptying, the dust bag will capture the majority of the sawdust produced.

Crown Molding Fence: DW7084

Used for precision cutting of crown molding.

Saw Blades

ALWAYS USE 10" (254 mm) SAW BLADES. SPEED RATING MUST BE AT LEAST 4900 RPM. Never use a smaller diameter blade. It will not be guarded properly. Use crosscut blades only! Do not use blades designed for ripping, combination blades or blades with hook angles in excess of 7°.

BLADE DESCRIPTIONS		
APPLICATION	DIAMETER	TEETH
Construction Saw Blades (maximum thin kerf with anti-stick rim)		
General Purpose	10" (254 mm)	32/40
Fine Crosscuts	10" (254 mm)	60
Woodworking Saw Blades (provide smooth, clean cuts)		
Fine crosscuts	10" (254 mm)	80
Non-ferrous metals	10" (254 mm)	80

NOTE: For cutting non-ferrous metals, use only saw blades with TCG teeth designed for this purpose.

Protecting the Environment



Products/batteries are recyclable, but if marked with the crossed-out bin, they must not be disposed of with normal household waste.

Run the batteries down completely and separate them, and separate any light sources from the product if possible. It is the user's responsibility to delete personal data from the product. Then take the waste to an official waste collection center or a participating retailer who will

ENGLISH

often accept it free of charge. Packaging should be discarded based on the marked material code. Operating and safety instructions should only be discarded once the applicable product is no longer in use.

Please check with your local community/municipality for waste management guidance. For further information, visit www.2helpU.com.

After Service and Repair

DeWALT service centers are staffed with trained personnel to provide customers with efficient and reliable product service. We do not take any responsibility when you have repaired in unauthorized service center. You can refer to the leaflet of CONTACT CENTER LOCATOR in product package and contact us through hotline, website or social media to find the nearest DeWALT service center around you.

Troubleshooting Guide

BE SURE TO FOLLOW SAFETY RULES AND INSTRUCTIONS

TROUBLE!	WHAT'S WRONG?	WHAT TO DO
Saw will not start	Battery not installed	Install battery. Refer to <i>Installing and Removing the Battery Pack</i> .
	Battery not charged	Charge battery. Refer to <i>Charging a Battery</i> .
	Saw overheated	Wait several minutes for saw to cool.
	Batteries overheated	Wait several minutes for batteries to cool.
Saw makes unsatisfactory cuts	Dull blade	Replace blade. Refer to <i>Changing or Installing a New Saw Blade</i> .
	Blade mounted backwards	Turn blade around. Refer to <i>Changing or Installing a New Saw Blade</i> .
	Gum or pitch on blade	Remove blade and clean with coarse steel wool and turpentine or household oven cleaner.
	Incorrect blade for work being done	Change the blade type. Refer to Saw Blades under <i>Optional Accessories</i> .
CUTLINE worklight is flashing	Battery not charged	Charge battery. Refer to <i>Charging a Battery</i> .
Machine vibrates excessively	Saw not mounted securely to stand or work bench	Tighten all mounting hardware. Refer to <i>Bench Mounting</i> .
	Stand or bench on uneven floor	Reposition on flat level surface. Refer to <i>Familiarization</i> .
	Damaged saw blade	Replace blade. Refer to <i>Changing or Installing a New Saw Blade</i> .
Does not make accurate miter cuts	Miter scale not adjusted correctly	Check and adjust. Refer to Miter Scale Adjustment under <i>Assembly and Adjustments</i> .
	Blade is not square to fence	Check and adjust. Refer to Miter Scale Adjustment under <i>Assembly and Adjustments</i> .
	Blade is not perpendicular to table	Check and adjust fence. Refer to Bevel Square Adjustment under <i>Assembly and Adjustments</i> .
	Workpiece moving	Clamp workpiece securely to fence or glue 120 grit sandpaper to fence with rubber cement.
	Kerf plate worn or damaged	Take to authorized service center.
Material pinches blade	Miter pointer not adjusted correctly	Check and adjust. Refer to Miter Pointer Adjustment under <i>Assembly and Adjustments</i> .
	Cutting bowed material	Refer to Bowed Material under <i>Special Cuts</i> .

TABLE 1: COMPOUND MITER CUT
(POSITION WOOD WITH BROAD FLAT SIDE ON THE TABLE AND THE NARROW EDGE AGAINST THE FENCE)

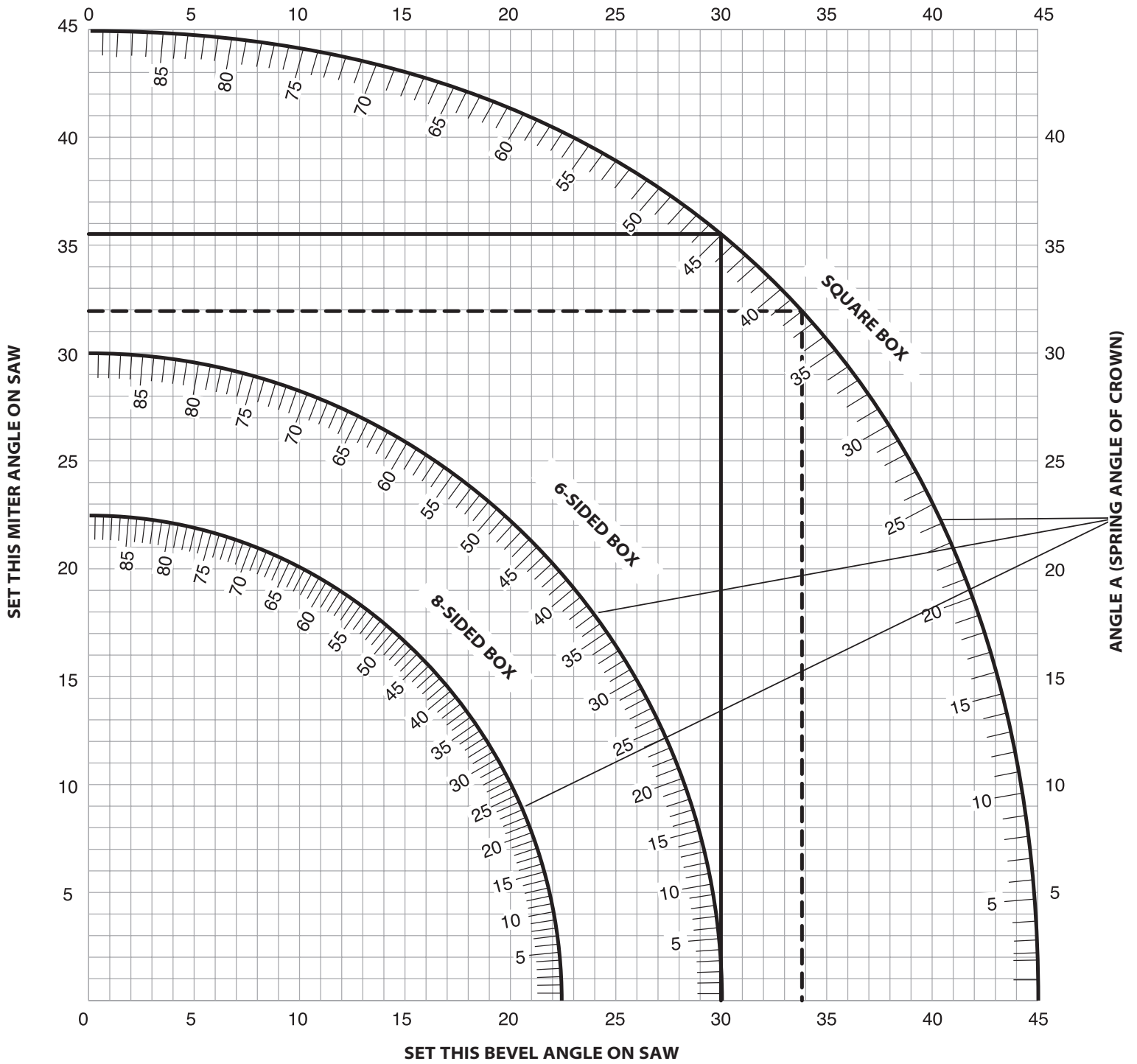

锂电无刷斜切锯

DCS714

恭喜!

感谢您选购DeWALT工具。凭借多年的产品开发和创新能力，DeWALT已经成为专业电动工具用户最可靠的合作伙伴之一。

技术参数

		DCS714
电压	V _{Dc}	18
电池类型		锂电池
锯片直径	毫米	254
锯片孔径	毫米	25.4
锯片厚度	毫米	1.75
最大开槽深度	毫米	3.2
最大空载转速	rpm	4900
90°最大横切能力	毫米	153
45°最大斜切能力	毫米	108
90°最大锯深	毫米	72.5
45°斜角最大锯深	毫米	41.9
最大斜切位置	向左 向右	50° 50°
最大斜切角	向左 向右	49° 49°
垂直切割 0° 转角		
底板最大加工高度为 133 毫米	毫米	17
最大宽度 153 毫米时成形高度	毫米	72.5
垂直切割 45° 转角 (左)		
最大宽度 108 毫米时成形高度	毫米	72.5
垂直切割 45° 转角 (右)		
最大宽度 108 毫米时成形高度	毫米	72.5
45° 斜切 (左)		
最大宽度 153 毫米时成形高度	毫米	41.9
45° 斜切 (右)		
最大宽度 153 毫米时成形高度	毫米	25.6
锯片自动制动时间	s	< 5
重量 (不含电池包)	千克	15.4

 **警告:** 请阅读所有警告和说明。若不遵循以下所示警告及指示,可能会导致触电、着火及/或严重伤害。

 **警告:** 为降低伤害风险,请阅读使用手册。

设计用途

这款重型斜切锯适用于专业木材切割。

本斜切锯是专业电动工具。

请勿在潮湿环境中,或在存在易燃液体或气体的环境中使用本工具。

请勿让儿童接触本工具。缺乏经验的操作员需要在监督下使用本工具。

定义:安全警示符号和语句。

该说明手册使用了以下安全警示符号和语句,针对危险情况和人身伤害或财产损失的风险发出警示。

 **危险:** 指示紧急的危险情况,如不加以避免,将导致死亡或严重伤害。

 **警告:** 指示潜在的危险情况,如不加以避免,可能导致死亡或严重伤害。

 **小心:** 指示潜在的危险情况,如不加以避免,可能导致轻度或中度伤害。

 (未配文字) 表示与安全有关的信息。

 **注意:** 指示不涉及人身伤害的情况,如不加以避免,可能导致财产损失。

电动工具通用安全警告

 **警告!** 阅读随电动工具提供的所有安全警告、说明、图示和规定。不遵照以下所列说明会导致电击、着火和/或严重伤害。

保存所有警告和说明书以备查阅。

警告中的术语“电动工具”指市电驱动(有线)电动工具或电池驱动(无线)电动工具。

1) 工作场地的安全

- 保持工作场地清洁和明亮。杂乱和黑暗的场地会引发事故。
- 不要在易爆环境,如有易燃液体、气体或粉尘的环境下操作电动工具。电动工具产生的火花会点燃粉尘或气体。
- 操作电动工具时,远离儿童和旁观者。注意力不集中会使你失去对工具的控制。

2) 电气安全

- 电动工具插头必须与插座相配。绝不能以任何方式改装插头。需接地的电动工具不能使用任何转换插头。未经改装的插头和相配的插座将降低电击风险。
- 避免人体接触接地表面,如管道、散热片和冰箱。如果你身体接触接地表面会增加电击风险。
- 不得将电动工具暴露在雨中或潮湿环境中。水进入电动工具将增加电击风险。
- 不得滥用软线。绝不能用软线搬运、拉动电动工具或拔出其插头。使软线远离热源、油、锐边或运动部件。受损或缠绕的软线会增加电击风险。
- 当在户外使用电动工具时,使用适合户外使用的延长线。适合户外使用的电线将降低电击风险。
- 如果无法避免在潮湿环境中操作电动工具,应使用带有接地故障电路断路器(GFCI)保护的电源。RCD的使用可降低电击风险。

3) 人身安全

- 保持警觉,当操作电动工具时关注所从事的操作并保持清醒。当你感到疲倦,或在有药物、酒精或治疗反应时,不要操作电动工具。在操作电动工具时瞬间的疏忽会导致严重人身伤害。
- 使用个人防护装置。始终佩戴护目镜。防护装置,诸如适当条件下使用防尘面具、防滑安全鞋、安全帽、听力防护等装置能减少人身伤害。
- 防止意外启动。在连接电源和/或电池包、拿起或搬运工具前确保开关处于关断位置。手指放在开关上搬运工具或开关处于接通时通电会导致危险。
- 在电动工具接通之前,拿掉所有调节钥匙或扳手。遗留在电动工具旋转零件上的扳手或钥匙会导致人身伤害。
- 手不要过分伸展。时刻注意立足点和身体平衡。这样能在意外情况下能更好地控制住电动工具。
- 着装适当。不要穿宽松衣服或佩戴饰品。让你的头发和衣服远离运动部件。宽松衣服、配饰或长发可能会卷入运动部件。
- 如果提供了与排屑、集尘设备连接用的装置,要确保其连接完好且使用得当。使用集尘装置可降低尘屑引起的危险。
- 不要因为频繁使用工具而产生的熟悉感而掉以轻心,忽视工具的安全准则。某个粗心的动作可能在瞬间导致严重的伤害。

4) 电动工具使用和注意事项

- 不要勉强使用电动工具，根据用途使用合适的电动工具。选用合适的按照额定值设计的电动工具会使你工作更有效、更安全。
- 如果开关不能接通或关断电源，则不能使用该电动工具。不能通过开关来控制的电动工具是危险的且必须进行修理。
- 在进行任何调节、更换附件或贮存电动工具之前，必须从电源上拔掉插头和/或卸下电池包(如可拆卸)。这种防护性的安全措施降低了电动工具意外起动的风险。
- 将闲置不用的电动工具贮存在儿童所及范围之外，并且不允许不熟悉电动工具和不了解这些说明的人操作电动工具。电动工具在未经培训的使用者手中是危险的。
- 维护电动工具及其附件。检查运动部件是否调整到位置或卡住，检查零件破损情况和影响电动工具运行的其他状况。如有损坏，应在使用前修理好电动工具。许多事故是由维护不良的电动工具引发的。
- 保持切削刀具锋利和清洁。维护良好地有锋利切削刃的刀具不易卡住而且容易控制。
- 按照使用说明书，并考虑作业条件和要进行的作业来选择电动工具、附件和工具的刀头等。将电动工具用于那些与其用途不符的操作可能会导致危险情况。
- 保持手柄和握持表面干燥、清洁，不得沾有油脂。在意外的情况下，湿滑的手柄不能保证握持的安全和对工具的控制。

5) 电池式工具使用和注意事项

- 仅使用生产者规定的充电器充电。将适用于某种电池包的充电器用到其他电池包时可能会发生着火危险。
- 仅使用配有专用电池包的电动工具。使用其他电池包可能会产生伤害和着火危险。
- 当电池包不用时，将它远离其他金属物体，例如回形针、硬币、钥匙、钉子、螺丝或其他小金属物体，以防电池包一端与另一端连接。电池包端部短路会引起燃烧或着火。
- 在滥用条件下，液体可能会从电池包中溅出，应避免接触。如果意外碰到液体，用水冲洗。如果液体碰到了眼睛，还要寻求医疗帮助。从电池中溅出的液体可能会发生腐蚀或燃烧。
- 不要使用损坏或改装过的电池包或工具。损坏或改装过的电池包可能呈现无法预测的结果，导致着火、爆炸或伤害。
- 请勿将电池包暴露于火或者高温中。电池包暴露于火或高于130°C的高温中可能导致爆炸。
- 请遵循所有充电说明，请勿在说明中规定的温度范围以外的环境对电池包或工具充电。不当充电或在指定范围以外的温度下充电，可能导致电池损坏并增加着火风险。

6) 维修

- 让专业维修人员使用相同的备件维修电动工具。这将保证所维修的电动工具的安全。
- 决不能维修损坏的电池包。电池包仅能由生产者或其授权的维修服务商进行维修。

斜切锯安全说明

- 斜切锯用于锯割木材或类似木材的产品，不能安装切割砂轮来锯割黑色金属材料，如钢筋、棒料、螺栓等。磨屑会导致下护罩等运动部件堵塞，砂轮锯割产生的火花可能会引燃下护罩、锯缝板或其他塑料件。
- 尽可能使用夹紧装置支撑工件，如果用手支撑工件，必须保持手远离锯片两侧至少100mm。勿使用此锯割小到无法被可靠夹持或用手握持的工件。如果你的手离锯片太近会增加接触到刀片受伤的风险。
- 工件必须定位并被夹紧或抵靠在靠棚和工作台上，不要将工件送入锯片或以任何方式“徒手”锯割。不受约束的或移动的工件有可能会被高速抛出从而造成伤害。
- 将锯推过工件，不要将锯拉过工件。进行锯割时，抬起锯割装置并从工件上方拉过而不进行锯割，启动电机，向下按压锯割装置并将锯推过工件。在拉动行程上进行锯割可能导致锯片在工件顶部上爬行并猛烈地将锯片组件抛向操作者。
- 切勿将手越过锯片前方或后方设定的锯割线。“交叉手”握持工件，如用左手来握持锯片右侧工件，或反之，是非常危险的。
- 当锯片旋转时不要为了清除木屑或其它目的而将手从锯片任何一侧在距离刀片100mm范围内接近靠棚的后方。旋转的锯片接近你的手可能不易被发现从而导致严重伤害。
- 切割前检查工件，如果工件存在弯曲或翘曲，则需将弓形面外侧朝向靠棚夹紧，始终确保工件与靠棚、台面间沿切割方向没有间隙。弯曲或翘曲的工件在锯割时会产生抖动或窜动而卡住旋转的锯片。工件中不应有钉子或其他异物。
- 使用斜切锯前须确保台面上除工件外没有任何工具、木片等。接触锯片的小碎片、松散的木材或其它物体会引起高速抛掷。
- 每次只能锯割一个工件。多个堆放在一起的工件不能被充分地夹持或支撑，在锯割过程中容易卡住锯片或发生窜动。
- 使用前请确保斜切锯被安装或放置在水平结实的工作面上。水平结实的工作表面可以降低斜切锯不稳定的风险。
- 规划好你的工作。每次改变倾斜角或斜切角的设置要确保可靠靠棚能正确地支撑工件并且不干涉锯片或防护装置。在工具没有“开机”且工作台上没有工件时移动锯片进行一次完整的模拟锯割以确保不会有任何干涉或锯割靠棚的危险。
- 对于宽度或长度超出台面的工件需要为工件提供足够支撑，如延伸台面、锯木架等。长度或宽度超出斜切锯台面的工件如果没有被安全支撑会倾倒。被切断的部分或工件倾倒会抬起下护罩或被旋转的刀片抛出。
- 不要另一个人来代替延伸台面或作为辅助支撑。在切割过程中不可靠的工件支撑会使锯片被卡住或引起工件移位，将你和助手拉入旋转锯片中。

- 切断的部分不能以任何方式被堵在或挤压在旋转的锯片上。如果受到如长度挡块的限制，切断部分可能会被挤在锯片上并被猛烈抛出。
- 当锯割棒料或管等圆形材料时，总是使用为此而设计的夹持或固定装置。棒料被锯割时有滚动倾向，会引起锯片“啃料”并将工件连你的手拉向锯片。
- 在锯片接触工件前让其达到全速。这将降低工件被抛出的风险。
- 如果工件或锯片被卡住，关闭斜切锯，等所有运动部件停止并从电源上拔出插头并/或取下电池包，然后清理被卡住的材料。在工件被卡住时继续切割会造成斜切锯的失控或损坏。
- 完成锯割后，松开电源开关，继续按住锯割装置，待锯片停止后再清理锯割下部分。用手靠近还在转动的锯片是危险的。
- 在进行不完全锯割时，或在斜切锯锯割装置未到达完全下压位置之前松开电源开关时，应牢牢握住手柄。斜切锯的刹车动作可能导致锯割装置被突然下拉而引起受伤风险。

斜切锯的附加安全规范



警告：请勿因频繁使用本锯而熟悉操作后，便忽视安全规则。务必时刻谨记，即使是瞬间的疏忽，也足以造成严重伤害。



警告：不得改装本电动工具或其任何部件。否则，可能造成人身伤害或工具损坏。

- 在根据说明完成设备的组装和安装前，请勿操作该设备。安装不当的设备会造成严重伤害。
- 如果您对该设备的操作不够熟悉，请咨询您的主管、指导人员或其他有资质的人员。知识就是安全。
- 请确保锯片旋转方向正确。锯齿应指向转动方向，如斜切锯上的标记所示。
- 先拧紧所有夹紧手柄、把手和杠杆，再开始操作。如果夹子松动，可能会导致部件或工件被高速抛出。
- 请确保所有锯片和锯片夹都足够清洁，锯片夹的凹陷侧会抵住锯片同时拧紧圆头螺丝。松动或不当的锯片夹可能会损坏斜切锯并造成可能的人员受伤。
- 请勿在斜切锯指定电压以外的任何电压下操作。可能会出现过热、工具损坏和人员受伤。
- 严禁为固定电机轴而用任何物体卡住风扇。可能会损坏工具或造成人员受伤。
- 绝对禁止切割黑色金属或砖石等材料。切割此类材料可能导致硬质合金刀头从锯片上崩飞，从而引发严重伤害。
- 手部的任何部位均不得进入距锯片100毫米(4英寸)以内的范围。
- 不得让身体的任何部位与锯片路径处于同一直线。这可能会造成人员受伤。
- 不得在转动的锯片上涂抹锯片润滑油。涂抹润滑油会让您将手伸入锯片中，从而造成严重受伤。
- 当斜切锯通电时，请勿将手放在锯片区域内。如果无意间启动斜切锯，就会造成严重受伤。
- 不得触及锯片周围或后面。锯片可能会造成严重受伤。
- 除非已切断斜切锯电源并将其关闭，否则请勿触碰斜切锯下方。接触锯片可能会造成人员伤害。
- 将设备固定在稳定的支撑表面。振动可能会导致设备滑动、移动或倾翻，从而造成严重人身伤害。
- 仅使用针对斜切锯的横切锯片。为实现最佳结果，请勿使用钩角超过7°的硬质合金锯片。请勿使用带有深沟槽的锯片。这些会偏转并触碰护板，损坏设备和/或造成严重伤害。
- 仅使用适用于该工具且尺寸和类型都恰当的锯片，防止损坏设备和/或造成严重伤害。
- 在操作前，请先检查锯片是否存在开裂或其他损坏。开裂或受损的锯片会破碎，而且碎片会被高速抛出，造成严重伤害。请立即更换开裂或受损的锯片。
- 在操作前，请先清洁锯片和锯片夹。通过清洁锯片和锯片夹，可检查锯片或锯片夹上是否有任何损坏。开裂或受损的锯片或锯片夹会破碎，而且碎片会被高速抛出，造成严重伤害。
- 请勿使用扭曲的锯片。检查锯片是否运转正常，是否没有振动。振动的锯片会损坏设备和/或造成严重伤害。
- 请勿在塑料护板附近使用润滑剂或清洁剂(尤其是喷雾或气雾剂)。护板使用的聚碳酸酯材料易受到特定化学制品的腐蚀。
- 请保持护板维持原位且能够正常工作。
- 务必使用工作台盖板并在其受损时予以更换。在斜切锯下累积的细小碎屑会影响锯片，或可能会让工件在切割时不稳定。
- 仅使用专为该工具提供的锯片夹，防止设备受损和/或造成严重伤害。
- 清洁电机气道中的碎屑和锯末。阻塞的电机气道会导致设备过热，损坏设备并可能造成短路，导致严重伤害。
- 不得将开关锁定在“开启”位置。可能会造成严重的人身伤害。
- 不得站立在工具上。如果工具倾翻或意外触碰到切割工具，则可能造成严重伤害。
- 不得在无人看管的状态下让工具持续运行。操作完毕后，务必关闭电源。在工具未完全停止转动前，请勿离开。
- 请勿使用砂轮或类似研磨材质的锯片。此类锯片会产生过热的磨蚀性碎屑。这不仅可能损坏斜切锯，还存在导致人身伤害的风险。



警告：切割塑料、树液涂层木材和其他材料可能会导致材料融化并堆积在锯齿和锯片主体上，在切割时增加锯片过热和缠绕的风险。



警告：务必佩戴护目镜。平常佩戴的眼睛并非护目镜。如果操作时粉尘较多，请使用防尘面罩。请务必佩戴获得认证的安全设备：

- 符合ANSI Z87.1 (CAN/CSA Z94.3) 标准的眼部防护装备
- 符合ANSI S12.6 (S3.19) 标准的听力防护装备、
- 以及经NIOSH/OSHA/MSHA认证的呼吸防护装备。

警告:由动力砂光、锯切、研磨、钻孔及其他施工活动产生的粉尘,可能含有被加州政府列为会导致癌症、出生缺陷或其他生殖危害的化学物质。部分化学成分如下:

- 铅基涂料中的铅,
- 来自砖和水泥以及其他砖石产品的结晶二氧化硅,
- 经化学处理的木材中的砷和铬。

您暴露在這些化学物质中的风险各不相同,具体取决于您从事此类作业的频率。为减少您在这些化学物质中的暴露程度:请在通风良好的区域作业,请穿戴经过批准的安全设备,例如经特别设计可过滤微小颗粒的防尘面罩。

避免长时间接触由动力砂光、切割、研磨、钻孔和其他施工活动产生的粉尘。请穿戴防护服并用肥皂和水清洗暴露部位。如果让粉尘进入口中或眼中,或落在皮肤上,可能加重对有害化学物质的吸收。

警告:使用这款工具会产生和/或生成粉尘,从而造成严重且持久的呼吸损伤或其他损伤。务必选用经NIOSH或OSHA认证、且适用于特定粉尘暴露环境的呼吸防护设备。让颗粒远离面部和身体。

警告:在使用过程中,请始终佩戴符合ANSI S12.6 (S3.19)标准的个人听力防护装置。在某些情况下以及使用工具时,工具的噪音会造成听力丧失。

- 通风口通常会遮盖转动部件,应注意避免。宽松衣物、珠宝或长发会卡在转动部件中。

工具上的标签可能包含以下符号:以下为其符号及其定义:

V	伏特		或AC.....	交流电
Hz.....	赫兹		或AC/DC	交流或直流电
min	分钟	II类结构	(双重绝缘)
	或DC.....	n ₀	空载转速	
I类结构	n	额定速度	
.../min	每分钟	PSI.....	磅/平方英寸	
BPM	每分钟打击次数		接地端子
IPM	每分钟冲击次数		安全警示符号
OPM	每分钟振荡次数		可见光辐射
RPM.....	每分钟转数			请勿直视光源
sfpm.....	表面英尺/分钟		佩戴呼吸防护装备
SPM.....	每分钟冲程数		请佩戴护目装备
A	安培		佩戴耳罩
W	瓦特		请阅读所有随附文件
Wh.....	瓦时		请勿将工具暴露于雨水中
Ah.....	安时			

为了便捷和安全,斜切锯上贴有以下警告标签。

位于操作手柄上的标签:

为降低伤害风险,用户必须阅读说明书。请佩戴眼部及呼吸防护装置。仅可使用完全相同的替换零件。请勿让工具淋雨,或在潮湿场所使用。

关于挡板:

使用前务必正确调整挡板。切割小料前,须将其夹紧。详情参见说明书。

关于护罩:

危险——请勿靠近锯片。

关于工作台:(两处标识)

警告:请始终让手和身体部位远离锯片的切割路径。一旦触碰到旋转的锯片,将导致严重人身伤害。在所有防护装置未安装到位时,严禁操作斜切锯。操作前,须检查防护系统,确保其功能正常。严禁进行任何徒手切割操作。不得将手伸到锯片后方。移动工件、调整设置或移动手之前,必须先关闭工具,并等待锯片完全停止。不得在锯片前方交叉双臂。每次使用前,务必拧紧所有调节旋钮。更换锯片或进行维护前,必须先切断电源。

关于工作台:(两处标识)



电池类型

这些电池包可用于:

Battery	(kg)
DCB181	0.35
DCB182/DCB204	0.61
DCB183/DCB203	0.40
DCB184/DCB184G/DCB205	0.62
DCB187	0.54
DCB189/DCB240	0.54
DCBP034	0.32
DCBP520	0.75
DCBP320	0.5
DCB2108	0.95

请参阅电池/充电器部分或说明书,了解更多信息。

日期码位置

产品日期码包含一个4位数年码,之后是一个2位数周码,再加上一个2位数出厂码。

壁挂式安装

这些DeWALT充电器被设计为可安装在墙面上,也可以直立在桌面或工作台上。如果安装在墙上,请确保充电器的位置可以连接到电源插座,并且远离墙角或其他可能妨碍空气流通的障碍物。将充电器的背面作为模板,在墙上确定安装螺丝的位置。使用至少1”(25.4毫米)长、螺丝帽直径至少0.28-0.35”(7-9毫米)的石膏板螺丝(单独购买)牢牢固定充电器,将螺丝最大限度地钉入木材,在墙外预留约7/32”(5.5毫米)的长度。将充电器背面的安装槽对准露出的螺丝,同时让螺丝与安装槽完全吻合。

组装和调整

警告:为降低严重的人身伤害风险,在运输、进行任何调整、清洁、维修或拆卸/安装附件或配件之前,请关闭工具并取出电池组。意外启动可能会造成伤害。

注意:您的斜切锯在出厂时已完成全面且精密的调校。若在运输过程中或因其他任何原因需要重新调校,请按以下步骤对调整斜切锯。

调校后,其精度应能长久保持。请现在花些时间,仔细遵循本说明进行操作,以充分发挥斜切锯应有的切割精度。

斜切锯开箱

请核对斜切锯包装箱内的物品,确保所有部件齐全。包装箱内,除本说明书外,还应包含以下物品:

- 1 DCS714斜切锯
 - 1 稳定杆
 - 1 吸尘器接头
 - 1 DeWALT 1英寸(25.4毫米)直径锯片
 - 1 材料夹
 - 1 充电器(仅限套装)
 - 1 电池包(仅限套装)
- 袋内物品:
- 1 集尘袋
 - 1 锯片扳手
 - 1 说明书

规格

切割参数

垂直切割45° 转角(左)与垂直切割45° 转角(右)	切割高度 2.85 英寸(72.5 毫米)
45° 斜切(左)与45° 斜切(右)	切割高度 2.85 英寸(72.5 毫米)
垂直切割0° 转角	切割高度 1.6 英寸(41.9 毫米)
45° 斜切-左侧	切割高度 1 英寸(25.6 毫米)
45° 斜切-右侧	切割高度 1 英寸(25.6 毫米)

本锯适用于切割基脚线。当倚靠挡板进行45°左斜切,并配合45°右斜切进行拼接时,可切割的最大基脚线规格为:厚度0.67英寸(17毫米),高度5.25英寸(133毫米)。

驱动方式

- 20伏电机
- 4900转/分钟
- 可切割斜齿轮和锥齿轮
- 硬质合金锯片
- 自动刹车

部件识别(图A, D)

您购买的斜切锯在包装箱内未完全组装。具体组装步骤,请参见**安装稳定杆**部分的说明。打开包装箱,如图D所示,通过提手**15**将锯取出。

将锯放置在光滑、平坦的表面上,例如工作台或坚固的桌子。

查看图A,熟悉本锯及其各个部件。后续的调整章节将提及这些部件名称。因此,您必须清楚各部分的名称和位置。

小心:当心挤压危险。为降低受伤风险,向下拉动操作手柄时,请始终将拇指置于手柄下方。由于下部护罩会随手柄下压而向上移动,可能产生挤压点。此设计是为进行特殊切割时,使手柄更靠近护罩。

首先,轻轻下压操作手柄**2**,然后拉起锯头锁定旋钮**19**并将其旋转90°。接着,缓慢释放向下的压力,并扶住锯头臂,让其完全升至最高位。如需移动斜切锯,请使用锯头锁定旋钮将其固定。务必使用提手**15**或图A中所示的搬运凹口**11**来搬动斜切锯。

CUTLINE™ LED 工作灯的使用方法(图A)

小心:请勿直视工作灯。可能会让眼部严重受伤。

注意:确保电池已充电,并被安装到斜切锯上。

可通过 CUTLINE™ 专属开关,开启 CUTLINE™ LED 工作灯**21**。若锯片在20秒内未启动,工作灯将自动熄灭。此外,每次按压工具的主变速开关**1**时,工作灯也会自动亮起。

若要沿木板上的铅笔划线进行精确切割:首先,使用 CUTLINE™ 专属开关**21**(而非主变速开关)点亮CUTLINE™工作灯。然后,向下压操作手柄**2**,使锯片靠近木材并对准划线。锯片的阴影会投射在木材上。这条阴影线即代表了实际切割时将被锯片切除的材料部分。要将切割线准确对齐铅笔标记线,请使铅笔线与锯片阴影的边缘对齐。请注意,为与铅笔画线完全吻合,可能需微调斜切或斜角切割角度。

本锯配备有电池监控功能。当电池电量接近耗尽和/或电池温度过高时，CUTLINE™ 工作灯会开始闪烁。请先为电池充电，然后再继续进行切割作业。有关电池充电的说明，请参见“**所有充电器通用安全说明**”文件中的“**电池充电**”章节。

斜切角度控制 (图A)

通过斜切锁定手柄和斜切定位锁，可将锯的斜切角度设定在左右各50°的范围内。调节斜切角度时，首先向上抬起斜切锁定手柄**7**，然后按压斜切定位锁**8**。接着，移动斜切臂，使斜切刻度尺**9**上的指针**26**指向所需角度。最后，向下压紧斜切锁定手柄，将斜切臂锁定在位。

若要解除斜切定位锁，请先解锁斜切定位锁，然后将斜切定位锁开关**27**向上旋转。若要退出越位状态，向下推动斜切定位锁开关即可。

锯台安装 (图A)

斜切锯的四个底脚上均设有安装孔**5**，便于固定于工作台，如图A所示。(为适配不同规格的螺丝，每个底脚提供两个不同尺寸的安装孔。任选一孔使用即可，无需同时使用两个。)务必将锯具牢固地安装在稳定的台面上，以防止其移动。为提升便携性，可先将工具安装在一块1/2英寸(12.7毫米)或更厚的胶合板上。之后，便可将整套装置夹持在工作支架上使用，或轻松搬运至其他工作地点重新夹持固定。

注意:如需将斜切锯安装在胶合板上，请勿让安装螺钉从木板底部伸出。胶合板的位置必须与工作支架齐平。将工具夹紧到任何工作面上时，请仅将安装螺钉孔所在的夹具凸台作为固定点。在任何其它点固定本工具将影响斜切锯的正常运行。

小心:为防止出现夹锯和不精确的情况，请避免使用弯曲或不平的安装面。如果斜切锯在安装面上摇动，请在斜切锯的一个支脚下垫一片较薄的材料，直至斜切锯安装稳固。

安装稳定杆 (图E)

本斜切锯配有一个底座稳定杆**14**。此稳定杆必须在启用斜切锯前安装就位。将稳定杆插入设备背部的孔洞中。然后前后调节稳定杆，直至其抵住工作台面。最后，拧紧底座上的螺丝**48**，以固定稳定杆。

更换或安装新锯片 (图A, F)

警告:为降低严重的人身伤害风险，在运输、进行任何调整、清洁、维修或拆卸/安装附件或配件之前，请关闭工具并取出电池组。意外启动可能会造成伤害。

- 小心:**
- 切勿在锯片上电或滑动时按下主轴锁按钮。
 - 不得使用此斜切锯切割黑色金属(含铁或钢)、砖石或纤维水泥制品。

拆除锯片 (图A, F)

- 从锯上取下电池包**3**。
- 使用锯头锁定旋钮**19**，将锯头锁定在下方位置。
- 按下主轴锁按钮**28**，同时小心地手动旋转锯片，直至锁啮合。
- 用手指拨开锯片螺栓挡板**30**，露出锯片螺栓头**32**。
- 长按主轴锁按钮，并拨开锯片螺栓挡板。然后，用锯片扳手**29**拧松锯片螺栓。(此为左旋螺纹，需顺时针旋转)。取下锯片螺栓。
- 将锯头抬升至最高位置，以取下锯片。为此，先松开锯头锁定旋钮**19**，让锯头缓慢抬起。待锯头完全抬起后，将下部护罩尽量向后旋转，即可触及并取下锯片。

警告:将锯头移至上方位置并旋转下部护罩时，请务必小心。因为在转动锯头时，锯片、锯片适配器以及外压紧垫圈可能会发生移位。

- 然后，即可继续卸下外压紧垫圈和锯片。

安装锯片 (图A, F)

- 从锯上取下电池包**3**。
 - 使用锯头锁定旋钮**19**，将锯头锁定在下方位置。将下部护罩**6**向上推至最高位置。
 - 将锯片**31**装入主轴，然后装上外侧压紧垫圈**49**。务必确保锯片上的箭头方向与护板上的箭头方向一致。
 - 缓慢旋转锯头至下方位置，并使用锯头锁定旋钮将其锁定。
- 警告:**将锯头移至下方位置时请务必小心，因为在转动锯头时，锯片、锯片适配器以及外压紧垫圈可能会发生移位。
- 用手小心地转动锯片，同时按压主轴锁按钮**28**，直至锁定机构啮合。
 - 用手指拨开锯片螺栓挡板**30**，露出锯片螺栓头**32**。
 - 长按主轴锁按钮，并拨开锯片螺栓挡板。然后，用锯片扳手**29**拧紧锯片螺栓。(此为左旋螺纹，需逆时针旋转)。

斜切刻度调节 (图A, G)

松开斜切锁定手柄**7**，然后摆动斜切臂，直至斜切定位卡销**8**将其锁定在0°斜切位置。请勿锁紧斜切锁定手柄。如图所示，靠着挡板和锯片放置一个直角尺。(请勿让直角尺接触到锯齿尖，否则将导致测量结果不准确)。如果锯片未能完全垂直于滑动挡板**12**，请松开固定斜切刻度尺的三颗螺丝**10**，同时向左或向右移动斜切锁定手柄和斜切刻度尺，直至直角尺显示锯片垂直于挡板为止。重新拧紧三颗螺丝。此时，请暂时忽略斜切角度指针的读数。

注意:首先，拧松中央斜切刻度尺螺丝。然后，将斜切定位卡扣设定到0°位置。

斜切角度指针调节 (图A)

松开斜切锁定手柄**7**，将锯臂转动到0°斜切位置。保持斜切锁定手柄处于松开状态。按压斜切定位锁**8**，然后将锯臂旋转至零位后松开该锁，斜切定位卡扣便会自动卡入定位槽。观察图A所示的斜切角度指针**26**与斜切刻度尺**9**。如果指针未精确指向零位，则需拧松指针固定螺丝**24**。扶住指针，将其重新拨回零位，然后拧紧固定螺丝。

斜角垂直度调整 (图A, H, I)

要使锯片与工作台**18**垂直对齐，请先使用锯头锁定旋钮**19**将锁臂锁定在下压位置。将直角尺紧靠锯片。注意，不要将角尺卡在锯齿上。松开斜角锁定旋钮**13**，并确保锯臂紧靠0°斜角切割限位块。根据需要，使用锯片扳手**29**旋转0°斜角调节螺丝**34**，直至锯片与工作台成0°斜角切割状态。

斜切指针调节 (图I)

确保锯身紧靠0°斜角切割限位块**25**，然后拧紧斜角锁定旋钮**13**。如果某个斜角角度指针**35**未指零，请拧松其固定螺丝**36**，然后移动指针至正确位置。务必先校准0°斜角切割角度并设置好指针，然后再调整其他斜角角度调节螺丝。

45°斜角切割限位调整 (图A, I)

注意:请先完成0°斜角角度和斜角角度指针的校准，之后方可调节其他斜角角度。

注意:如需调节斜角止挡，需要先调整挡板。具体操作说明，请参见挡板调整部分的说明。

调节右45°斜角角度时，先旋松斜角锁定旋钮**13**。然后，拉起0°斜角止挡并将其旋转90°(顺时针或逆时针均可)，随后松开，依靠弹簧锁定，即可临时解除0°挡块限制。当锯头完全向右倾斜到位后，检查斜角角度指针。若指针未精确指向45°，请用锯片扳手**29**转动左侧的45°斜角调节螺丝**37**，直至指针准确指向45°。

若要调节左45°斜角止挡，首先旋松斜角锁定旋钮，并将锯头向左侧倾斜。若此时斜角角度指针未精确指向45°，则需转动右侧的45°斜角调节螺丝**37**，直到指针**35**准确指向45°。

将斜角止挡调节至22.5°(或33.9°) (图A, I)

注意:请先完成0°斜角和斜角角度指针的校准，之后方可调节其他斜角角度。

注意:如需调节斜角止挡，需要先调整挡板。具体操作说明，请参见挡板调整部分的说明。

若要设定左侧22.5°斜角角度，请先拔出左侧的22.5°斜角定位块**39**。然后，拧松斜角锁定旋钮**13**，并将锯头向左侧倾斜至最大角度。若斜角角度指针未精确对准22.5°，请使用7/16英寸扳手，调整与定位定位块接触的冠状调节螺丝**38**，直至指针读数为22.5°。

若要调节右侧22.5°斜角角度，请先将右侧的22.5°斜角定位块拔出。拧松斜角锁定旋钮，然后拉出0°斜角止挡并将其旋转90°，以解除该挡块的限位作用。当锯片完全移至最右侧时，检查斜角角度指针。若指针未精确指向22.5°，请用7/16英寸扳手旋转接触棘爪的拱度调节螺丝，直至指针准确指向22.5°。

要调节33.9°挡块，请重复上述步骤，但此次需使用33.9°斜角定位块**43**。

滑动挡板调节 (图A)

为使锯片能进行多角度斜角切割，可能需调整其中一个挡板，以留出足够间隙。如需调节每个挡板，松开挡板调节旋钮**16**并向外滑动挡板。关闭电源，进行空转测试，并检查是否存在干涉。根据实际情况，尽量将挡板调节至靠近锯片的位置，以便在不干扰锯臂上下运动的前提下，为工件提供最大支撑。拧紧挡板调节旋钮完成斜角切割操作后，请勿忘记重新调整挡板位置。

在某些切割操作中，可能需要使挡板更加靠近锯片。如需使用此功能，请先将挡板调节旋钮旋出两圈；再将两侧挡板向锯片方向移动，使其超出正常限位。最后，拧紧挡板调节旋钮，将挡板固定在此位置。首先进行一次空转测试，确保锯片不会与挡板接触。

注意:挡板轨道会因为被堆积的锯末阻塞。若发现导轨槽有碎屑堆积，可使用刷子或低压气源进行清理。

护罩操作与能见度 (图A, X)

小心:当心挤压危险。为降低受伤风险，向下拉动操作手柄时，请始终将拇指置于手柄下方。由于下部护罩会随手柄下压而向上移动，可能产生挤压点。

斜切锯上的下部护罩**6**采用自动式设计。当按下锯臂，护罩会自动收回，露出锯片；抬起锯臂，护罩会自动闭合，罩住锯片。

在安装或拆卸锯片、或检查该电锯时，可手动升起护罩。切勿在锯片未停止时手动升起下部护罩。

注意:进行某些特殊的大尺寸材料切割时，需要您手动抬起护罩。具体方法请参见**特殊切割**部分的大尺寸材料切割部分。

护罩前部设有百叶窗式开口，以便在切割时观察。尽管百叶窗能极大减少碎屑飞溅，但它毕竟是护罩上的开口。因此，只要通过此开口观察，就必须全程佩戴安全眼镜。

斜切锁调节 (图A, J)

若斜切锁定手柄**7**处于锁定(向下)位置时，斜切锯的工作台仍可移动，则应调整斜切锁定杆**40**。调整斜切锁定装置**41**时，首先将斜切锁定手柄置于解锁(向上)位置。使用一字螺丝刀微调锁定杆，每次顺时针旋转1/8圈，逐步增加锁紧力。为确保斜切锁定功能正常，请将斜切锁定手柄重新锁定在一个非定位斜切角度(例如34°)，并确认工作台不会转动。

运输斜切锯 (图A)

警告:为降低严重的人身伤害风险，在运输、进行任何调整、清洁、维修或拆卸/安装附件或配件之前，请关闭工具并取出电池组。意外启动可能会造成伤害。

警告:为降低严重人身伤害的风险，在搬动斜切锯前，务必锁紧以下部件：斜切锁定手柄**7**、斜角锁定旋钮**13**、锯头锁定旋钮**19**以及挡板调节旋钮**16**。

为便于搬运斜切锯，锯臂顶部设有一个提手**15**，底座上还有搬运凹口**11**。

锯头锁定旋钮 (图A)

警告:仅在搬运或存放斜切锯时，才可使用锯头锁定旋钮。不得在任何切割操作中使用锯头锁定旋钮。

若要锯头锁定在下位，请先向下按压锯头，然后旋转锯头锁定旋钮**19**90°，其内置的弹簧销即会锁定。这样可将锯头安全地固定在下方位置，便于移动工具。

如需解锁，请先向下轻压锯头，然后拉出锯头锁定旋钮并旋转90°。操作时，需防止锯头失控弹回。

功能与控件

警告:为降低严重的人身伤害风险,在运输、进行任何调整、清洁、维修或拆卸/安装附件或配件之前,请关闭工具并取出电池组。意外启动可能会造成伤害。

斜切锁定旋钮(图A)

通过斜角锁定旋钮**13**,可将锯头向左或向右倾斜至49°进行斜角切割。如需调节斜角角度,逆时针旋转该旋钮即可。当0°斜角止挡**25**处于越位状态时,锯头即可轻松向左或向右倾斜。如需拧紧,顺时针转动斜角锁定旋钮即可。

0°斜切调节旋钮(图A)

斜角止挡解锁功能,使锯片能够向右斜切并越过0°标记。

当启用该功能,若锯片从左向右抬升,将在0°位置自动停止。若要向右越过0°进行斜切,请按以下步骤操作:拉起0°斜角止挡**25**,将其旋转90°(顺时针或逆时针均可),然后松手,弹簧销会锁定在位。

若要将斜角复位至0°止挡位置,请按以下步骤操作:拉起0°斜角止挡,将其旋转90°(顺时针或逆时针均可),然后松手,弹簧销将锁定在位。

45°斜切止挡调节旋钮(图I)

锯身两侧各有一个斜角止挡解锁滑块**42**。如需进行大于45°的左右斜角切割,请先旋松45°斜角止挡螺丝**49**,然后将45°斜角止挡滑块向后推。重新旋紧45°斜角止挡螺丝。当滑块处于靠后位置时,锯头可超越常规止挡进行更大角度的斜角切割。若需恢复45°止挡功能,请旋松45°斜角止挡螺丝,并向前推回滑块。重新旋紧45°斜角止挡螺丝。

快速斜切角度定位块(图I)

在平切拱度饰条时,本锯配备的定位装置可快速、精确地设定左/右向拱度限位。具体操作方法,请参见**拱度饰条平切与复合功能使用说明**。可旋转拱度斜角定位块**43**,使其接触拱度调节螺丝**38**。本锯的出厂设置适用于北美地区典型的拱度切割(52°/38°)。但也可进行调整,用于切割非标准(45°/45°)拱度。若要调整拱度斜角定位块,请先卸下固定螺丝、22.5°斜角定位定位块以及33.9°拱度斜角定位块。翻转拱度斜角定位定位块,使标有30°△的一面朝上。重新装回螺丝,以固定22.5°斜角定位块和拱度斜角定位块。该操作不会影响原有精度设置。

22.5°斜切角度定位块(图I)

本锯可快速、精确地设定22.5°斜角,包括向左或向右。可旋转22.5°斜角定位块**39**,使其接触拱度调节螺丝。

自动电动刹车

本斜切锯配备有自动电动锯片刹车。该刹车能在触发开关释放后的5秒内,使锯片停止转动。此刹车功能不可调节。

在某些情况下,触发开关释放后,刹车啮合可能会出现短暂延迟。在极少数情况下,刹车可能完全无法啮合。此时,锯片将依惯性转动直至完全停止。

若出现延迟或“跳齿”现象,请将锯的电源开关重复切换4至5次。若此状况持续存在,请将工具送至授权的DeWalt服务中心进行检修。

务必确认锯片已完全停转,然后方可将其从切口中移出。刹车并不可替代下部护罩等防护装置。操作时,您仍需全神贯注,确保自身安全。

警告:始终佩戴护目镜。所有操作者及旁观者都必须佩戴眼部防护装置,该装置需符合ANSI Z87.1或CAN/CSA Z94.3标准。

警告:为确保锯片路径无任何障碍,在工件上进行任何实际切割前,务必先进行一次空载试运行。

在工具上安装和拆除电池包(图A)

警告:在安装电池包前,请确保工具处于关机状态。

注意:如需获得最佳效果,请确保电池包充电完成。

安装电池包**3**时,请将其与工具手柄内部的轨道对准。然后沿轨道滑入电池包,直至其完全卡入到位且不会松动。

按下释放按钮**4**,然后将电池包从工具中稳稳拉出。按本手册充电器部分所述,将电池包插入充电器中。

正确的身体和双手放置位置(图K)

警告:为降低严重人身伤害的风险,请务必如图所示,将双手放在正确位置。

警告:为降低严重人身伤害的风险,请务必紧握工具以防止意外事件。

操作斜切锯时,让身体和双手始终处于正确位置,可使切割操作更省力、更精确、更安全。不得将手靠近切割区域。手应与锯片保持至少4英寸(100毫米)的距离。切割时,请将工件固定在锯台和挡板上。让双手始终位于正确位置,直至触发开关完全松开且锯片彻底停转。进行最终切割前,务必先进行空载试切(不接通电源),以检查锯片的预定切割路径是否准确。操作时,双臂不得交叉,具体正确姿势如图K所示。

双脚需稳固站立于地面,并始终保持身体平衡。在左右移动斜切臂时,您的身体也应随之移动,并始终站立在锯片的侧方位置。沿铅笔画线切割时,请透过护罩上的通风孔观察切割情况。

触发开关(图L)

若要开启工具,请向左推动锁定杆**33**,然后按下触发开关**1**。按下开关后,电锯将运行。切割前,先让锯片全速运行。如需关闭工具,请松开开关。先等锯片停止转动,再抬起锯头。不得将开关锁定在开启位置。触发开关上有一个孔洞**44**,可插入挂锁,将开关锁定在关闭位置。务必确认锯片已完全停转,然后方可将其从切口中移出。

除尘(图M)

小心:除非已将集尘袋或DeWalt集尘桶安装到位,否则不得操作该设备。木屑粉尘可能会造成呼吸危害。

本斜切锯配备内置除尘口,可连接与Airlock™兼容的集尘系统。若使用非Airlock集尘系统,则需配备随附的吸尘器转接头。

我们推荐的最佳解决方案包含以下组件:

- 真空吸尘器(DXV14P)
- 分离器(DXVCS003)
- 2.5英寸 x 7英尺软管(DXVA19-2501)
- 吸尘器转接头:适用于DXV系列吸尘器及其他与非Airlock系统不兼容的吸尘器。

安装集尘袋(图N)

1. 如图N所示,将集尘袋**45**套在除尘口**17**上。

清空集尘袋(图N)

1. 取下集尘袋**45**,然后轻轻抖动或拍打集尘袋,以清空灰尘。
2. 将集尘袋重新装回除尘口**17**。

您可能注意到,粉尘不会自动从集尘袋中掉落。虽然这不会影响切割效果,但会降低电锯除尘的效率。为恢复除尘效率,请在清空集尘袋时,按下袋内的弹簧并将集尘袋轻拍垃圾桶的边缘。

贯通切割操作(图A)

注意:虽然本斜切锯适用于切割木材及多种有色金属材料,但本手册仅限于介绍木材切割。切割其他材料时,可遵循相同的基本准则。严禁使用本锯切割黑色金属(如铁和钢)或砖石、混凝土等材料。请勿使用任何研磨类锯片。

注意:开始切割前,请务必参见**调整**章节中关于下部护罩的**护罩操作与可见性**部分,以了解重要信息。

横切(图A, O)

横切是指以任意角度横向切断木材纹理的切割操作。进行直线横切时,需将斜切臂设定在0°位置。将转角臂设置并锁定在0°位置,将木材牢固地抵住锯台和挡板。请按压触发开关**1**,以启动斜切锯,如图A所示。

待锯片全速转动(约需2秒)后,平稳且缓慢地下压锯臂,切入木材。升高锯臂前,请确保锯片已完全停转。

不建议同时切割多个工件,但在确保各工件均被紧固在锯台和挡板上后,可通过安全的方式进行此操作。

注意:为在缩短锯切行程的同时提供更大的横切能力,DCS714锯片会更深入地嵌入工作台。因此,在切割时,工件可能会受到较大的上抬力。

小心:在操作中,如需将手伸到距离锯片4英寸(100毫米)的范围内,务必使用工件夹固定工件。这旨在保持对工件的控制,并降低工件损坏及人身伤害的风险。

斜切横切是指斜切臂设定在非0°下进行的切割操作。该角度通常设为45°,用于制作角接头。但实际可在0°至左向50°至右向50°的范围内任意设定。按上述方法进行切割。

对宽度超过2x6尺寸且长度较短的工件进行斜切时,务必使工件较长的一侧紧靠滑动挡板**12**(图O)

若要沿木材上的铅笔画线切割,应尽可能将锯片角度与线条精确对准。可先将木料切割得稍长一些,然后测量铅笔画线到切割边的距离,据此判断调整斜切角度的方向,并进行修整切割。此法需多加练习,但是一种常用技巧。

斜角切割(图A)

斜角切割是一种使锯片相对于木材倾斜一定角度后进行的横切。为设定斜角,需先松开斜角锁**13**,然后根据需要,向左或向右移动锯头。(请务必移动挡板以制造空隙。)设定好所需的斜角后,请拧紧斜角锁定旋钮。关于斜角调节系统的详细操作说明,请参见**控制**部分。

斜角设定范围为右49°至左49°。在此角度范围内,可在斜切臂设定于左50°至右50°的位置上进行切割。在某些极端斜角下,即使完全移出右侧或左侧挡板,其在切割过程中仍可能干扰锯头的运动。遇此情况,可临时拆下会产生干扰的挡板,以便完成切割。拆卸挡板时,将挡板调节旋钮**16**逆时针旋松数圈,然后将挡板从轨道中完全滑出。另一侧的挡板必须保留在工作台上,并定位在可支撑工件的位置。在正式切割前,请进行空载试运行,以确保工件支撑稳固且锯头运动顺畅。切割完成后,请立即重新安装挡板。

注意:有关针对特定斜切操作调节挡板的重要信息,请参见**调节**部分的**挡板调节**。

切割质量

任何切割所能达到的光滑度,取决于多种因素。例如,被切割材料、锯片类型、锯片锋利度以及切割速度,均会对切割质量产生影响。

当需要最平滑的切割质量来制模或进行其它精密工作时,请采用锋利(60 齿硬质合金)锯片,并采用慢速、均匀的切割速度,以达到目标效果。

请确保材料不会在切割过程中发生移动;请将其牢固固定。升高锯臂前,请始终确保锯片已完全停止。

如果较小的木材纤维仍在工件后部裂开,请在木材需要切割的位置贴上遮蔽胶带。从胶带处锯切,并在完成后小心地去除胶带。

针对不同的切割需求,请参见斜切锯的推荐锯片列表,并选择最符合您需求的一款。具体信息请参见**配件**部分的**锯片**部分。

夹住工件(图A)

警告:为降低严重的人身伤害风险,在运输、进行任何调整、清洁、维修或拆卸/安装附件或配件之前,请关闭工具并取出电池组。意外启动可能会造成伤害。



警告:在切割前夹住、平衡并紧固的工件可能会在完成切割后失去平衡。失去平衡的负荷会让电锯或任何固定电锯的物件，例如锯台或工作台，倾翻。如果切割可能会导致失衡，就要为工件提供适当支撑并用螺钉将电锯固定在稳定的台面上。否则，可能会造成人身伤害。



警告:在使用夹子时，夹脚必须夹在电锯底座上方的位置。务必将工件夹在电锯底座上——而非工作区域的任何其他地方。



小心:务必使用工件夹控制工件，降低引发人身伤害和工件损坏的风险。

若无法用手将工件稳定固定于工作台并紧靠挡板（例如，工件形状不规则），或手与锯片的距离小于4英寸（100毫米），则必须使用夹具或其他固定装置。

为获得最佳效果，请使用随锯提供的垂直材料夹**22**。如需额外夹具，可从当地经销商或DeWALT服务中心购买。

其他辅助，例如弹簧夹、棒夹或C形夹适合某些尺寸和形状的材料。请谨慎选择并安放这些夹具。切割前，请务必进行空载试操作。左侧挡板能来回滑动，协助夹住工件。

安装夹子 (图A)

1. 将夹具立柱插入滑动挡板**12**后方的孔中。
2. 如需向上调节夹具，逆时针旋转该旋钮即可。然后，顺时针旋转旋钮，将夹具向下锁紧。确保工件已被牢牢夹紧。

注意:在斜切时，将夹子放在底座的对侧。务必先演练（不通电），再进行实际切割，以便检查锯片路径是否正确。请确保夹子不会干扰电锯或护罩的运行。

为较长工件提供支撑



警告:为降低严重的人身伤害风险，在运输、进行任何调整、清洁、维修或拆卸/安装附件或配件之前，请关闭工具并取出电池组。意外启动可能会造成伤害。

请务必为长材料提供支撑。

不得让他人代替工作台的延伸部分。无论是用于支撑长于或宽于斜切锯基本工作台的工件，还是协助推进、支撑或回拉工件，都不得让他人提供额外辅助。

用锯木架或类似支撑物稳定长工件，防止端部下垂，确保加工安全。

切割相框、暗箱及其它四边物体 (图P)

为更好地掌握本说明所列项目的制作方法，建议您先用边角料尝试一些简单操作，直至熟练掌握工具为止。

本工具是制作斜切角的理想工具，如图P所示。草图1展示了一种接合方式：使用斜角调整功能，将两块木板的边缘各以45°斜角切割，从而拼合成一个90°角。对于该接头，斜切臂锁定在0°，斜角调节锁定在45°。将木材的宽面一面紧贴台面，窄面紧靠挡板。通过将宽面紧靠挡板并分别向右和向左进行斜切，也能完成此切割。

切割收边线和其他框架 (图P)

图P中的草图2显示的接头是将斜切臂设定为45°，对两块板进行垂直切割，从而形成90°拐角。如需制作此类接头，请将斜切调整设定在零位置，同时将转角臂设定为45°。再次将木料的宽面放在锯台上，窄面紧靠滑动挡板。

图P中的两张草图均仅适用于四边物体。

边数更改后，转角和斜切角度也随之改变。下表提供了多种形状所需的正确角度。

- 示例 -

边数	斜切或斜角角度
4	45°
5	36°
6	30°
7	25.7°
8	22.5°
9	20°
10	18°

图表假设所有边的长度相等。对于未出现在本图表中的形状，请使用下列公式：用180°除以边数，即等于转角（如垂直切割材料）或斜切角度（如水平切割材料）。

切割复合转角 (图Q)

复合斜切是一种需同时设定斜切角度和斜角角度的切割。这种切割方式常用于制作带有倾斜侧边的框体或箱体，如图Q所示。



注意:如果每次切割的角度不一致，请检查斜角锁定旋钮和斜切锁定手柄是否已牢固锁紧。在调整斜角或斜切角度后，必须将这两个锁定装置锁紧。

下列图表将帮助您为一般的复合转角切割操作选择正确的斜切和转角设置。

- 为您的物体选择想要的角度A (图Q, 角A + 外角 = 90°)，并在图表中找到与该角度对应的弧度。
- 从该点沿图表垂直向下找到正确的斜切角度，水平向两侧找到正确的转角角度。
- 将电锯设定到指定角度并进行试切。练习将切割件拼接起来。

示例:要制作一个外角为65° (图Q中的角A) 的四边盒子，25° (角A) = 90° - 65° (外角)，使用右上方弧线。在弧线刻度上找到25°。沿相交的水平线向左或向右，可得到电锯上应设置的转角角度 (23°)。同样，沿相交的竖直线向上或向下，可得到电锯上应设置的斜切角度 (40°)。请务必先用几块废木料试切，以验证电锯的设置。

切割踢脚线 (图R)

进行任何切割前，务必先空转一次（不通电），模拟整个切割过程。

90°直角切割 (图S)

如图R所示，将木材紧靠挡板放置。启动斜切锯，待锯片全速转动后，平稳下压锯臂以完成切割。

高度3.25英寸 (82毫米) 以内的踢脚线倚靠挡板垂直切割 (图R)

如图R所示，放置踢脚线。

所有切割中，镶边背面需紧贴挡板，底部需紧贴底座。

	内角	外角
左侧	1. 垂直切割45°转角 (左) 2. 保留左侧切割部分	1. 垂直切割45°转角 (右) 2. 保留左侧切割部分
右侧	1. 垂直切割45°转角 (右) 2. 保留右侧切割部分	1. 垂直切割45°转角 (左) 2. 保留右侧切割部分

对于宽度在3.25英寸 (82毫米) 以内的材料，可按上述方法进行切割。若要切割更宽的板材 [最大5.25英寸 (133毫米)]，则需进行几项微调。

当切割宽度介于3.25英寸 (82毫米) 与5.25英寸 (133毫米) 之间的板材时，下部护罩端头的滚轮可能会卡在工件上。若发生此情况，只需将右手拇指放在下部护罩上侧，并向上滚动护罩，使其刚好越过工件即可，如图A, X所示。待护罩越过工件后，即可松开，其将在切割过程中继续自动张开。

如图S所示，当对高度超过3.25英寸 (82毫米) 并垂直靠紧挡板的底座线脚进行右侧斜切时，锯片仅能切入板材末端3/4英寸 (19毫米) 的深度。若试图切入超过3/4英寸 (19毫米)，锯的机匣会与工件发生干涉。若要垂直切割宽度在3.25英寸 (82毫米) 至5.25英寸 (133毫米) 之间的底座线脚，请遵循以下方法。

垂直靠紧挡板切割3.25–5.25英寸 (82–133毫米) 底座线脚 (图R)

如图R所示，放置踢脚线。

所有切割操作均需将踢脚线背面紧贴挡板进行。

	内角	外角
左侧*	1. 定位时，应将踢脚线底面紧贴斜切锯底座。 2. 垂直切割45°转角 (左) 3. 保留左侧切割部分	1. 定位时，应将踢脚线底面紧贴斜切锯底座。 2. 垂直切割45°转角 (右) 3. 保留左侧切割部分
右侧	1. 定位时，应将踢脚线顶面紧贴斜切锯底座。 2. 垂直切割45°转角 (左) 3. 保留左侧切割部分	1. 定位时，应将踢脚线底面紧贴斜切锯底座。 2. 垂直切割45°转角 (左) 3. 保留右侧切割部分

* **注意:**若切割点需在距踢脚线端头3/4英寸 (19毫米) 以外的位置：请先以90°斜切截断踢脚线，预留长度应比最终尺寸长约3/4英寸 (19毫米)。随后，再按上述方法进行斜切。

另一种切割方法是进行0°斜切、45°斜角切割。本锯可进行宽度为6英寸 (153毫米) 的斜角切割。

踢脚线平切与斜角功能应用

所有切割均需将斜切锯设定为45°斜角和0°斜切。

所有切割均需将踢脚线背面平放于工作台上进行。

在执行以下任何切割操作前，请先将左侧或右侧挡板移离锯片路径。

让踢脚线顶部紧贴挡板。

	内角	外角
左侧	1. 45° 斜切 (左) 2. 保留左侧切割部分	1. 45° 斜切 (右) 2. 保留左侧切割部分
右侧	1. 45° 斜切 (右) 2. 保留右侧切割部分	1. 45° 斜切 (左) 2. 保留右侧切割部分

切割拱度踢脚线

您的斜切锯非常适合切割拱度踢脚线，其适用性优于其他任何工具。为确保妥善安装，必须对拱度踢脚线进行高精度的复合斜切。

每段拱度踢脚线的两个平面之间存在特定角度。这两个角度相加，总和正好为90°。大多数（并非全部）拱度踢脚线的上后角（贴合天花板的部位）为52°，下后角（贴合墙面的部位）为38°。您的斜切锯设有特殊的预设定位点：左右31.6°斜切定位点，用于精确切割拱度踢脚线；以及左右33.9°斜角止挡定位块。此外，斜角刻度尺上在33.9°处也设有标记。

下方图表提供了切割拱度踢脚线的正确设置参数。（斜切与斜角的设置数值非常精确，在锯上可能难以完全准确设定。）由于大多数房间的墙角并非精准的90°，因此，无论如何您都可能需要进行微调设置。

请务必先用废木料试切，这非常重要！

拱度踢脚线平切与复合功能使用说明 (图A, S)

1. 将踢脚线宽大的背面朝下，平放于斜切锯的工作台上**18**。
2. 踢脚线的顶部应紧贴滑动挡板**12**。
3. 以下设置适用于所有具有52°和38°角度的标准（美制）拱度踢脚线。

	内角	外角
左侧	1. 33.9° 斜切 (左)	1. 33.9° 斜切 (右)
	2. 转角锯台设置为 31.62° (右)	2. 转角锯台设置为 31.62° (左)
	3. 保留左侧切割部分	3. 保留左侧切割部分
右侧	1. 斜角右 33.9°	1. 斜角左 33.9°
	2. 转角锯台设置为 31.62° (左)	2. 转角锯台设置为 31.62° (右)
	3. 保留右侧切割部分	3. 保留右侧切割部分

4. 以下设置适用于所有具有 45° 和 45° 角度的标准 (美制) 拱度踢脚线。

	内角	外角
左侧	1. 30° 斜切 (左)	1. 30° 斜切 (右)
	2. 转角锯台设置为 35.3° (右)	2. 转角锯台设置为 35.3° (左)
	3. 保留左侧切割部分	3. 保留左侧切割部分
右侧	1. 30° 斜切 (右)	1. 30° 斜切 (左)
	2. 转角锯台设置为 35.3° (左)	2. 转角锯台设置为 35.3° (右)
	3. 保留右侧切割部分	3. 保留右侧切割部分

在为所有复合斜切设置斜角与斜切角度时, 请注意:

针对拱度踢脚线所标示的角度非常精确, 难以完全精准设定。由于角度易发生轻微偏移, 且房间的角落极少为标准直角, 因此要用踢脚线废料测试所有设定。

请务必先用废木料试切, 这非常重要!

切割拱度踢脚线的替代方法 (图 T)

如图 T 所示, 将踢脚线以一定角度放置在滑动挡板 **12** 与斜切锯工作台 **18** 之间。强烈建议使用拱度踢脚线专用挡板配件 (DW7084), 该配件可确保精度, 操作便捷。此拱度踢脚线挡板配件可向本地经销商购买。

采用此法切割拱度踢脚线的优势在于, 无需进行斜角切割。微调斜切角度不会影响斜角角度。因此, 当遇到非 90° 的转角时, 可快速轻松地调整锯以适应角度。使用拱度踢脚线挡板配件, 可保持踢脚线在墙上安装时的角度。

所有切割均使踢脚线在挡板与锯底座间成角度的切割说明

- 将踢脚线的角度设定为, 使其底部 (安装时紧贴墙面的部分) 紧贴挡板, 顶部置于斜切锯工作台上, 如图 T 所示。
- 踢脚线背部带角度的“平面”必须完全接触斜切锯的靠山和台面。

	内角	外角
左侧	1. 45° 斜切 (右)	1. 斜角 45° 斜切 (左)
	2. 保留右侧切割部分	2. 保留右侧切割部分
右侧	1. 45° 斜切 (左)	1. 45° 斜切 (右)
	2. 保留左侧切割部分	2. 保留左侧切割部分

特殊切割操作

请务必先将工件牢固固定于工作台并紧靠挡板, 方可进行任何切割。

铝材切割 (图 A, U)

务必使用专为切割铝材而设计的专用锯片。您可在当地的 DeWALT 零售商或得伟服务中心购买此类锯片。某些工件可能因其尺寸、形状或表面处理方式, 需使用夹钳或夹具来固定, 防止切割时发生移动。如图 U 所示, 妥善摆放材料, 以便切割其最薄的横截面。图 U 也展示了这些型材的错误切割方法。

切割铝材时, 请使用固态蜡切削润滑剂。切割前, 请将固态蜡直接涂抹在锯片 **31** 上。不得在锯片运转时使用固态蜡。

您可从多数五金店或工业用品供应商买到。此蜡具有良好的润滑作用, 并可防止碎屑粘附在锯片上。

务必妥善固定工件。

关于适用锯片的规格, 请参见“配件”章节下的“锯片”部分。

弓形材料 (图 V, W)

请务必按照图 V 所示放置材料, 不得如图 W 所示那样放置。若错误放置材料, 会在切割接近完成时导致材料挤压锯片。

塑料管或其它圆形材料切割

使用本工具可轻松切割塑料管。其切割方式与木材相同, **且应在切割时, 将材料夹紧或固定到滑动挡板上, 防止滚动。**此操作在进行变向切入时尤为重要。

大型材料切割 (图 A, X)

有时, 您会遇到木料尺寸略大, 无法完全纳入下部护罩 **6** 下方的情况。若发生此情况, 只需将右手拇指放在下部护罩上侧, 并向上滚动护罩, 使其刚好越过工件即可, 如图 A, X 所示。请尽量避免此种操作。但若确有必要, 斜切锯仍可正常工作并完成切割。不得在操作本斜切锯时, 以捆绑、粘贴或其他任何方式让护罩保持打开状态。

维护

警告: 为降低严重的人身伤害风险, 在运输、进行任何调整、清洁、维修或拆卸/安装附件或配件之前, 请关闭工具并取出电池组。意外启动可能会造成伤害。

警告: 为降低严重人身伤害的风险, 请勿在进行任何维护时用手指或双手接触锯片的锋利齿尖。

请勿在塑料护罩附近使用润滑剂或清洁剂 (特别是喷雾或气雾剂)。护罩使用的聚碳酸酯材料易受到特定化学制品的腐蚀。

- 所有轴承均已密封。其采用润滑脂长效润滑, 无需额外维护。
- 请定期清除底座和转台四周及下方的所有粉尘和木屑。尽管设备设有供碎屑通过的槽口, 但仍会有部分粉尘积聚。

清洁

警告: 使用清洁干燥的压缩空气吹净所有通风孔中的灰尘, 每周至少一次为最大限度地降低眼部受伤风险, 执行此操作时, 请务必佩戴符合 ANSI Z87.1 标准的护眼装置。

警告: 切勿使用溶剂或其它刺激性化学制品来清洁工具的非金属部件。这些化学品可能削弱此类部件中使用的塑料材料。只可使用蘸有软性肥皂水的抹布进行清洁。切勿使任何液体进入工具; 切勿将工具的任何部分浸入液体中。

工作灯清洁

为保持工作灯的最佳性能, 请定期进行以下维护。

- 请使用棉签小心地清除工作灯镜片上的锯屑和碎片。
- 不得使用任何类型的溶剂, 它们可能对镜片造成损坏。
- 堆积的尘屑可阻塞工作灯, 妨碍其准确指示切割线。
- 请遵照斜切锯说明书中的指引来拆卸和安装锯片。
- 从斜切锯拆下锯片, 清除锯片上的残留物和堆积的尘屑。树脂和碎屑会干扰工作灯, 影响切割线指示的准确性。

规格	
光源	电源 LED
工作灯	6 V DC
操作温度	-40 °F 到 221 °F (-40 °C 到 105 °C)
存放温度	-40 °F 到 221 °F (-40 °C 到 105 °C)
环境适应性	防水

清洁除尘口

切割环境不同, 产生的锯屑可能堵塞除尘管。这会导致锯屑无法从切割区域顺利排出。清洁时, 需先断开电源, 并完全抬起锯头。随后, 可使用低压空气或大直径圆木棒, 清除除尘管中的灰尘。

附件

警告: 除了 DeWALT 提供的附件之外, 其他附件都未经此产品兼容性测试, 若将此类附件与本工具一起使用将存在安全隐患。为降低人身伤害风险, 本产品只可使用 DeWALT 推荐的附件。

可选配件

以下专为您设计的斜切锯设计的配件可能会有所帮助。请谨慎选择并使用配件。

集尘袋: DW7053

集尘袋配有拉链, 便于清空, 可收集切割产生的大部分锯末。

拱度踢脚线挡板: DW7084

用于对拱度踢脚线进行精准切割。

锯片

务必使用 10 英寸 (254 毫米) 锯片。锯片额定转速不得低于 4900 RPM。不得使用直径更小的锯片。否则, 锯片将无法得到下部护罩的有效防护。仅使用横切锯片! 请勿使用为纵切设计的锯片、组合锯片或钩角超过 7° 的锯片。

锯片说明		
应用	直径	锯齿
建筑用锯片 (最大薄开槽带防粘边缘)		
通用	10 英寸 (254 毫米)	32/40
精细横切	10 英寸 (254 毫米)	60
木工用锯片 (提供平整、洁净的切割效果)		
精细横切	10 英寸 (254 毫米)	80
有色金属	10 英寸 (254 毫米)	80
注意: 切割有色金属时, 请务必选用专门设计的、带 TCG 齿形的锯片。		

保护环境



产品/电池可回收利用,但若标有打叉垃圾桶的图标,则禁止将其随普通生活垃圾一起丢弃。

请将电池电量耗尽后拆卸下来,同时尽可能将任何可拆卸的光源部件与产品主体分离。用户需自行清除产品内的个人数据。随后,请将废弃物送往指定回收点或合作零售点,通常可免费处理。包装材料应根据材质代码分类弃置。只可在产品报废后,才可丢弃操作指南和安全说明书。

废弃物处理细则请查阅当地社区/城市管理规定。

如需获得更多信息,请访问www.2helpU.com。

售后服务和维修

DEWALT维修中心拥有经过培训的人员,能够为顾客提供高效、可靠的产品服务。如果您通过未获授权的维修中心进行维修,我们不会承担任何责任。您可以参见产品包装中的“联系中心定位器”宣传单页,通过热线电话、网站或社交媒体联系我们,找到距离您最近的DEWALT服务中心。

问题解决指南

请确保遵守安全规则和说明

问题故障!	什么问题?	解决方案
工具无法启动	未安装电池包	请安装电池包参见 安装和拆除电池包 。
	电池包未充电	为电池包充电。参见 为电池包充电 。
	斜切锯过热	请等待几分钟,待斜切锯冷却。
	电池过热	请等待几分钟,待电池包冷却。
切割效果不佳	锯片钝化	更换锯片参见 更换或安装新锯片 。
	锯片安装方向错误。	请调转锯片的安装方向。参见 更换或安装新锯片 。
	锯片上粘有树胶或树脂。	卸下锯片,使用粗钢绒配合松节油,或家用烤箱清洁剂进行清理。
	所用锯片与当前作业不匹配。	更换锯片类型。参见 可选配件 部分的 锯片 相关内容。
CUTLINE 工作灯闪烁。	电池包未充电	为电池包充电。参见 为电池包充电 。
斜切锯振动过大	斜切锯未被牢固安装到支架或工作台上	拧紧所有安装五金件。请参见 工作台安装 部分。
	支架或工作台所处地面不平整	将其重新放置于平坦的水平面上。请参见 熟悉设备 部分。
	锯片损坏	更换锯片参见 更换或安装新锯片 。
无法进行精准斜切	未正确调整斜切刻度尺	检查并调整。请参见 安装与调整 中的 斜切刻度尺调整 说明。
	锯片与挡板不成直角	检查并调整。请参见 安装与调整 中的 斜切刻度尺调整 说明。
	锯片与工作台不垂直	检查并调整挡板。请参见 安装与调整 中的 斜角直角调整 说明。
	工件移动	将工件牢固地夹紧在挡板上,或使用橡胶胶水将120目砂纸粘贴在挡板表面。
	工作台盖板磨损或损坏	请送到授权服务中心。
	未正确调整斜切指针	检查并调整。请参见 安装与调整 中的 斜切指针调整 说明。
材料夹住锯片	切割弯曲材料	具体方法请参见 特殊切割 部分的 弯曲材料切割 部分。

表1:复合斜切
(将宽扁的木料放在锯台上,窄边靠着挡板)

