

DEWALT®

English (*original instructions*)

2

简体中文

7



www.DEWALT.com

DCF510
DCF512
DCF512E
DCF513
DCF513E

Fig. A

图 A

DCF510

DCF512, DCF513, DCF512E, DCF513E

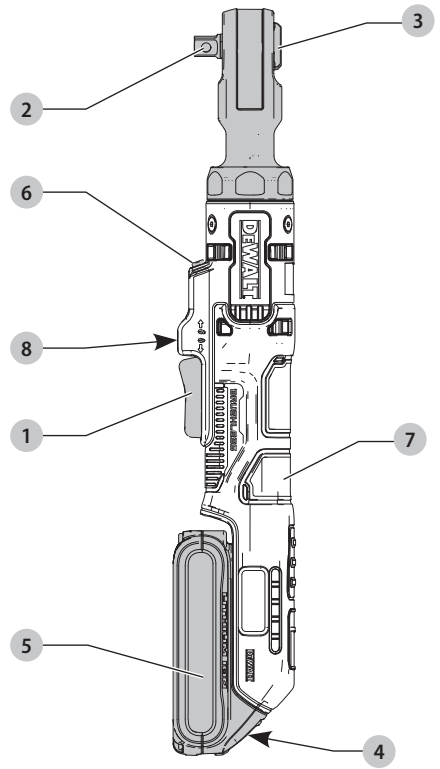
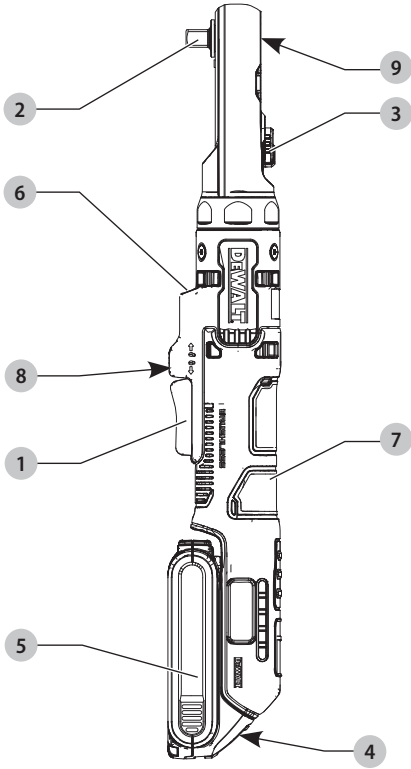

Fig. B

图 B

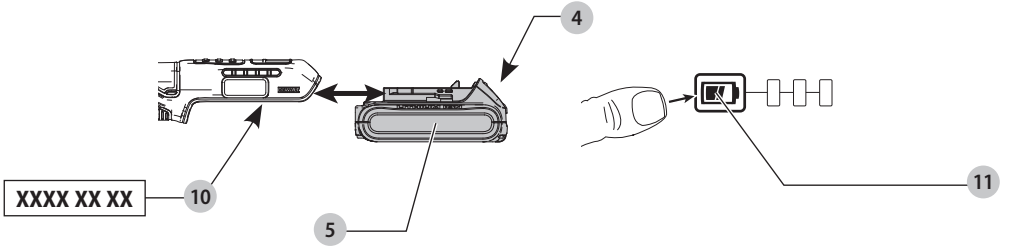

Fig. C
图 C

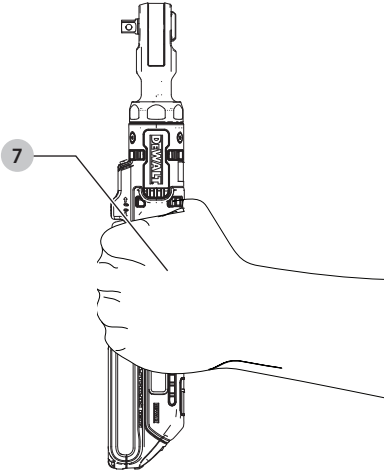

Fig. D
图 D

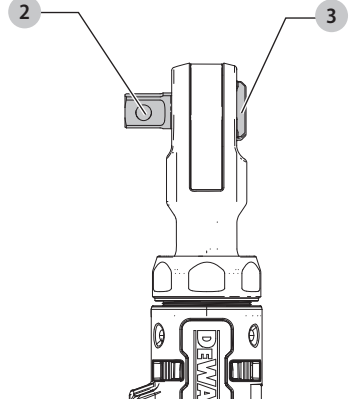
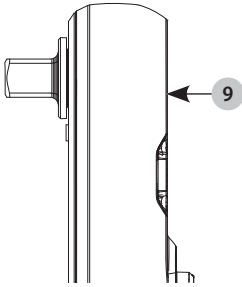

Fig. E
图 E



DCF510

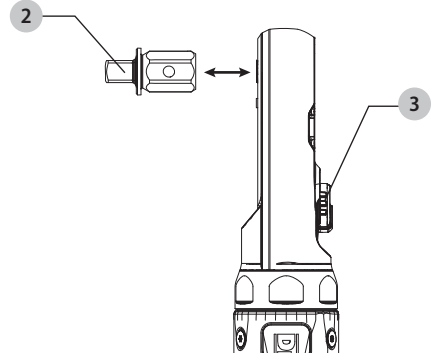
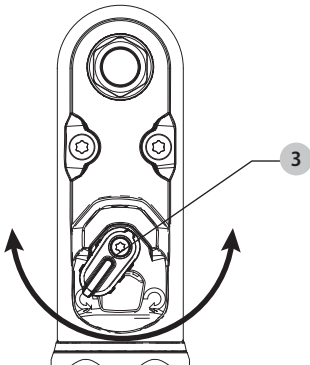
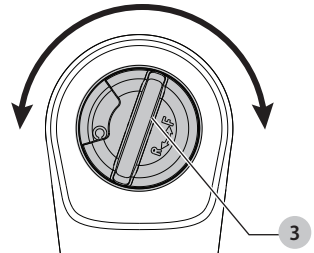

Fig. F
图 F

DCF510



DCF512, DCF513, DCF512E, DCF513E



18V (20V MAX) RATCHET DCF510 , DCF512, DCF513

18V (20V MAX) EXTENDED RATCHET DCF512E, DCF513E



WARNING: Read all safety warnings, instructions, illustrations, and specifications in this manual, including the battery and charger sections provided in an original tool manual or the separate Batteries and Chargers manual. Manuals can be obtained by contacting Customer Service (refer to the back page of this manual).

Technical Data

		DCF510	DCF512	DCF513	DCF512E	DCF513E
Voltage	V _{DC}	18 (20 Max)	18 (20 Max)	18 (20 Max)	18 (20 Max)	18 (20 Max)
No load speed		0–300	0–250	0–250	0–250	0–250
Length	mm	381	360	360	462	462
Weight (without battery pack)	kg	1.20	1.10	1.10	1.30	1.30

WARNING: To reduce the risk of injury, read the instruction manual.

Definitions: Safety Guidelines

The definitions below describe the level of severity for each signal word. Please read the manual and pay attention to these symbols.

▲ DANGER: Indicates an imminently hazardous situation which, if not avoided, **will** result in **death or serious injury**.

▲ WARNING: Indicates a potentially hazardous situation which, if not avoided, **could** result in **death or serious injury**.

▲ CAUTION: Indicates a potentially hazardous situation which, if not avoided, **may** result in **minor or moderate injury**.

NOTICE: Indicates a practice **not related to personal injury** which, if not avoided, **may** result in **property damage**.

▲ Denotes risk of electric shock.

▲ Denotes risk of fire.

GENERAL POWER TOOL SAFETY WARNINGS

▲ WARNING: Read all safety warnings, instructions, illustrations and specifications provided with this power tool. Failure to follow all instructions listed below may result in electric shock, fire and/or serious injury.

SAVE ALL WARNINGS AND INSTRUCTIONS FOR FUTURE REFERENCE

The term “power tool” in the warnings refers to your mains-operated (corded) power tool or battery-operated (cordless) power tool.

1) Work Area Safety

- Keep work area clean and well lit.** Cluttered or dark areas invite accidents.
- Do not operate power tools in explosive atmospheres, such as in the presence of flammable liquids, gases or dust.** Power tools create sparks which may ignite the dust or fumes.
- Keep children and bystanders away while operating a power tool.** Distractions can cause you to lose control.

2) Electrical Safety

- Power tool plugs must match the outlet. Never modify the plug in any way. Do not use any adapter plugs with earthed (grounded) power tools.** Unmodified plugs and matching outlets will reduce risk of electric shock.
- Avoid body contact with earthed or grounded surfaces, such as pipes, radiators, ranges and refrigerators.** There is an increased risk of electric shock if your body is earthed or grounded.

c) **Do not expose power tools to rain or wet conditions.** Water entering a power tool will increase the risk of electric shock.

d) **Do not abuse the cord. Never use the cord for carrying, pulling or unplugging the power tool. Keep cord away from heat, oil, sharp edges or moving parts.** Damaged or entangled cords increase the risk of electric shock.

e) **When operating a power tool outdoors, use an extension cord suitable for outdoor use.** Use of a cord suitable for outdoor use reduces the risk of electric shock.

f) **If operating a power tool in a damp location is unavoidable, use a residual current device (RCD) protected supply.** Use of an RCD reduces the risk of electric shock.

3) Personal Safety

- Stay alert, watch what you are doing and use common sense when operating a power tool. Do not use a power tool while you are tired or under the influence of drugs, alcohol or medication.** A moment of inattention while operating power tools may result in serious personal injury.
- Use personal protective equipment. Always wear eye protection.** Protective equipment such as a dust mask, non-skid safety shoes, hard hat or hearing protection used for appropriate conditions will reduce personal injuries.
- Prevent unintentional starting. Ensure the switch is in the off position before connecting to power source and/or battery pack, picking up or carrying the tool.** Carrying power tools with your finger on the switch or energising power tools that have the switch on invites accidents.
- Remove any adjusting key or wrench before turning the power tool on.** A wrench or a key left attached to a rotating part of the power tool may result in personal injury.
- Do not overreach. Keep proper footing and balance at all times.** This enables better control of the power tool in unexpected situations.
- Dress properly. Do not wear loose clothing or jewellery. Keep your hair and clothing away from moving parts.** Loose clothes, jewellery or long hair can be caught in moving parts.
- If devices are provided for the connection of dust extraction and collection facilities, ensure these are connected and properly used.** Use of dust collection can reduce dust-related hazards.
- Do not let familiarity gained from frequent use of tools allow you to become complacent and ignore tool safety**

principles. A careless action can cause severe injury within a fraction of a second.

4) Power Tool Use and Care

a) **Do not force the power tool. Use the correct power tool for your application.** The correct power tool will do the job better and safer at the rate for which it was designed.

b) **Do not use the power tool if the switch does not turn it on and off.** Any power tool that cannot be controlled with the switch is dangerous and must be repaired.

c) **Disconnect the plug from the power source and/or remove the battery pack, if detachable, from the power tool before making any adjustments, changing accessories, or storing power tools.** Such preventive safety measures reduce the risk of starting the power tool accidentally.

d) **Store idle power tools out of the reach of children and do not allow persons unfamiliar with the power tool or these instructions to operate the power tool.** Power tools are dangerous in the hands of untrained users.

e) **Maintain power tools and accessories. Check for misalignment or binding of moving parts, breakage of parts and any other condition that may affect the power tool's operation. If damaged, have the power tool repaired before use.** Many accidents are caused by poorly maintained power tools.

f) **Keep cutting tools sharp and clean.** Properly maintained cutting tools with sharp cutting edges are less likely to bind and are easier to control.

g) **Use the power tool, accessories and tool bits, etc. in accordance with these instructions, taking into account the working conditions and the work to be performed.** Use of the power tool for operations different from those intended could result in a hazardous situation.

h) **Keep handles and grasping surfaces dry, clean and free from oil and grease.** Slippery handles and grasping surfaces do not allow for safe handling and control of the tool in unexpected situations.

5) Battery Tool Use and Care

a) **Recharge only with the charger specified by the manufacturer.** A charger that is suitable for one type of battery pack may create a risk of fire when used with another battery pack.

b) **Use power tools only with specifically designated battery packs.** Use of any other battery packs may create a risk of injury and fire.

c) **When battery pack is not in use, keep it away from other metal objects, like paper clips, coins, keys, nails, screws or other small metal objects, that can make a connection from one terminal to another.** Shorting the battery terminals together may cause burns or a fire.

d) **Under abusive conditions, liquid may be ejected from the battery; avoid contact. If contact accidentally occurs, flush with water. If liquid contacts eyes, additionally seek medical help.** Liquid ejected from the battery may cause irritation or burns.

e) **Do not use a battery pack or tool that is damaged or modified.** Damaged or modified batteries may exhibit unpredictable behaviour resulting in fire, explosion or risk of injury.

f) **Do not expose a battery pack or tool to fire or excessive temperature.** Exposure to fire or temperature above 130 °C may cause explosion.

g) **Follow all charging instructions and do not charge the battery pack or tool outside the temperature range**

specified in the instructions. Charging improperly or at temperatures outside the specified range may damage the battery and increase the risk of fire.

6) Service

a) **Have your power tool serviced by a qualified repair person using only identical replacement parts.** This will ensure that the safety of the power tool is maintained.

b) **Never service damaged battery packs.** Service of battery packs should only be performed by the manufacturer or authorised service providers.

Safety Instructions for Ratchet Tools

- **Hold the power tool by insulated gripping surfaces, when performing an operation where the fastener may contact hidden wiring.** Fasteners contacting a "live" wire may make exposed metal parts of the tool "live" and could give the operator an electric shock.

- **Use clamps or another practical way to secure and support the workpiece to a stable platform.** Holding the work by your hand or against the body leaves it unstable and may lead to loss of control.

- **Air vents often cover moving parts and should be avoided.** Loose clothing, jewellery or long hair can be caught in moving parts.

- **Do not operate this tool for long periods of time. Vibration caused by tool action may be harmful to your hands and arms.** Use gloves to provide extra cushion and limit exposure by taking frequent rest periods.

- **Accessories and tools get hot during operation.** Wear gloves when touching them.

Residual Risks

In spite of the application of the relevant safety regulations and the implementation of safety devices, certain residual risks cannot be avoided. These are:

- Impairment of hearing.
- Risk of personal injury due to flying particles.
- Risk of burns due to accessories becoming hot during operation.
- Risk of personal injury due to prolonged use.

Battery Type

Refer to the battery/charger manual for more information.

Markings on Tool

The following pictograms are shown on the tool:



Read instruction manual before use.



Wear ear protection.



Visible radiation. Do not stare into light.

Date Code Position (Fig. B)

The production date code **10** consists of a 4-digit year followed by a 2-digit week and is extended by a 2-digit factory code.

Description (Fig. A)

▲ WARNING: Never modify the power tool or any part of it. Damage or personal injury could result.

- 1 Trigger switch
- 2 Square anvil

- 3 Forward/reverse dial
- 4 Battery release button
- 5 Battery pack
- 6 Worklight
- 7 Main handle
- 8 Lock-off button
- 9 Anvil release button

Intended Use

These powered ratchets are designed for light duty fastening applications. These powered ratchets are not torque wrenches. DO NOT use this tool for tightening fasteners to specified torques. An independent calibrated torque measurement device such as a torque wrench should be used when torques are specified.

DO NOT use under wet conditions or in the presence of flammable liquids or gases.

These powered ratchets are professional power tools.

DO NOT let children come into contact with the tool.

Supervision is required when inexperienced operators use this tool.

- **Young children and the infirm.** This appliance is not intended for use by young children or infirm persons without supervision.
- This product is not intended for use by persons (including children) suffering from diminished physical, sensory or mental abilities; lack of experience, knowledge or skills unless they are supervised by a person responsible for their safety. Children should never be left alone with this product.

ASSEMBLY AND ADJUSTMENTS

▲ WARNING: To reduce the risk of serious personal injury, turn tool off and disconnect battery pack before making any adjustments or removing/installing attachments or accessories. An accidental start-up can cause injury.

▲ WARNING: Use only batteries and chargers.

Inserting and Removing the Battery Pack from the Tool (Fig. B)

NOTE: Make sure your battery pack 5 is fully charged.

To Install the Battery Pack into the Tool Handle

1. Align the battery pack with the rails inside the tool's handle (Fig. B).
2. Slide it into the handle until the battery pack is firmly seated in the tool and ensure that you hear the lock snap into place.

To Remove the Battery Pack from the Tool

1. Press the battery release button 4 and firmly pull the battery pack out of the tool handle.
2. Insert battery pack into the charger.

Fuel Gauge Battery Packs (Fig. B)

Some DEWALT battery packs include a fuel gauge 11, which consists of three green LED lights that indicate the level of charge remaining in the battery pack.

To actuate the fuel gauge, press and hold the fuel gauge button. A combination of the three green LED lights will illuminate, designating the level of charge left. When the level of charge in the battery is below the usable limit, the fuel gauge will not illuminate and the battery will need to be recharged.

NOTE: The fuel gauge is only an indication of the charge left on the battery pack. It does not indicate tool functionality and is subject to variation based on product components, temperature and end-user application.

Anvil (Fig. D)

▲ CAUTION: Inspect anvil prior to use. Missing or damaged items should be replaced before use.

To install an accessory on the anvil, align the accessory with the anvil 2. Press the accessory onto the anvil 2.

To remove an accessory, pull the accessory off the anvil 2.

Removing and Installing Anvil (Fig. E)

DCF510 Only

DCF510: Choose the appropriate sized anvil 2 3/8" or 1/2".

To Remove

1. With one hand push in the release button 9 and with the other hand pull out on the anvil 2 to remove it from the tool.

To Install

1. To install an anvil, push the desired anvil into the tool until you hear an audible click. Tug on the anvil 2 to ensure it is secured in place.

OPERATION

Instructions for Use

▲ WARNING: Always observe the safety instructions and applicable regulations.

▲ WARNING: To reduce the risk of serious personal injury, turn tool off and disconnect battery pack before making any adjustments or removing/installing attachments or accessories. An accidental start-up can cause injury.

Proper Hand Position (Fig. C)

▲ WARNING: To reduce the risk of serious personal injury, ALWAYS use proper hand position as shown.

▲ WARNING: To reduce the risk of serious personal injury, ALWAYS hold securely in anticipation of a sudden reaction.

▲ WARNING: Ratchet may stall (if overloaded or improperly used), causing a twist. Always expect the stall. Grip the ratchet firmly to control the twisting action and prevent loss of control which could cause personal injury.

Proper hand position requires one hand on the main handle 7 as shown to control the twisting action of the ratchet.

Variable Speed Trigger (Fig. A)

The tool is turned on and off by pulling and releasing the variable speed trigger 1. The farther the trigger is depressed, the higher the speed of the tool. The anvil will stop as soon as the trigger switch is fully released.

Forward/Reverse Dial (Fig. F)

A forward/reverse control dial 3 determines the rotational direction of the tool.

1. To select forward rotation (clockwise), release the trigger and rotate the forward/reverse dial 3 on the head of the tool in a counterclockwise direction.
2. To select reverse rotation (anticlockwise), release the trigger and rotate the forward/reverse dial 3 on the head of the tool in a clockwise direction.

NOTE: The first time the tool is run after changing the direction of rotation, you may hear a click on start up. This is normal and does not indicate a problem.

Lock-off Button (Fig. A)

To lock the tool, slide the lock-off button **8** to the locked position. When the lock-off button is in the locked position, the tool is locked and the trigger switch **1** cannot be pulled.

Worklight (Fig. A)

There is a worklight **6** located on the foot of the tool. The worklight is activated when the trigger switch is depressed. When the trigger is released, the worklight will stay illuminated for up to 20 seconds.

NOTE: The worklight is for lighting the immediate work surface and is not intended to be used as a flashlight.

Usage (Fig. A, D)

▲ WARNING: To reduce the risk of serious personal injury, turn unit off and remove the battery pack before making any adjustments or removing/installing attachments or accessories. An accidental start-up can cause injury.

▲ WARNING: The ratchet may stall if overloaded causing a sudden twist. Always expect the tool to twist. Grip the ratchet firmly to control the twisting action and avoid possible personal injury.

▲ CAUTION: Ensure fastener and/or system will withstand the level of torque generated by the tool. Excessive torque may cause breakage and possible personal injury.

Maximum Tool Applied Torque

Cat #	RPM	Ft.-Lbs.	Nm
DCF510	0–300	0–75	0–101
DCF512	0–250	0–70	0–95
DCF512E	0–250	0–70	0–95
DCF513	0–250	0–70	0–95
DCF513E	0–250	0–70	0–95

Maximum Manually Applied Torque

Cat #	Ft.-Lbs.	Nm
DCF510	175	237
DCF512	175	237
DCF512E	175	237
DCF513	175	237
DCF513E	175	237

1. Install appropriate accessory onto the anvil **2**.
2. Place the accessory on the fastener head. Keep the tool pointed straight at the fastener.
3. Consider the intended operation and select either forward or reverse rotation.
4. Press variable speed trigger switch **1** to start operation.
5. Release variable speed trigger switch **1** to stop operation.
6. If the ratchet stalls, the tool is overloaded or is being improperly used. Release the variable speed trigger switch **1** immediately. Do not press the variable speed trigger switch **1** on and off in an attempt to start a stalled ratchet. Doing so can damage the tool.
7. The ratchet can also be used manually for starting stubborn fasteners or snugging by releasing the trigger and applying the torque by hand.

NOTE: Excessive manually applied torque may damage the tool housing or mechanism.

MAINTENANCE

Your power tool has been designed to operate over a long period of time with a minimum of maintenance. Continuous satisfactory operation depends upon proper tool care and regular cleaning.

▲ WARNING: To reduce the risk of serious personal injury, turn tool off and disconnect battery pack before making any adjustments or removing/installing attachments or accessories. An accidental start-up can cause injury.

The charger and battery pack are not serviceable.

Please refer to the back page of this manual for service centre contact information, or visit www.2helpU.com.

Lubrication

Your power tool requires no additional lubrication.

Cleaning

▲ WARNING: Electrical shock and mechanical hazard.

Disconnect the plug from the power source and/or remove the battery pack, if detachable, from the product before cleaning.

▲ WARNING: To ensure safe and efficient operation, always keep the product and the ventilation slots (if applicable) clean. Ventilation slots can be cleaned using a dry, soft non-metallic brush and/or a suitable vacuum cleaner. Do not use water or any cleaning solutions.

▲ WARNING: Blow dirt and dust out of the main housing with dry air as often as dirt is seen collecting in and around the ventilation slots. Wear approved eye protection and approved dust mask when performing this procedure.

▲ WARNING: Never use solvents or other harsh chemicals for cleaning the non-metallic parts of the product. These chemicals may weaken the materials used in these parts. Use a cloth dampened only with water and mild soap. Never let any liquid get inside the product. Never immerse any part of the product into a liquid.

Optional Accessories

▲ WARNING: Since accessories, other than those offered by DEWALT, have not been tested with this product, use of such accessories with this tool could be hazardous. To reduce the risk of injury, only DEWALT-recommended accessories should be used with this product.

Consult your dealer for further information on the appropriate accessories.

Protecting the Environment



Products/batteries are recyclable, but if marked with the crossed-out bin, they must not be disposed of with normal household waste.

Run the batteries down completely and separate them, and separate any light sources from the product if possible. It is the user's responsibility to delete personal data from the product. Then take the waste to an official waste collection centre or a participating retailer who will often accept it free of charge. Packaging should be discarded based on the marked material code. Operating and safety instructions should only be discarded once the applicable product is no longer in use. Please check with your local community/municipality for waste management guidance. For further information, visit www.2helpU.com.

After Service and Repair

DEWALT service centers are staffed with trained personnel to provide customers with efficient and reliable product service. We do not take any responsibility when you have repaired in unauthorized service center. You can refer to the leaflet of CONTACT CENTER LOCATOR in product package and contact us through hotline, website or social media to find the nearest DEWALT service center around you.

18V (20V MAX) 棘轮扳手 DCF510, DCF512, DCF513

18V (20V MAX) 长颈棘轮扳手 DCF512E, DCF513E

 **警告:** 在使用本工具前, 请阅读本电动工具随附手册中的所有安全警告、指示、图标和规格, 包括原厂手册中的电池和充电器部分, 或独立的《电池与充电器手册》中的内容。您可联系客服中心, 获得产品手册 (请参阅本手册的背面)。



技术数据

		DCF510	DCF512	DCF513	DCF512E	DCF513E
电压	V _{bc}	18 (20 Max)	18 (20 Max)	18 (20 Max)	18 (20 Max)	18 (20 Max)
空载转速		0–300	0–250	0–250	0–250	0–250
长度	mm	381	360	360	462	462
重量 (不含电池包)	kg	1.20	1.10	1.10	1.30	1.30



警告: 为降低伤害风险, 请阅读使用手册。

定义: 安全准则

下列定义解释了各警示词的严重程度。请仔细阅读本手册并注意这些标志。

▲ 危险: 表示紧急的危险情况, 如不加以避免, 将导致死亡或严重伤害。

▲ 警告: 指示潜在的危险情况, 如不加以避免, 可能导致死亡或严重伤害。

▲ 小心: 表示潜在的危险情况, 如不加以避免, 可能导致轻度或中度伤害。

注意: 表示不涉及人身伤害的情况, 如不加以避免, 可能导致财产损失。

▲ 指示有触电风险。

▲ 指示有火灾风险。

电动工具通用安全警告

▲ 警告! 阅读随电动工具提供的所有安全警告、说明、图示和规定。不遵照以下所列说明会导致电击、着火和/或严重伤害。

保存所有警告和说明书以备查阅。

警告中的术语“电动工具”指市电驱动 (有线) 电动工具或电池驱动 (无线) 电动工具。

1) 工作场地的安全

- 保持工作场地清洁和明亮。杂乱和黑暗的场地会引发事故。
- 不要在易爆环境, 如有易燃液体、气体或粉尘的环境下操作电动工具。电动工具产生的火花会点燃粉尘或气体。
- 操作电动工具时, 远离儿童和旁观者。注意力不集中会使你失去对工具的控制。

2) 电气安全

- 电动工具插头必须与插座相配。绝不能以任何方式改装插头。需接地的电动工具不能使用任何转换插头。未经改装的插头和相配的插座将降低电击风险。

- 避免人体接触接地表面, 如管道、散热片和冰箱。如果你身体接触接地表面会增加电击风险。

- 不得将电动工具暴露在雨中或潮湿环境中。水进入电动工具将增加电击风险。

- 不得滥用软线。绝不能用软线搬运、拉动电动工具或拔出其插头。使软线远离热源、油、锐边或运动部件。受损或缠绕的软线会增加电击风险。

- 当在户外使用电动工具时, 使用适合户外使用的延长线。适合户外使用的电线将降低电击风险。

- 如果无法避免在潮湿环境中操作电动工具, 应使用带有剩余电流装置 (RCD) 保护的电源。RCD的使用可降低电击风险。

3) 人身安全

- 保持警觉, 当操作电动工具时关注所从事的操作并保持清醒。当你感到疲倦, 或在有药物、酒精或治疗反应时, 不要操作电动工具。在操作电动工具时瞬间的疏忽会导致严重人身伤害。

- 使用个人防护装置。始终佩戴护目镜。防护装置, 诸如适当条件下使用防尘面具、防滑安全鞋、安全帽、听力防护等装置能减少人身伤害。

- 防止意外启动。在连接电源和/或电池包、拿起或搬运工具前确保开关处于关断位置。手指放在开关上搬运工具或开关处于接通时通电会导致危险。

- 在电动工具接通之前, 拿掉所有调节钥匙或扳手。遗留在电动工具旋转零件上的扳手或钥匙会导致人身伤害。

- 手不要过分伸展。时刻注意立足点和身体平衡。这样能在意外情况下能更好地控制住电动工具。

- 着装适当。不要穿宽松衣服或佩戴饰品。让你的头发和衣服远离运动部件。宽松衣服、配饰或长发可能会卷入运动部件。

- 如果提供了与排屑、集尘设备连接用的装置, 要确保其连接完好且使用得当。使用集尘装置可降低尘屑引起的危险。

- 不要因为频繁使用工具而产生的熟悉感而掉以轻心, 忽视工具的安全准则。某个粗心的动作可能在瞬间导致严重的伤害。

4) 电动工具使用和注意事项

- 不要勉强使用电动工具, 根据用途使用合适的电动工具。选用合适的按照额定值设计的电动工具会使你工作更有效、更安全。

- 如果开关不能接通或关断电源, 则不能使用该电动工具。不能通过开关来控制的电动工具是危险的且必须进行修理。

- c) 在进行任何调节、更换配件或贮存电动工具之前,必须从电源上拔掉插头和/或卸下电池包(如可拆卸)。这种防护性的安全措施降低了电动工具意外起动的风险。
- d) 将闲置不用的电动工具贮存在儿童所及范围之外,并且不允许不熟悉电动工具和不了解这些说明的人操作电动工具。电动工具在未经培训的使用者手中是危险的。
- e) 维护电动工具及其配件。检查运动部件是否调整到位或卡住,检查零件破损情况和影响电动工具运行的其他状况。如有损坏,应在使用前修理好电动工具。许多事故是由维护不良的电动工具引发的。
- f) 保持切削刀具锋利和清洁。维护良好地有锋利切削刃的刀具不易卡住而且容易控制。
- g) 按照使用说明书,并考虑作业条件和要进行的作业来选择电动工具、配件和工具的刀头等。将电动工具用于那些与其用途不符的操作可能会导致危险情况。
- h) 保持手柄和握持表面干燥、清洁,不得沾有油脂。在意外的情况下,湿滑的手柄不能保证握持的安全和对工具的控制。

5) 电池工具的使用和注意事项

- a) 仅使用生产者规定的充电器充电。将适用于某种电池包的充电器用到其他电池包时可能会发生着火危险。
- b) 仅使用配有专用电池包的电动工具。使用其他电池包可能会产生伤害和着火危险。
- c) 当电池包不用时,将它远离其他金属物体,例如回形针、硬币、钥匙、钉子、螺钉或其他小金属物体,以防电池包一端与另一端连接。电池组端部短路可能会引起燃烧或着火。
- d) 在滥用条件下,液体可能会从电池组中溅出,应避免接触。如果意外碰到液体,用水冲洗。如果液体碰到了眼睛,还应寻求医疗帮助。从电池中溅出的液体可能会发生腐蚀或燃烧。
- e) 不要使用损坏或改装过的电池包或工具。损坏或改装过的电池组可能呈现无法预测的结果,导致着火、爆炸或伤害。
- f) 不要将电池包暴露于火或高温中。电池包暴露于火或高于130°C的高温中可能导致爆炸。

6) 维修

- a) 让专业维修人员使用相同的备件维修电动工具。这将保证所维修的电动工具的安全。
- b) 决不能维修损坏的电池包。电池包仅能由生产者或其授权的维修服务商进行维修。

对棘轮扳手工具的安全说明

- 在紧固件可能触及暗线进行操作时,要通过绝缘握持面来握持工具。紧固件碰到带电导线会使工具外露的金属零件带电从而使操作者受到电击。
- 使用夹子或其他方法将工件固定和支撑在一个稳定的平台上。用手扶住工件,或用身体抵住工件,都会让工件处于不稳定的状态,从而导致失控。
- 通风口通常会遮盖转动部件,应注意避免。宽松衣服、佩饰或长发可能会卷入运动部件。
- 请勿长时间操作该工具。工具所产生的振动会损伤您的双手和双臂。请佩戴手套为您提供额外缓冲,同时请定期休息,以限制自己对振动的暴露程度。
- 配件和工具在运转过程中会发热。如需触碰,请佩戴手套。

剩余风险

即使执行了相关安全规定并采用安全设备,仍有一些无法避免的其他风险。这些风险包括:

- 听力损伤。
- 飞溅颗粒造成的人身伤害风险。
- 配件在使用时发热而导致的灼伤风险。
- 长时间使用工具引起的人身伤害风险。

电池类型

请参见电池/充电器手册,了解更多信息。

工具上的标记

工具上印有下列图形:



使用前请阅读使用手册。



请戴好耳罩。



可见辐射光源。请勿直视发光部位。

日期码的位置(图B)

产品日期码 **10** 包含一个4位数年码,之后是一个2位数周码,再加上一个2位数出厂码。

说明(图A)

▲ 警告:不得改装本电动工具或其任何部件。否则,可能造成人身伤害或工具损坏。

- 1 变速开关
- 2 铁砧
- 3 正反切换转轮
- 4 电池释放按钮
- 5 电池包
- 6 工作灯
- 7 主手柄
- 8 锁定按钮
- 9 铁砧释放按钮

设计用途

这些电动棘轮扳手扳手适用于轻型紧固应用。这些电动棘轮扳手并非扭矩扳手。请勿用该工具将紧固件拧到特定扭矩。如果规定了具体的扭矩值,请使用经过校准的独立扭矩测量设备,例如扭矩扳手。

请勿在潮湿环境中,或在易燃液体或气体的环境中使用本工具。

这些电动棘轮扳手为专业电动工具。

请勿让儿童接触本工具。缺乏经验的操作员需要在监督下使用本工具。

- 儿童和体弱者。在没有他人监督的情况下,儿童或体弱者不适宜使用本产品。
- 本产品不适合体力、感官或智力不足以及缺乏经验、知识或技能的人员(包括儿童)使用,除非一旁有能为他们的安全负责的监督人员。不得在无人监管的情况下让儿童接触本产品。

组装和调整

▲ 警告:为降低造成严重人身伤害的风险,在进行任何调整、拆卸/安装配件或配件前,切记关闭工具并断开电池包。意外启动可能会造成伤害。

▲ 警告:仅使用电池和充电器。

在工具上安装和拆除电池包(图B)

注意:确保电池包**5**充满电。

将电池包安装到工具手柄中

1. 将电池包与工具手柄内的轨道对齐(图B)。
2. 将电池包划入手柄中,直到电池包被牢固地安装在工具中,同时确保听见锁定到位的咔哒声。

从工具中取出电池包

1. 按电池下释放按钮**4**,将电池包从工具握柄中慢慢拉出。
2. 将电池包插入充电器。

电池包电量计(图B)

一些DeWALT电池包带有一个包含三个绿色LED指示灯的电量计**11**,用于指示电池包内的剩余电量。

按下电量计按钮不松开,即可启动电量计。三个绿色LED指示灯将以组合方式亮起,以指示剩余电量。当电池内的电量低于可用限制时,电量计将不会亮起,电池将需要重新充电。

注意:电量计仅指示电池包的剩余电量。它并不表示该工具的功能,且将根据产品组件、温度和最终用户的使用情况而有所不同。

铁砧(图D)

▲ 小心:使用前检查铁砧。使用前应更换缺失或受损的物件。

如需在铁砧上安装配件,请将配件与铁砧**2**对齐。用力将配件推到铁砧**2**上。

如需拆除配件,请将配件从铁砧上**2**拉下。

拆除和安装铁砧(图E)

仅DCF510

DCF510:选择合适尺寸的铁砧**2** 3/8" 或 1/2"。

拆除

1. 一手按压铁砧释放按钮**9**,一手拉出铁砧**2**,将其从工具中取下。

安装

1. 安装铁砧时,将所需铁砧推入工具,直到听到“咔嚓”声为止。拉动铁砧**2**,确保它已经安装牢固。

操作

使用说明

▲ 警告:请始终遵守安全法规以及适用规章的要求。

▲ 警告:为降低造成严重人身伤害的风险,在进行任何调整、拆卸/安装配件或配件前,切记关闭工具并断开电池组。意外启动可能会造成伤害。

正确的双手放置位置(图C)

▲ 警告:为降低严重人身伤害的风险,请务必如图示那样正确放置双手。

▲ 警告:为降低造成严重人身伤害的风险,预期有突然反作用力时**务必**握紧工具。

▲ 警告:棘轮扳手可能会堵转(如果过载或使用不当),这会产生反作用力。始终要有出现堵转的预期。用力握住棘轮扳手,控制工具的反作用力,预防工具失控以及可能造成的人身伤害。正确的双手放置位置要求您一手握住主手柄**7**,如图所示,以控制棘轮扳手的反作用力。

变速开关(图A)

可按压和松开变速开关**1**来启动和关闭工具。越是用力按压变速开关,工具的运转速度越高。当您完全松开变速开关,卡盘就会停止运转。

正反切换转轮(图F)

正反切换转轮**3**能确定工具转向。

1. 如需选择正向转动(顺时针),请松开变速开关,逆时针转动工具头部的正反切换转轮**3**。
2. 如需选择反向转动(逆时针),请松开变速开关,顺时针转动工具头部的正反切换转轮**3**。

注意:改变工具转向后,在首次运行工具时,可能会在启动时听见咔哒声。这是正常情况,并非出现问题。

锁定按钮(图A)

如需锁定工具,请将锁定按钮**8**滑动到锁定位置。当锁定按钮处于锁定位置,工具就会被锁住,无法按下变速开关**1**。

工作灯(图A)

工具底部前面有工作灯**6**。当按下变速开关,工作灯就会亮起。松开变速开关,工作灯持续亮起20秒后熄灭。

注意:工作灯能够照亮近距离的工作台面,但不可将其用作电源。

使用(图A, D)

▲ 警告:为降低严重的人身伤害风险,在进行任何调整或取出/安装配件或配件之前,请关闭工具并断开。意外启动可能会造成伤害。

▲ 警告:如果工具超载,棘轮扳手可能会出现堵转,导致工具突然出现反作用力。始终做好准备,应对反作用力。用力握住棘轮扳手,控制工具的反作用力,避免可能造成的人身伤害。

▲ 小心:确保紧固件和/或系统能够抵御工具产生的扭矩水平。扭矩过大可能会导致破裂,还可能造成人身伤害。

最大工具施加扭矩

型号	RPM	Ft.-Lbs.	Nm
DCF510	0-300	0-75	0-101
DCF512	0-250	0-70	0-95
DCF512E	0-250	0-70	0-95
DCF513	0-250	0-70	0-95
DCF513E	0-250	0-70	0-95

最大手动施加扭矩

型号	Ft.-Lbs.	Nm
DCF510	175	237
DCF512	175	237
DCF512E	175	237
DCF513	175	237
DCF513E	175	237

1. 将适当的配件安装到铁砧 ② 上。
2. 将配件放在紧固件头部，让工具对准紧固件。
3. 请根据目的用途，选择正向转动或反向转动。
4. 按压变速开关 ①，启动工具。
5. 松开变速开关 ①，停止工具。
6. 如果棘轮扳手出现堵转，工具就会超载或使用不当。立即松开变速开关 ①。请勿反复按压变速开关 ①，试图启动已经堵转的棘轮扳手。这样做会损坏工具。
7. 也可以手动操作棘轮扳手，启动被卡住的紧固件，或松开变速开关并手动施加扭矩，使其调整到位。

注意：如果手动施加的扭矩过大，就会损坏工具外壳或机构。

维护

您的电动工具只需简单保养，即可长期使用。若要持续获得满意的操作效果，需进行正确的工具维护和定期的清洁。

▲ 警告：为降低造成严重人身伤害的风险，在进行任何调整、拆卸/安装配件或配件前，切记关闭工具并断开电池包。意外启动可能会造成伤害。

充电器和电池包无法维修。

请参见本手册背面内容，获取维修中心的联系信息，或访问

www.2helpU.com。

润滑

本电动工具无需另行润滑。

清洁

▲ 警告：触电和机械危害。在进行清洁工具前，必须断开电源插头和/或取下电池包（如可拆卸）。

▲ 警告：为确保操作安全、高效，请务必保持本产品及通风槽（如有）的清洁。请使用干燥、柔软的非金属刷和/或恰当的吸尘器清洁器来清洁通风槽。请勿使用水或任何清洁剂。

▲ 警告：请经常用干燥的空气吹扫机箱中的污垢和粉尘，因为粉尘会积聚在通风口内和周围。在进行该操作时，请佩戴经过批准的护眼装置和防尘面罩。

▲ 警告：不得使用溶剂或其他刺激性化学品来清洁工具的非金属部件。这些化学品会侵蚀这些部件所用的材料。仅使用蘸有温和肥皂水的湿布进行擦拭。不得让液体侵入工具内部。不得将产品的任何部位浸入液体中。

可选配件

▲ 警告：除了DeWALT提供的配件之外，其他配件都未接受过此产品兼容性测试。若将此类配件与本工具一起使用，将存在安全隐患。为降低人身伤害风险，本产品只可使用DeWALT推荐的配件。

请咨询您的经销商，了解更多关于合适配件的信息。

保护环境



产品/电池可回收利用，但若标有打叉垃圾桶的图标，则禁止将其随普通生活垃圾一起丢弃。

请将电池电量耗尽后拆卸下来，同时尽可能将任何可拆卸的光源部件与产品主体分离。用户需自行清除产品内的个人数据。随后，请将废弃物送往指定回收点或合作零售点，通常可免费处理。包装材料应根据材质代码分类弃置。只可在产品报废后，才可丢弃操作指南和安全说明书。

废弃物处理细则请查阅当地社区/城市管理规定。如需获得更多信息，请访问www.2helpU.com。

售后服务和维修

DeWALT维修中心拥有经过培训的人员，能够为顾客提供充分、可靠的产品服务。如果您通过未获授权的维修中心进行维修，我们不会承担任何责任。您可以参见产品包装中的“联系中心定位器”宣传单页，通过热线电话、网站或社交媒体联系我们，找到距离您最近的DeWALT服务中心。

制造商：百得德国公司

地址：Black & Decker Str. 40 65510 Idstein, 德国

产地：江苏苏州